

# CERTIFICATE OF LOCATION OF GOVERNMENT CORNER

County of Anoka

State of Minnesota

## West 1/4 Corner of Sec. 24 Township 31 Range 23

On the 13th day of November, 1964, the described corner was evidenced by area resurvey

and to perpetuate the location of said corner, at the exact location thereof, a permanent marker was placed consisting of a cast iron monument

AND on the 24th day of May, 2023, said permanent marker was set cast iron  
monument after road construction, verified using RTK GPS methods. Updated ties

Updated reference ties are as shown below.

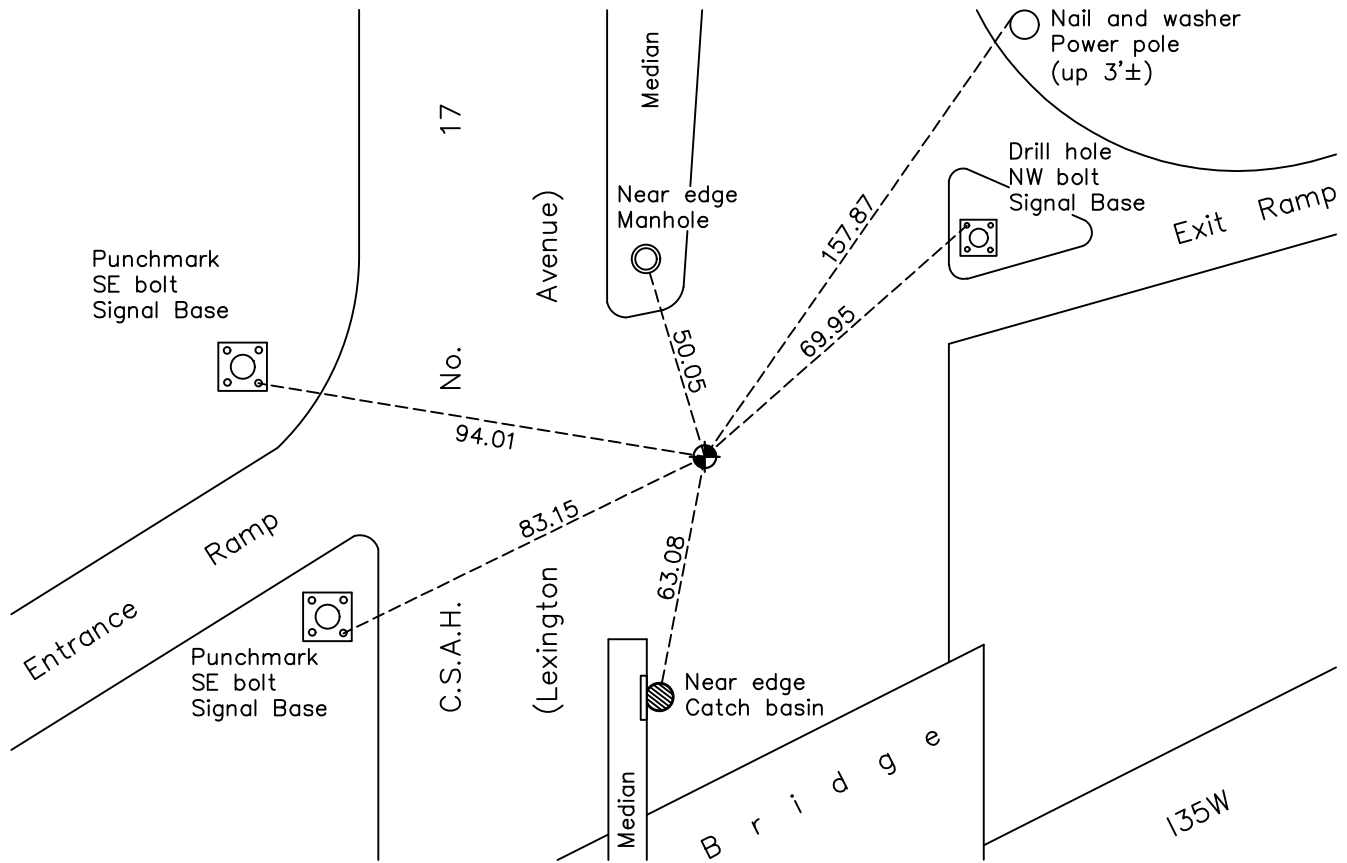

Revision Date  
5/31/2023

N.A.D. 1983 Coordinates  
 (1996 Adjustment)

County Project Coordinates	
Northing	<u>145615.3480</u>
Easting	<u>526677.7228</u>
Date	<u>10/15/98</u>

I hereby certify that this United States public land survey monument record is correct and complete to the best of my knowledge and belief.  
*David Zieglmeier* Date 6/28/23  
 David Zieglmeier Anoka County Surveyor  
 Minnesota License Number 46179

# HISTORY OF GOVERNMENT CORNER

Page No. 72

County of Anoka

State of Minnesota

West 1/4 Corner of Sec. 24 Township 31 Range 23

## **CORNER HISTORY:**

November 13, 1964 - Set cast iron monument flush using area resurvey and established ties to monument.

March 17, 1966 - Found cast iron monument and set construction ties prior to Interstate 35W construction.

October 21, 1968 - Reset cast iron monument using construction ties and geodimeter distances from the North and South after Interstate 35W construction. Updated ties.

October 5, 1971 - Found cast iron monument and updated ties.

August 22, 1977 - Found cast iron monument and updated ties.

May 22, 1975 - Found cast iron monument and updated ties.

June 8, 1981 - Found cast iron monument and updated ties.

June 26, 1995 - Found cast iron monument and updated ties.

Unknown date - Found cast iron monument and set construction ties prior to road construction.

June 2, 1998 - Set cast iron monument after road construction and updated ties.

October 15, 1998 - Found cast iron monument, established NAD 1983 (1996 adj.) Anoka County project coordinates by static GPS methods and updated ties.

May 21, 2014 - Found cast iron monument and updated ties.

July 25, 2019 - Found cast iron monument and updated ties.

May 24, 2023 - set cast iron monument after road construction, verified position using RTK GPS methods. Updated ties. Job no. 22-131