

# CERTIFICATE OF LOCATION OF GOVERNMENT CORNER

County of Anoka

State of Minnesota

## East 1/4 Corner of Sec. 29 Township 31 Range 23

On the 21st day of July, 1948, the described corner was evidenced by a concrete monument

and to perpetuate the location of said corner, at the exact location thereof, a permanent marker was placed consisting of a cast iron monument

AND on the 11th day of May, 2022, said permanent marker was found flush and the ties were updated

Updated reference ties are as shown below.

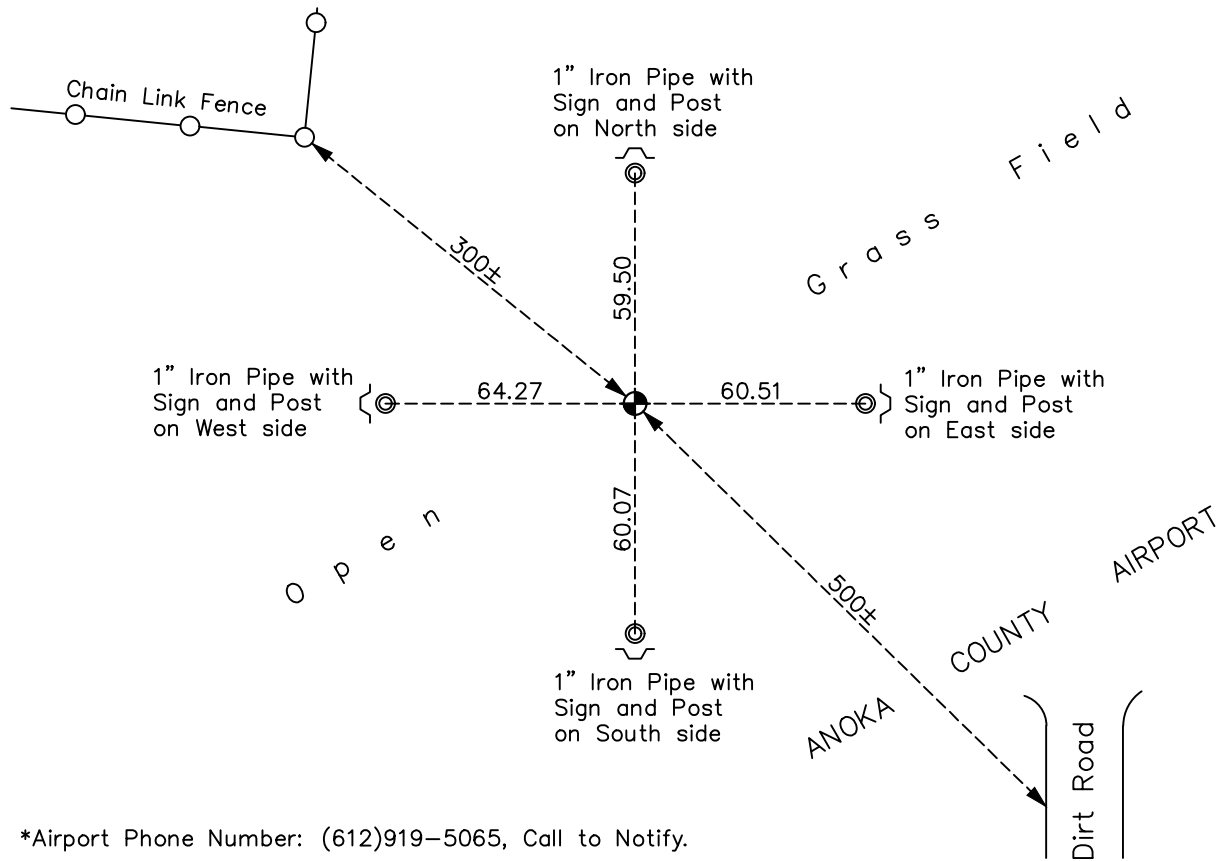

Revision Date  
10/04/2022

N.A.D. 1983 Coordinates  
(1996 Adjustment)

County Project Coordinates	
Northing	<u>140456.7176</u>
Easting	<u>510707.7997</u>
Date	<u>8/26/99</u>

I hereby certify that this United States public land survey monument record is correct and complete to the best of my knowledge and belief.

*David Zieglmeier* Date 2/28/23

David Zieglmeier Anoka County Surveyor  
Minnesota License Number 46179

# HISTORY OF GOVERNMENT CORNER

Page No. 90

County of Anoka

State of Minnesota

## East 1/4 Corner of Sec. 29 Township 31 Range 23

### **CORNER HISTORY:**

July 21, 1948 - Harvey Cartwright found a fence corner which checks with 1/8 section lines etc. Set concrete monument and established ties to monument.

June 15, 1964 - Found concrete monument down 0.2'± with a 1/2" iron pipe on the North side. Updated ties.

August 13, 1968 - Found concrete monument down 0.5'± with a 1/2" iron pipe on the North side. Updated ties.

September 23, 1971 - Found concrete monument and updated ties.

May 30, 1975 - Found concrete monument and replaced with a cast iron monument down 0.5'±. Updated ties.

August 19, 1977 - Found cast iron monument and updated ties.

June 18, 1980 - Found cast iron monument and updated ties.

November 6, 1985 - Found cast iron monument down 0.5'± and old fence ties gone. Updated ties.

June 4, 1986 - Found cast iron monument and updated ties.

July 31, 1990 - Found cast iron monument and updated ties.

June 22, 1995 - Found cast iron monument and updated ties.

August 26, 1999 - Found cast iron monument, established NAD 1983 (1996 adj.) Anoka County project coordinates by static GPS methods and updated ties.

July 21, 2014 - Found cast iron monument, verified position by VRS GPS methods and updated ties.

June 25, 2019 - Found cast iron monument, verified position by VRS GPS methods and updated ties.

May 11, 2022 - Found cast iron monument, verified position by VRS GPS methods and updated ties.