

CERTIFICATE OF LOCATION OF GOVERNMENT CORNER

County of Anoka

State of Minnesota

West 1/4 Corner of Sec. 26 Township 31 Range 23

On the 6th day of November, 1961, the described corner was evidenced by a concrete monument

and to perpetuate the location of said corner, at the exact location thereof, a permanent marker was placed consisting of a cast iron monument

AND on the 5th day of May, 2022, said permanent marker was found flush and the ties were updated. CIM is in 10th parking stall from west end of row and 1'± north of center stripe.

Updated reference ties are as shown below.

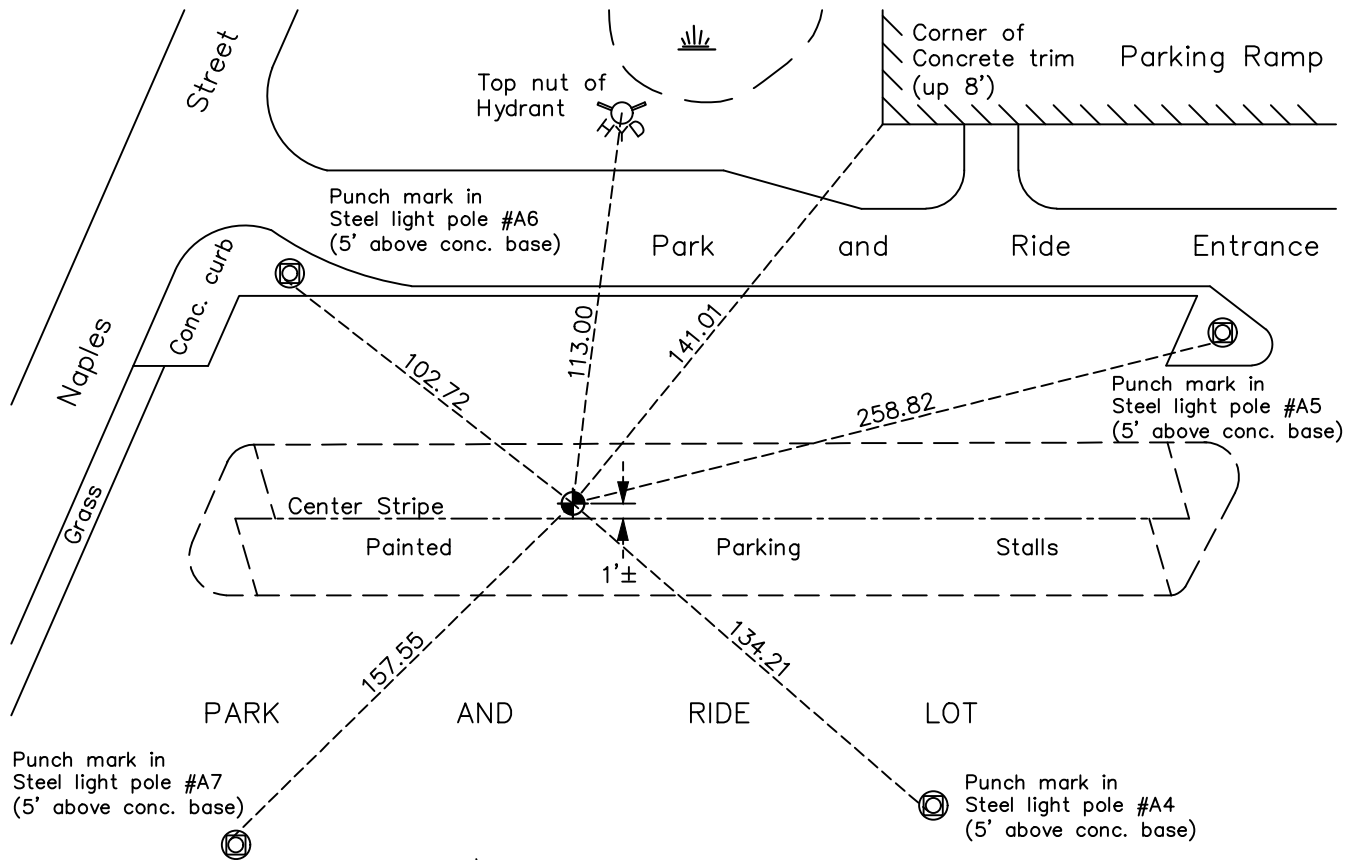

Revision Date
 10/04/2022

N.A.D. 1983 Coordinates
 (1996 Adjustment)

| County Project Coordinates | |
|----------------------------|-------------|
| Northing | 140413.8312 |
| Easting | 521298.2554 |
| Date | 10/27/98 |

I hereby certify that this United States public land survey monument record is correct and complete to the best of my knowledge and belief.
David Zieglmeier Date 2/28/23
 David Zieglmeier Anoka County Surveyor
 Minnesota License Number 46179

HISTORY OF GOVERNMENT CORNER

Page No. 92

County of Anoka

State of Minnesota

West 1/4 Corner of Sec. 26 Township 31 Range 23

CORNER HISTORY:

December 5, 1945 - Harvey Cartwright found an old iron monument down 1' and replaced with a concrete monument. Established ties to concrete monument.

Unknown date - Found 3/4" iron pin and updated ties by M.H.D.

November 6, 1961 - Found 3/4" iron pipe down 0.5' using Cartwright and M.H.D. ties. Updated ties.

July 24, 1968 - Set cast iron monument down 0.4'± and updated ties.

September 28, 1971 - Found cast iron monument and updated ties.

May 19, 1975 - Found cast iron monument and updated ties.

September 22, 1976 - Reset cast iron monument flush after road construction. Updated ties.

June 9, 1980 - Found cast iron monument and updated ties.

July 3, 1990 - Found cast iron monument and updated ties.

June 26, 1995 - Found cast iron monument and updated ties.

October 27, 1998 - Found cast iron monument, established NAD 1983 (1996 adj.) Anoka County project coordinates by static GPS methods and updated ties.

January 21, 2003 - Found cast iron monument and updated ties.

July 3, 2014 - Found cast iron monument and updated ties.

June 21, 2019 - Found cast iron monument, verified position by VRS GPS methods and updated ties.

May 5, 2022 - Found cast iron monument, verified position by VRS GPS methods and updated ties.