

CERTIFICATE OF LOCATION OF GOVERNMENT CORNER

County of Anoka

State of Minnesota

East 1/4 Corner of Sec. 25 Township 31 Range 23

On the 20th day of January, 1978, the described corner was evidenced by area resurvey

and to perpetuate the location of said corner, at the exact location thereof, a permanent marker was placed consisting of a red and white 2" square steel Telspar monument up 5'± with a sign attached facing south

AND on the 29th day of April, 2022, said permanent marker was found and the ties were updated

Updated reference ties are as shown below.

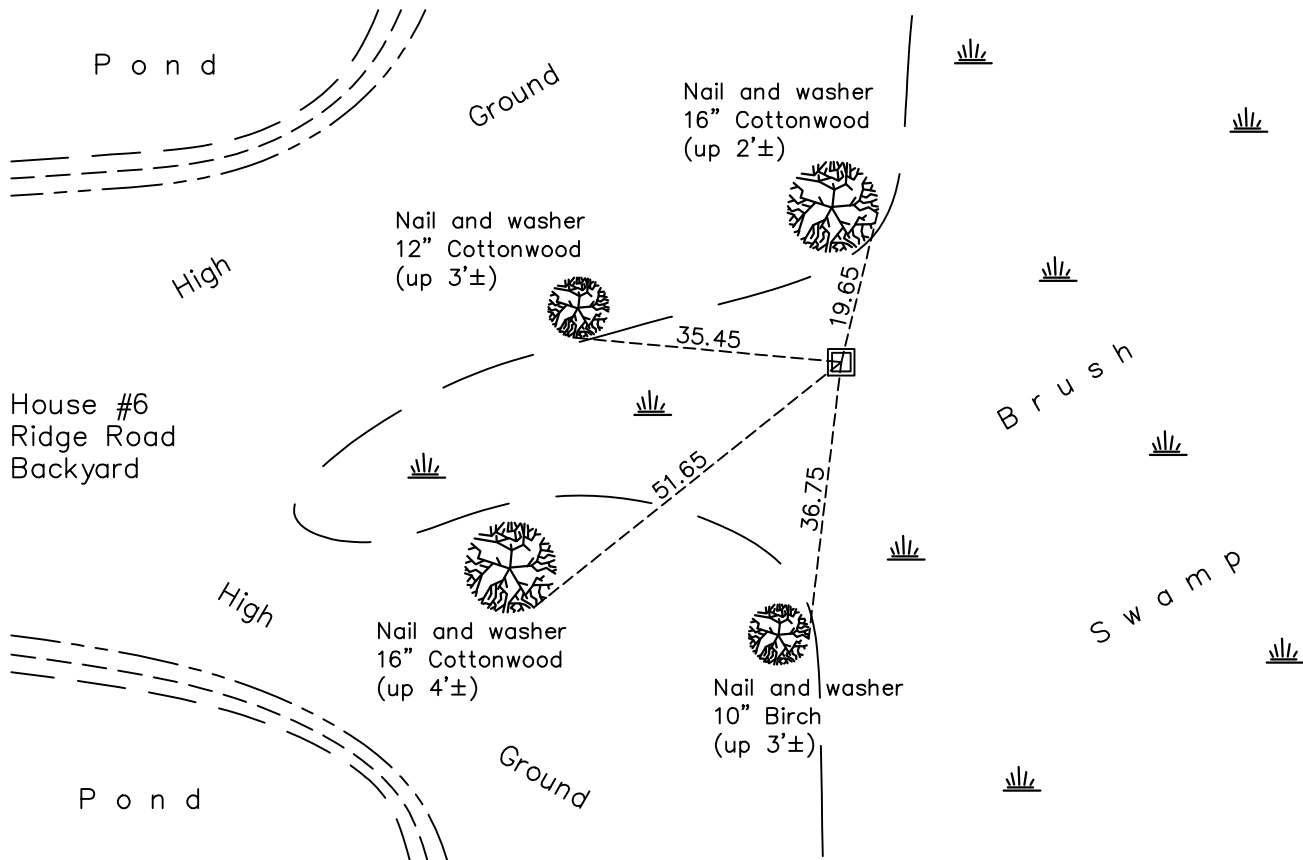

Revision Date
10/04/2022

N.A.D. 1983 Coordinates
 (1996 Adjustment)

County Project Coordinates	
Northing	<u>140280.1955</u>
Easting	<u>531898.1441</u>
Date	<u>6/25/98</u>

I hereby certify that this United States public land survey monument record is correct and complete to the best of my knowledge and belief.
David Zieglmeier Date 2/28/23
 David Zieglmeier Anoka County Surveyor
 Minnesota License Number 46179

HISTORY OF GOVERNMENT CORNER

Page No. 93A

County of Anoka

State of Minnesota

East 1/4 Corner of Sec. 25 Township 31 Range 23

CORNER HISTORY:

January 20, 1978 - Set red and white iron pipe using area resurvey and established ties to iron pipe.

November 14, 1991 - Found red and white iron pipe and updated ties.

March 21, 1996 - Found old red and white iron pipe and replaced with a new red and white iron pipe using ties. Updated ties.

July 28, 1996 - Found red and white iron pipe and updated ties.

June 25, 1998 - Found red and white iron pipe, established NAD 1983 (1996 adj.) Anoka County project coordinates by static GPS methods and updated ties.

2006 - Found monument to be a square steel Telspar and area too wet to update the ties.

July 29, 2014 - Found red and white 2" square steel Telspar up 5'± with a sign attached and updated ties.

June 20, 2019 - Found red and white 2" square steel Telspar up 5'± with a sign attached and updated ties.

April 29, 2022 - Found red and white 2" square steel Telspar up 5'± with a sign attached and updated ties.