

CERTIFICATE OF LOCATION OF GOVERNMENT CORNER

County of Anoka

State of Minnesota

Northeast Corner of Sec. 36 Township 31 Range 23

On the 7th day of May, 1963, the described corner was evidenced by a 4" square concrete monument

and to perpetuate the location of said corner, at the exact location thereof, a permanent marker was placed consisting of 2'x8' Telspar monument with punchmarked cap

AND on the 11th day of January, 2022, said permanent marker was found 2"x8' Telspar monument w/cap & punchmark up 0.3'± Ties were updated. Sign & post found on north side.

Updated reference ties are as shown below.

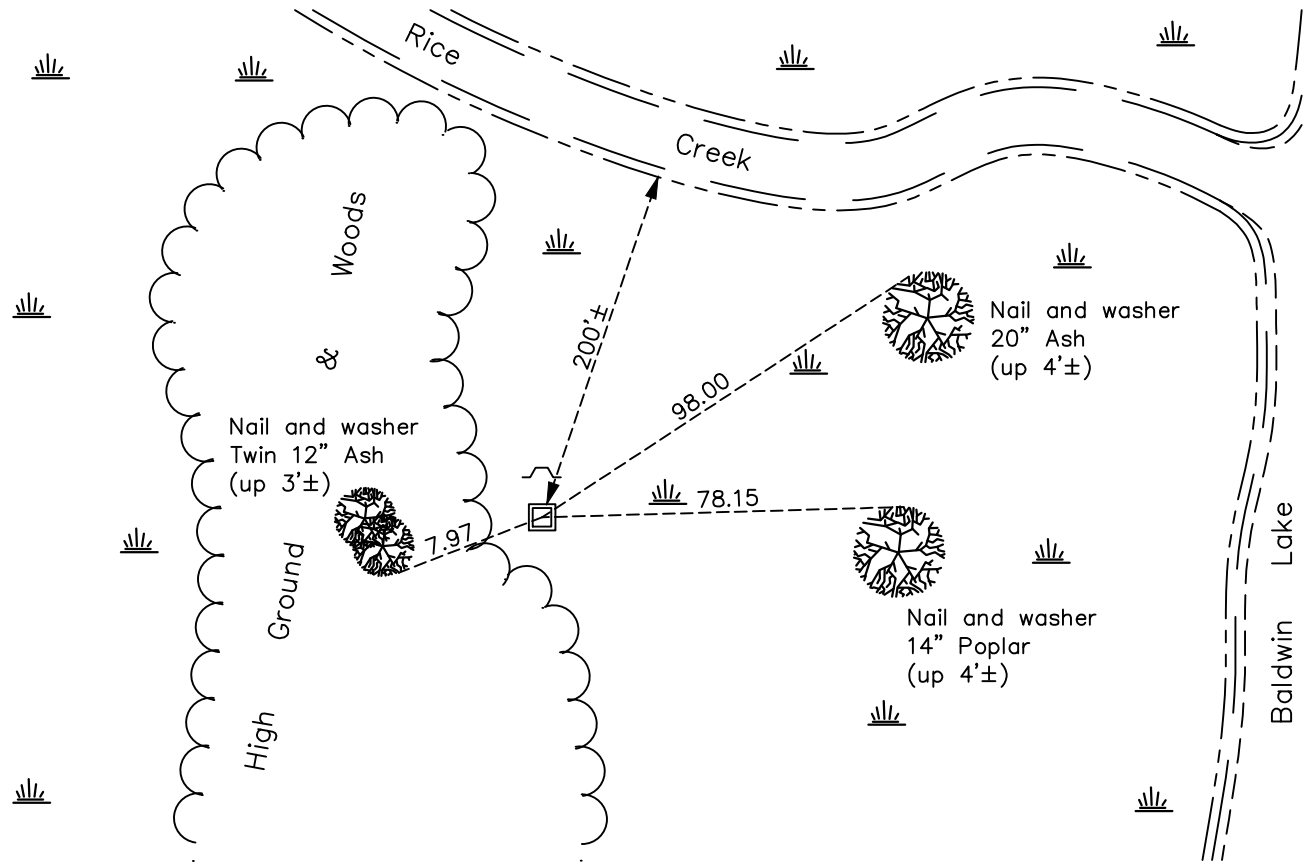

N

W ANOKA COUNTY SURVEYOR E

S

Revision Date

03/18/22

N.A.D. 1983 Coordinates
(1996 Adjustment)

County Project Coordinates	
Northing	<u>137637.7725</u>
Easting	<u>531875.2941</u>
Date	<u>2/09/00</u>

I hereby certify that this United States public land survey monument record is correct and complete to the best of my knowledge and belief.

David Zieglmeier Date 2/28/23

David Zieglmeier Anoka County Surveyor
Minnesota License Number 46179

HISTORY OF GOVERNMENT CORNER

Page No. 94

County of Anoka

State of Minnesota

Northeast Corner of Sec. 36 Township 31 Range 23

CORNER HISTORY:

December 28, 1944 - Cartwright found concrete monument down 0.3' and established ties to monument.

May 7, 1963 - Found 4" x 4" concrete monument down 0.3'. Set a 2.5' iron pipe up 1' on the North side. Updated ties.

September 14, 1964 - Found 4" x 4" concrete monument and updated ties.

August 14, 1968 - Found 4" x 4" concrete monument and updated ties.

January 6, 1978 - Found concrete monument and updated ties.

August 3, 1995 - Found concrete monument and updated ties.

February 9, 2000 - Found concrete monument, established NAD 1983 (1996 adj.) Anoka County project coordinates by static GPS methods and updated ties.

July 24, 2014 - Found concrete monument partially broken and in need of reset. Checked position against corner ties.

September 12, 2014 - Found broken concrete monument and replaced with a 2" x 8' square steel Telspar monument with punchmarked cap using static GPS methods. Set sign and post on North side and updated ties.

January 11, 2022 - Found 2" x 8' square steel Telspar monument with punchmarked cap, verified position by VRS GPS method. Updated ties.