

CERTIFICATE OF LOCATION OF GOVERNMENT CORNER

County of Anoka

State of Minnesota

East 1/4 Corner of Sec. 31 Township 31 Range 23

On the 21st day of June, 1960, the described corner was evidenced by a concrete monument

and to perpetuate the location of said corner, at the exact location thereof, a permanent marker was placed consisting of a cast iron monument

AND on the 6th day of May, 2022, said permanent marker was found down 0.1'± and the ties were updated

Updated reference ties are as shown below.

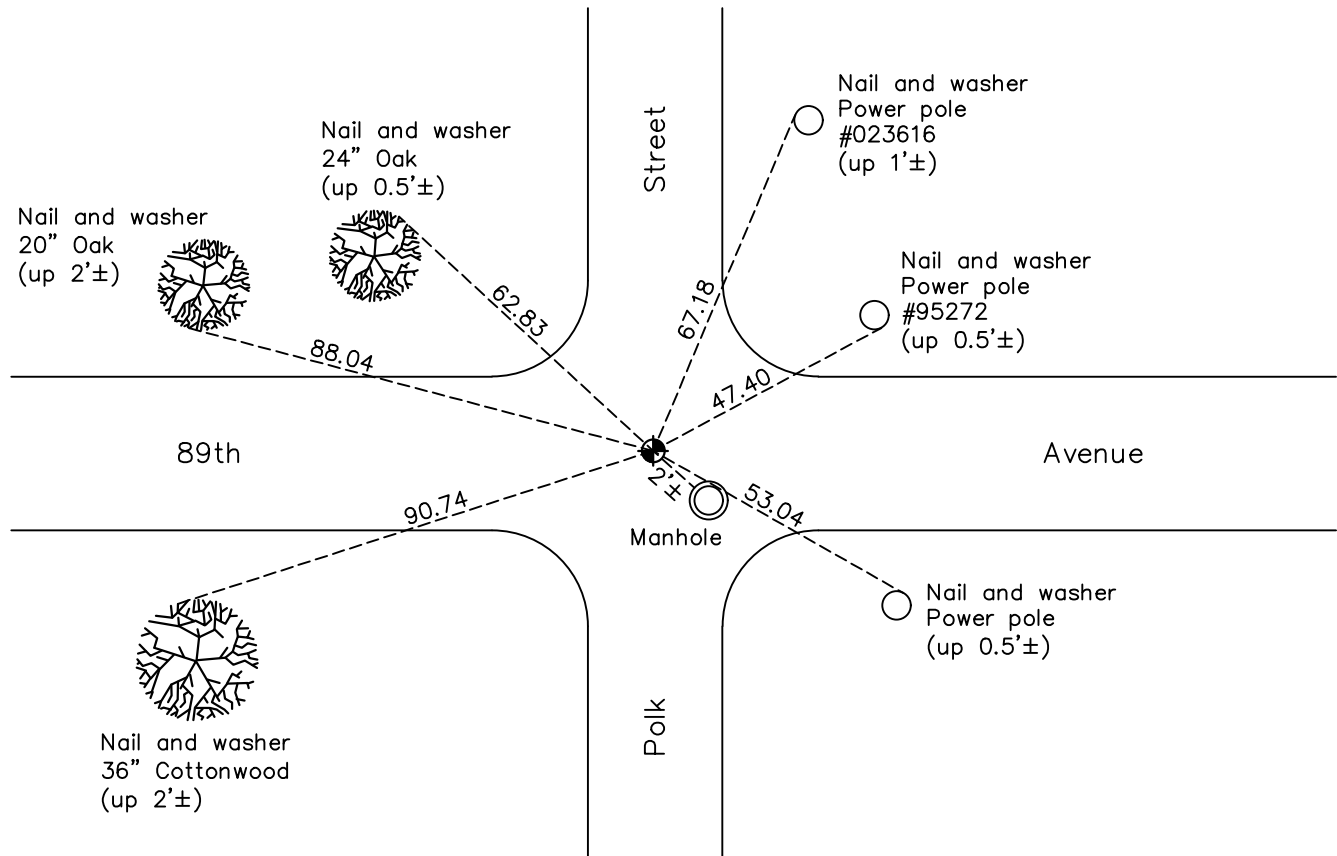

Revision Date
10/19/2022

N.A.D. 1983 Coordinates
 (1996 Adjustment)

| County Project Coordinates | |
|----------------------------|--------------------|
| Northing | <u>135204.9207</u> |
| Easting | <u>505411.3751</u> |
| Date | <u>12/10/98</u> |

I hereby certify that this United States public land survey monument record is correct and complete to the best of my knowledge and belief.

David Zieglmeier Date 2/28/23

David Zieglmeier Anoka County Surveyor
 Minnesota License Number 46179

HISTORY OF GOVERNMENT CORNER

Page No. 110

County of Anoka

State of Minnesota

East 1/4 Corner of Sec. 31 Township 31 Range 23

CORNER HISTORY:

July 1957 - Milner W. Carley found a spike and updated ties.

1958 - Found bent 1" iron pipe down 6" and updated ties by Minnesota highway department.

June 21, 1960 - Found concrete monument down 0.7' with a bent iron pipe to the west. Updated ties.

June 12, 1964 - Found concrete monument and updated ties

September 19, 1966 - Found concrete monument and updated ties.

August 28, 1967 - Found concrete monument and replaced with a cast iron monument.

July 29, 1968 - Found cast iron monument and updated ties.

August 8, 1969 - Found cast iron monument and updated ties. Removed monument.

September 23, 1971 - Found cast iron monument and updated ties.

May 21, 1975 - Found cast iron monument and updated ties.

August 16, 1977 - Found cast iron monument and updated ties.

June 13, 1980 - Found cast iron monument and updated ties.

May 30, 1986 - Found cast iron monument and updated ties.

May 7, 1990 - Found cast iron monument and updated ties.

June 20, 1990 - Found cast iron monument and updated ties.

June 8, 1995 - Found cast iron monument and updated ties.

December 10, 1998 - Found cast iron monument, established NAD 1983 (1996 adj.) Anoka County project coordinates by static GPS methods and updated ties.

November 5, 2001 - Found cast iron monument and updated ties.

August 2, 2006 - Found cast iron monument and updated ties.

June 18, 2014 - Found cast iron monument, verified position by VRS GPS methods and updated ties.

June 24, 2019 - Found cast iron monument, verified position by VRS GPS methods and updated ties.

May 6, 2022 - Found cast iron monument down 0.1'±, verified position by VRS GPS method and updated ties.