

# CERTIFICATE OF LOCATION OF GOVERNMENT CORNER

County of Anoka

State of Minnesota

## North 1/4 Corner of Sec. 3 Township 32 Range 22

On the 23rd day of March, 1979, the described corner was evidenced by area resurvey

and to perpetuate the location of said corner, at the exact location thereof, a permanent marker was placed consisting of a cast iron monument with a sign and post on the north side

AND on the 21st day of June, 2022, said permanent marker was found flush and the ties were updated.

Updated reference ties are as shown below.

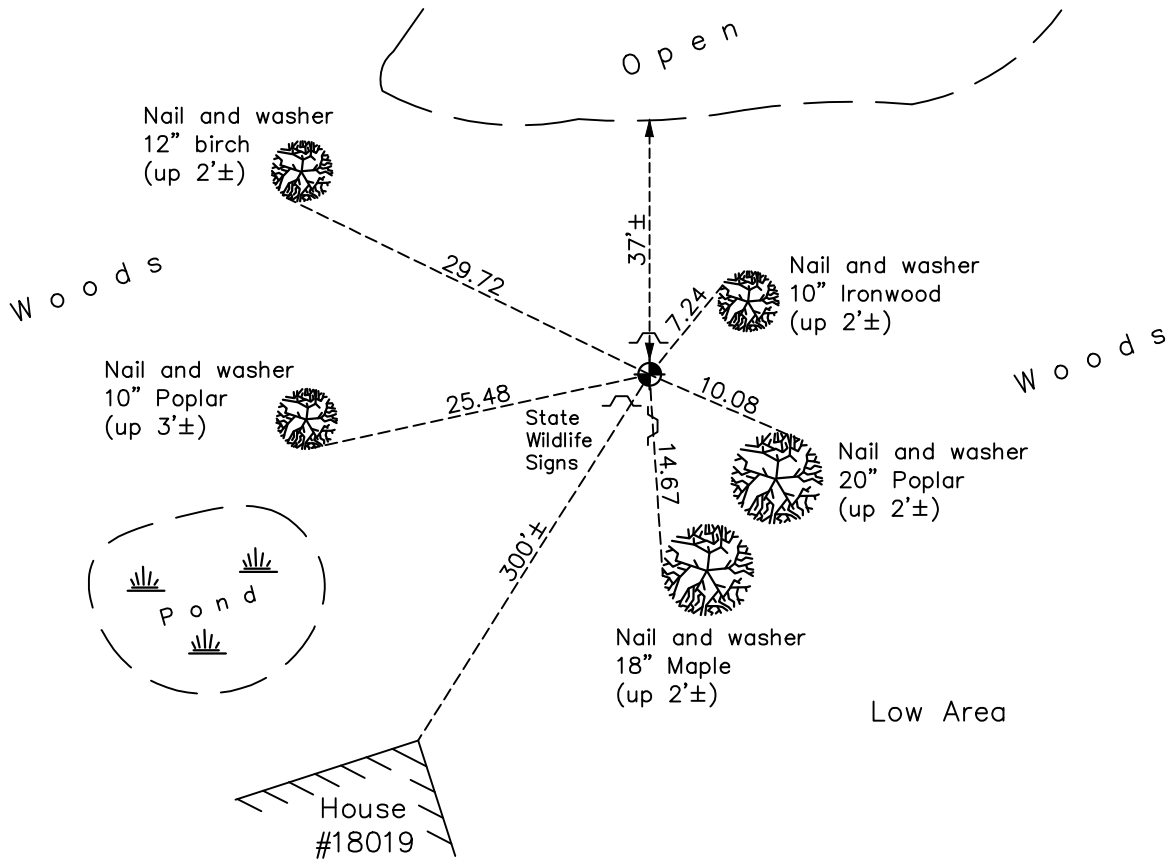

Revision Date  
7/18/2022

N.A.D. 1983 Coordinates  
 (1996 Adjustment)

| County Project Coordinates |                    |
|----------------------------|--------------------|
| Northing                   | <u>195499.5904</u> |
| Easting                    | <u>550470.7912</u> |
| Date                       | <u>4/28/05</u>     |

I hereby certify that this United States public land survey monument record is correct and complete to the best of my knowledge and belief.  
*David Zieglmeier* Date 12/7/23  
 David Zieglmeier Anoka County Surveyor  
 Minnesota License Number 46179

# HISTORY OF GOVERNMENT CORNER

County of Anoka

State of Minnesota

North 1/4 Corner of Sec. 3 Township 32 Range 22

## **CORNER HISTORY:**

March 23, 1979 - Set cast iron monument flush using area resurvey. Established ties to monument. Set sign and post on the North side.

August 13, 1985 - Found cast iron monument and updated ties.

February 3, 1988 - Found cast iron monument and updated ties.

June 14, 1990 - Found cast iron monument and updated ties.

August 14, 1995 - Found cast iron monument and updated ties.

April 28, 2005 - Established NAD 1983 (1996 adj.) Anoka County project coordinates by static GPS methods.

November 7, 2007 - Found cast iron monument and updated ties.

September 30, 2014 - Found cast iron monument and updated ties.

August 1, 2019 - Found cast iron monument flush and updated ties.

June 21, 2022 - Found cast iron monument flush and updated ties.