

CERTIFICATE OF LOCATION OF GOVERNMENT CORNER

County of Anoka

State of Minnesota

North 1/4 Corner of Sec. 10 Township 32 Range 22

On the 5th day of April, 1978, the described corner was evidenced by area resurvey

and to perpetuate the location of said corner, at the exact location thereof, a permanent marker was placed consisting of a cast iron monument with a sign and post on the east side

AND on the 23rd day of June, 2022, said permanent marker was found flush and the ties were updated.

Updated reference ties are as shown below.

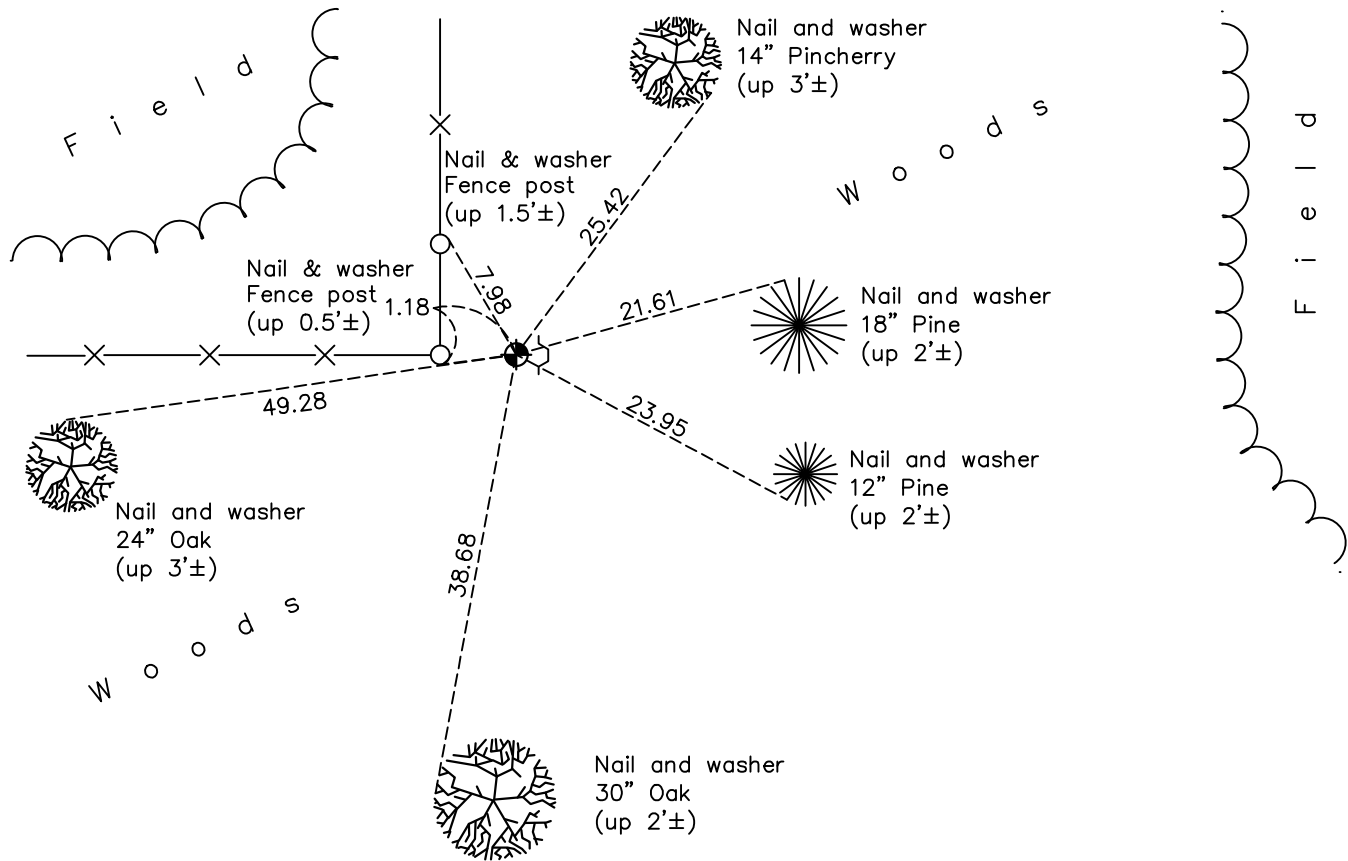

Revision Date

8/12/2022

N.A.D. 1983 Coordinates
(1996 Adjustment)

County Project Coordinates	
Northing	190436.8792
Easting	550523.2762
Date	4/28/05

I hereby certify that this United States public land survey monument record is correct and complete to the best of my knowledge and belief.

David Zieglmeier Date 12/8/23

David Zieglmeier Anoka County Surveyor
Minnesota License Number 46179

HISTORY OF GOVERNMENT CORNER

Page No. 33

County of Anoka

State of Minnesota

North 1/4 Corner of Sec. 10 Township 32 Range 22

CORNER HISTORY:

April 5, 1978 - Set cast iron monument flush using area resurvey. Established ties to monument.

July 27, 1982 - Found cast iron monument and updated ties.

August 13, 1985 - Found cast iron monument and updated ties.

June 12, 1990 - Found cast iron monument and updated ties. Set sign and post on East side.

August 15, 1995 - Found cast iron monument and updated ties.

April 28, 2005 - Established NAD 1983 (1996 adj.) Anoka County project coordinates by static GPS methods.

October 13, 2014 - Found cast iron monument and updated ties.

September 24, 2019 - Found cast iron monument flush and updated ties.

June 23, 2022 - Found cast iron monument flush, verified position by GPS VRS method and updated ties.