

# CERTIFICATE OF LOCATION OF GOVERNMENT CORNER

County of Anoka

State of Minnesota

## South 1/4 Corner of Sec. 7 Township 32 Range 22

On the 20th day of February, 1980, the described corner was evidenced by area resurvey

and to perpetuate the location of said corner, at the exact location thereof, a permanent marker was placed consisting of a cast iron monument with a sign and post on the northwest side

AND on the 22nd day of June, 2022, said permanent marker was found flush and the ties were updated

Updated reference ties are as shown below.

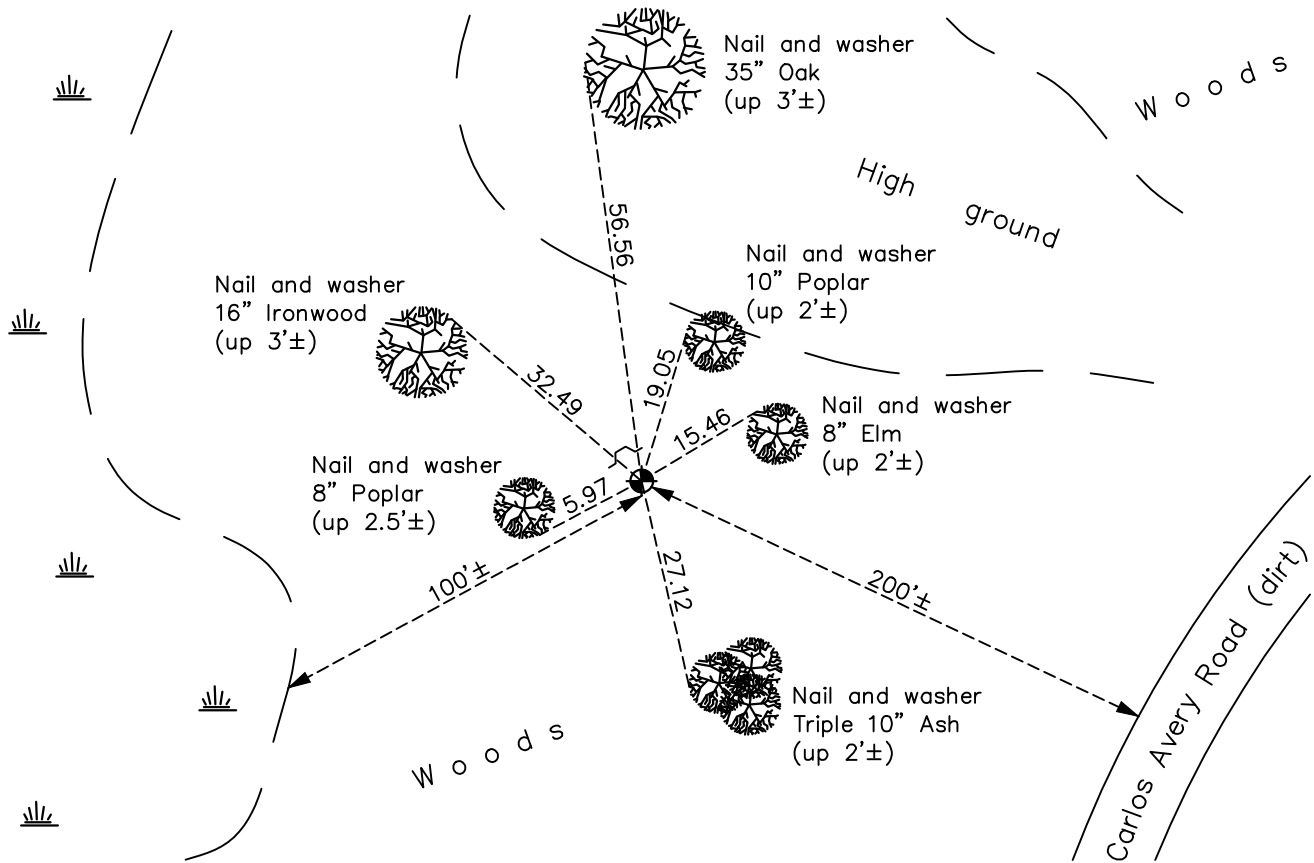

Revision Date  
10/21/2022

N.A.D. 1983 Coordinates  
 (1996 Adjustment)

County Project Coordinates	
Northing	<u>185166.3962</u>
Easting	<u>534747.6555</u>
Date	<u>2/02/06</u>

I hereby certify that this United States public land survey monument record is correct and complete to the best of my knowledge and belief.

David Zieglmeier Date 12/8/23

David Zieglmeier Anoka County Surveyor  
 Minnesota License Number 46179

# HISTORY OF GOVERNMENT CORNER

Page No. 57

County of Anoka

State of Minnesota

South 1/4 Corner of Sec. 7 Township 32 Range 22

## **CORNER HISTORY:**

February 20, 1980 - Set cast iron monument flush using area resurvey. Set sign and post on the North side. Established ties to monument.

July 5, 1990 - Found cast iron monument and updated ties.

August 17, 1995 - Found cast iron monument and updated ties.

February 2, 2006 - Established NAD 1983 (1996 adj.) Anoka County project coordinates by static GPS methods.

December 19, 2007 - Found cast iron monument and updated ties.

September 25, 2014 - Found cast iron monument and updated ties.

November 18, 2019 - Found cast iron monument. Verified position by VRS GPS methods. Updated ties.

June 22, 2022 - Found cast iron monument flush, verified position by VRS GPS method and updated ties.