

CERTIFICATE OF LOCATION OF GOVERNMENT CORNER

County of Anoka

State of Minnesota

South 1/4 Corner of Sec. 21 Township 32 Range 22

On the ____ day of July, 1967, the described corner was evidenced by an iron pipe

and to perpetuate the location of said corner, at the exact location thereof, a permanent marker was placed consisting of a cast iron monument with a sign and post on the north side

AND on the 18th day of November, 2019, said permanent marker was found up 0.2'± and the ties were updated

Updated reference ties are as shown below.

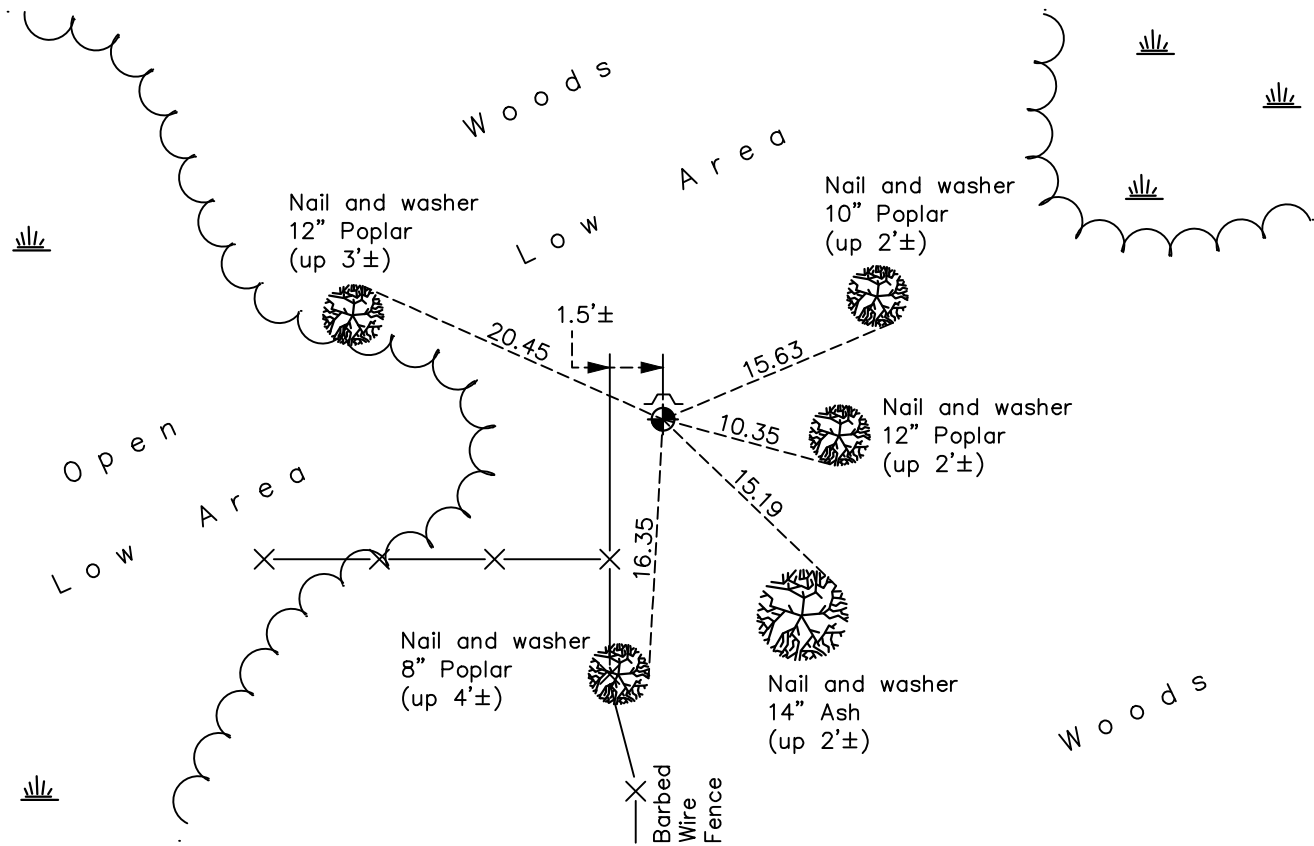

Revision Date
 5/27/20

N.A.D. 1983 Coordinates
 (1996 Adjustment)

County Project Coordinates	
Northing	174664.2036
Easting	545300.2203
Date	3/20/03

I hereby certify that this United States public land survey monument record is correct and complete to the best of my knowledge and belief.
David Zieglmeier Date 5/12/22
 David Zieglmeier Anoka County Surveyor
 Minnesota License Number 46179

HISTORY OF GOVERNMENT CORNER

Page No. 92

County of Anoka

State of Minnesota

South 1/4 Corner of Sec. 21 Township 32 Range 22

CORNER HISTORY:

July 1967 - James L. Kurth found a 3/4" open end iron pipe and updated the ties.

July 15, 1970 - Found 3/4" iron pipe flush and replaced with a cast iron monument up 0.1'±. Updated ties.

June 12, 1973 - Found cast iron monument and updated ties.

August 11, 1976 - Found cast iron monument and updated ties.

August 6, 1979 - Found cast iron monument and updated ties.

June 26, 1990 - Found cast iron monument and updated ties.

November 6, 1990 - Found cast iron monument and updated ties.

March 2, 1993 - Found cast iron monument and updated ties.

August 23, 1995 - Found cast iron monument and updated ties.

March 20, 2003 - Established NAD 1983 (1996 adj.) Anoka County project coordinates by static GPS methods.

October 15, 2014 - Found cast iron monument up 0.2'± and updated ties.

November 18, 2019 - Found cast iron monument up 0.2'±. Verified position by VRS GPS methods. Updated ties.