

CERTIFICATE OF LOCATION OF GOVERNMENT CORNER

County of Anoka

State of Minnesota

West 1/4 Corner of Sec. 25 Township 32 Range 22

On the 6th day of January, 1975, the described corner was evidenced by area resurvey

and to perpetuate the location of said corner, at the exact location thereof, a permanent marker was placed consisting of a red and white 2" square steel Telespar monument with a
"County Surveyor" cap and a sign attached facing north

AND on the 27th day of June, 2023, said permanent marker was Removed found rusted off
& laying down Telspar. Reset position to published coordinates with 2"x 6" capped Telspar w/ Punch

Updated reference ties are as shown below.

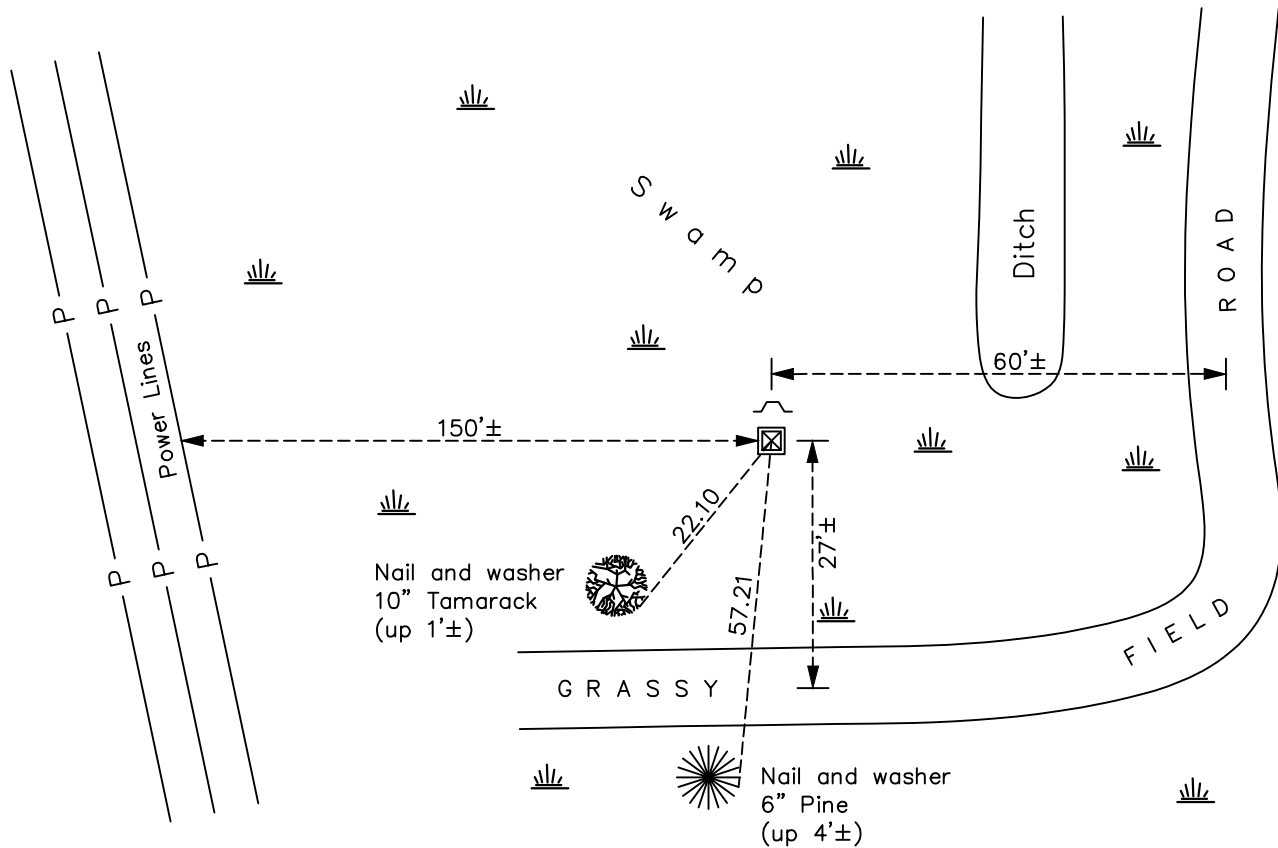

Revision Date
7/26/2023

N.A.D. 1983 Coordinates
 (1996 Adjustment)

County Project Coordinates	
Northing	<u>172041.8771</u>
Easting	<u>558416.6972</u>
Date	<u>1/23/06</u>

I hereby certify that this United States public land survey monument record is correct and complete to the best of my knowledge and belief.
David Zieglmeier Date 12/7/23
 David Zieglmeier Anoka County Surveyor
 Minnesota License Number 46179

HISTORY OF GOVERNMENT CORNER

Page No. 101

County of Anoka

State of Minnesota

West 1/4 Corner of Sec. 25 Township 32 Range 22

CORNER HISTORY:

January 6, 1975 - Set red and white iron pipe up 3'± using area resurvey. Established ties to pipe.

February 16, 1978 - Found red and white iron pipe and updated ties.

January 25, 1992 - Found red and white iron pipe and updated ties.

January 25, 1993 - Replaced red and white iron pipe with a red and white iron pipe w/sign attached. Updated ties.

August 21, 1995 - Found red and white iron pipe and updated ties.

January 23, 2006 - Found red and white 2" x 2" steel Telspar monument w/cap. Updated ties. Established NAD 1983 (1996 adj.) Anoka County project coordinates by static GPS methods.

March 5, 2015 - Found red and white 2" x 2" steel Telspar monument w/cap. Verified position by VRS GPS methods. Updated ties.

June 27, 2023 - Found 2" square Telspar rusted off and laying down was removed. Reset position w/ new 2" x 6' Telspar with punched cap left up 0.5'± using ACS RTK GPS to published coordinates. Updated available ties.