

CERTIFICATE OF LOCATION OF GOVERNMENT CORNER

County of Anoka

State of Minnesota

Northeast Corner of Sec. 33 Township 32 Range 22

On the XX day of XX, 1847, the described corner was evidenced by set a wood post

and to perpetuate the location of said corner, at the exact location thereof, a permanent marker was placed consisting of XXXXX

AND on the XX day of XX, XXXX, said permanent marker was XXXXX

XXXXX

Updated reference ties are as shown below.

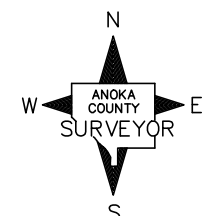

Revision Date

XX/XX/XXXX

N.A.D. 1983 Coordinates
(2011 Adjustment)

County Project Coordinates
Northing <u>169391.2783</u>
Easting <u>547942.0719</u>
Date <u>COMPUTED</u>

I hereby certify that this United States public land survey monument record is correct and complete to the best of my knowledge and belief.

_____ Date _____

David M. Zieglmeier, Anoka County Surveyor

Minnesota License Number 46179