

W. $\frac{1}{16}$ th of the NE $\frac{1}{4}$ Corner Sec. 5 T32 R22
 Retied Concrete Monument w. Sign Post
 North Side

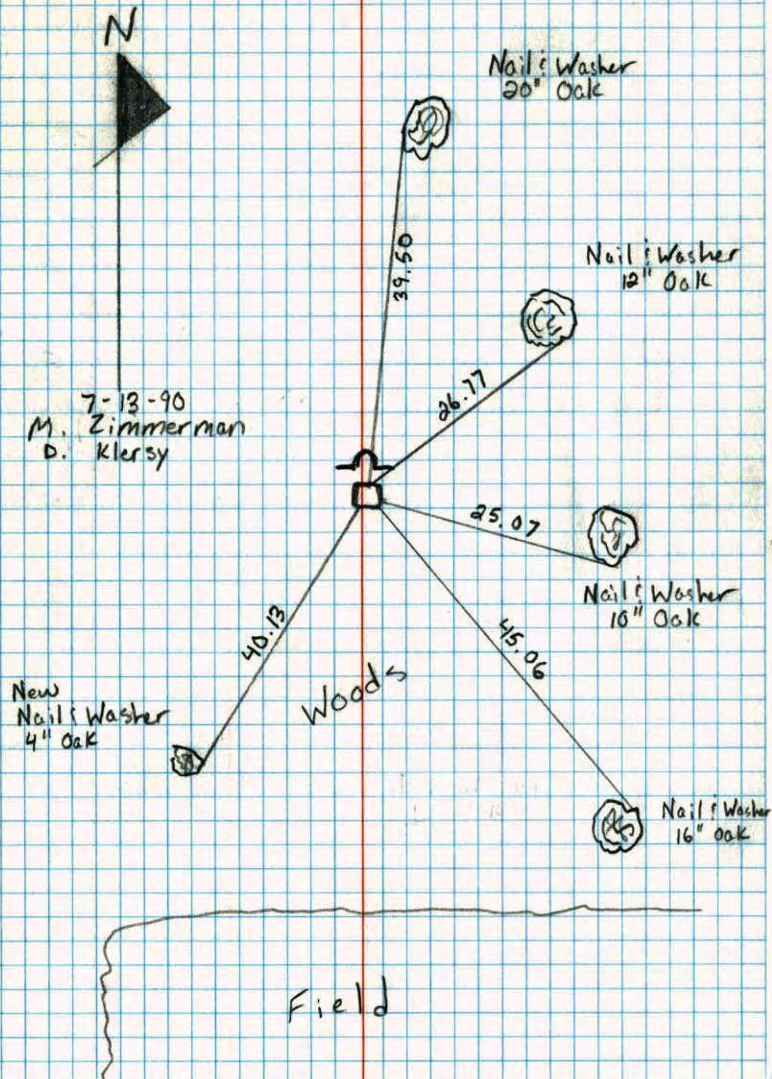

W $\frac{1}{16}$ th CORNER OF THE NE $\frac{1}{4}$
 SECTION 5 - T32 - R22

FOUND CONCRETE MONUMENT. PLACED WARNING
 SIGN 1'± NORTH OF MONUMENT.

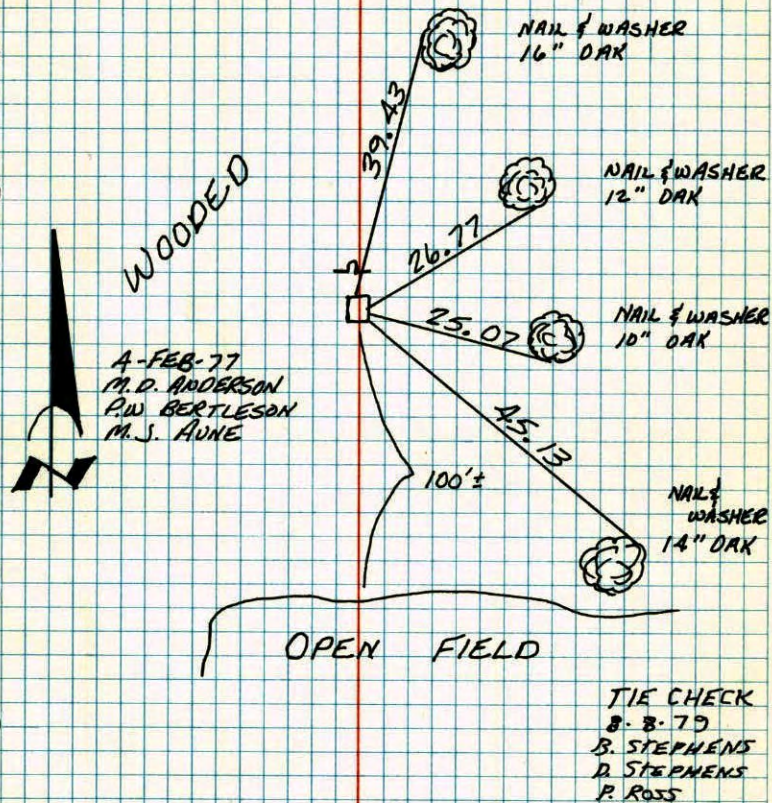

TEMPERATURE CORRECTED
 AND HORIZONTALLY
 TAPED MEASUREMENTS

ROLAND W. ANDERSON
 COUNTY SURVEYOR
 ANOKA COUNTY, MINNESOTA

W 1/4th Cor. of the N.E. 1/4 Sec 5-T32-R22

found down Mon.

Placed Warning sign 1^{1/2} N of Mon.

