

CERTIFICATE OF LOCATION OF GOVERNMENT CORNER

County of Anoka

State of Minnesota

CENTER Corner of Sec. 2 Township 32 Range 22

I hereby certify that on the 23 day of SEPT, 1969, I found the described corner which was evidenced by TIES BY J. KURTH

and I further certify that to perpetuate the location of said corner, I did, at the exact location thereof, place a permanent marker consisting of 3/4" IRON PIPE

which reference or witness monuments are located in the manner following:

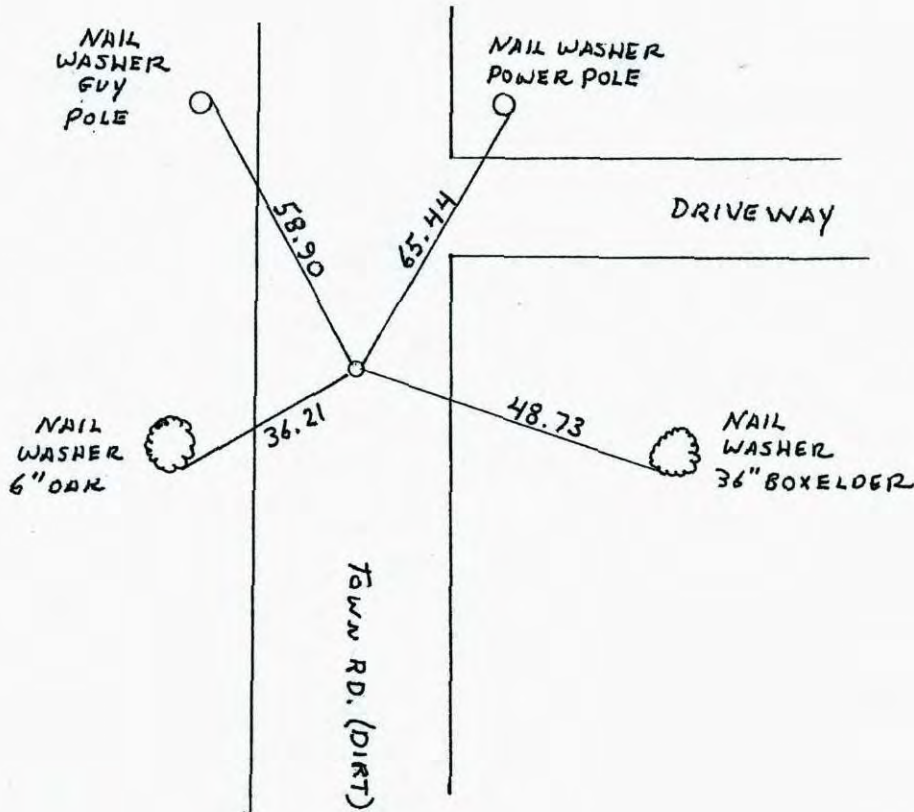

Revised date	Revised date	Revised date
8-23-69		
6-5-73		
9-5-76		
7-9-82		
8-13-85		
REDRAWN 5-8-87 HL		

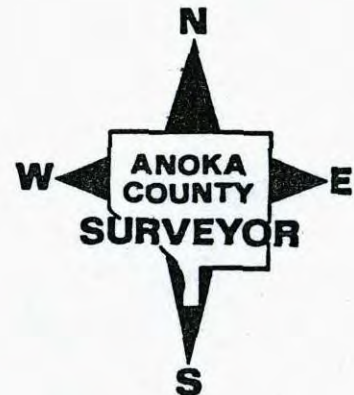

Center of Sec. 2-T32-R22

Ties Taken by Jim Kurth, Apr. 1968

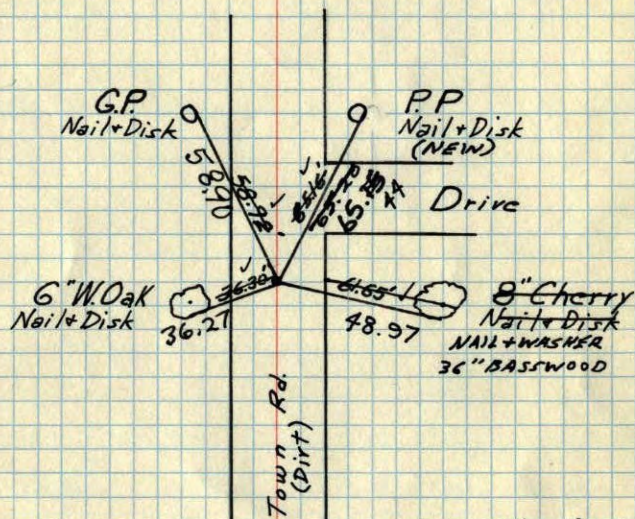
 $\frac{3}{4}$ " Open Iron, Down. 0.6' 0.5'Tie Check
Sept. 23, 1969
D. Powell
R. OlsonTIE CHECK
7-30-73
B. STEPHENS
D. STEPHENS
R. ROSSTIES CHECKED
June 5, 1973
B. OLSON
D. BRIEN
D. FARMERTIES CHECKED
8-5-76
D. ADAMS
S. BRIEN
J. STEPHENSTEMPERATURE CORRECTED
AND HORIZONTALLY
TAPED MEASUREMENTSROLAND W. ANDERSON
COUNTY SURVEYOR
ANOKA COUNTY, MINNESOTA

Center of Sec. 2-T32-R22

Ties Taken by Jim Kurth, Apr. 1968

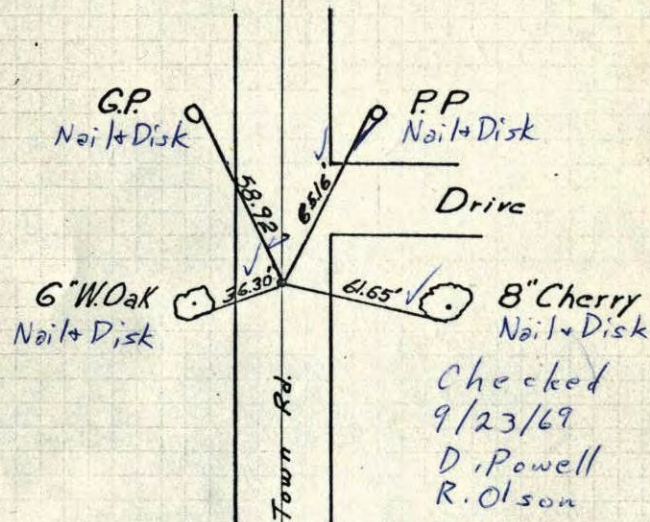
 $\frac{3}{4}$ " Open Iron, Down. 0.6' 0.5'Checked
9/23/69
D. Powell
R. Olson

Center of Sec 2 T32 R22

Ties Taken by Don C. Holt, Set a Spike as center. down 0.1'

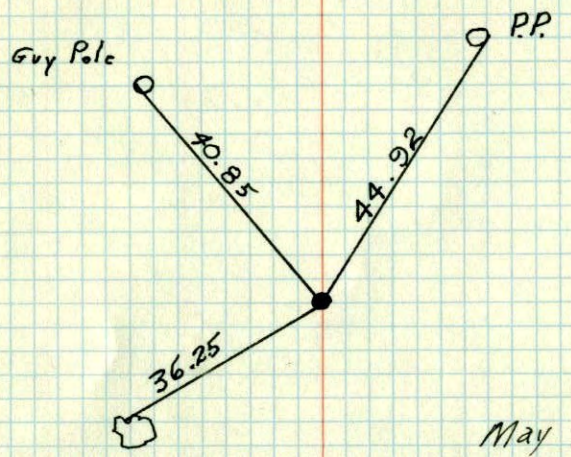

May 1965

Could not find.
8/16/68
DP

Center Sec. 2, T32, R22

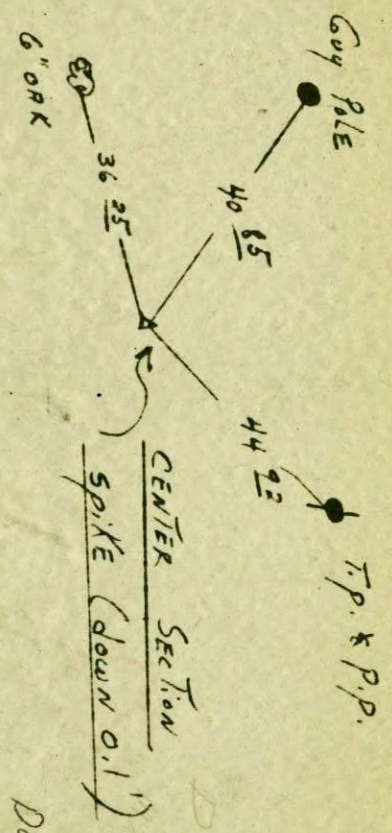

Don C. Holt
May 1965

