

CERTIFICATE OF LOCATION OF GOVERNMENT CORNER

County of Anoka

State of Minnesota

N. W. Corner of Sec. 9 Township 32 Range 22

I hereby certify that on the 16 day of MAR., 19 77, I found the described corner which was evidenced by CONCRETE MONUMENT

and I further certify that to perpetuate the location of said corner, I did, at the exact location thereof, place a permanent marker consisting of CONCRETE MON.

which reference or witness monuments are located in the manner following:

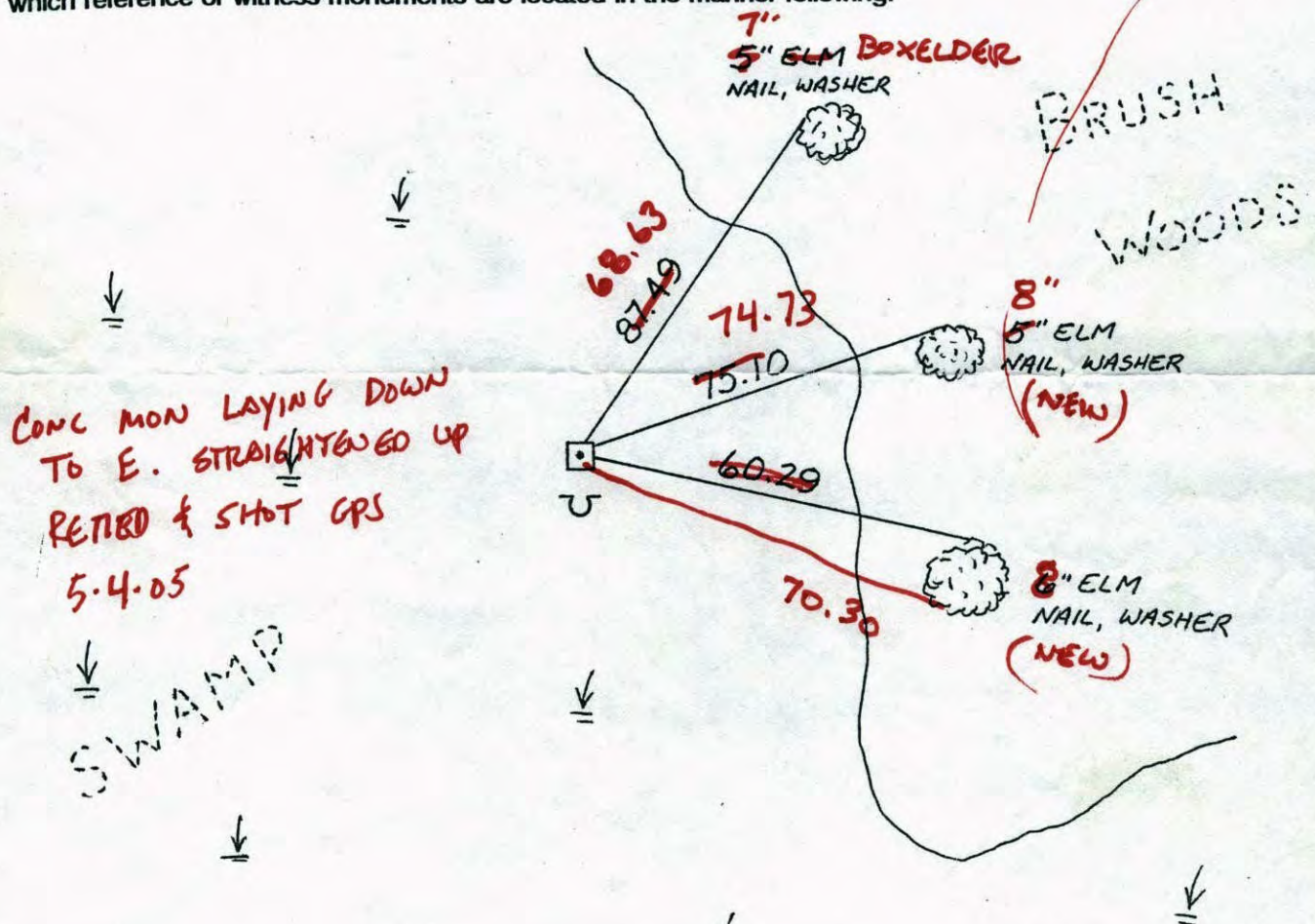

Revised date	Revised date	Revised date
WET 95		

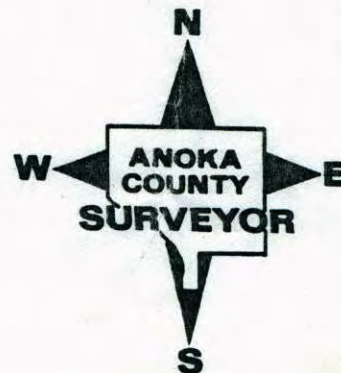

CERTIFICATE OF LOCATION OF GOVERNMENT CORNER

County of Anoka

State of Minnesota

N. W. Corner of Sec. 9 Township 32 Range 22

I hereby certify that on the 16 day of MAR., 19 77, I found the described corner which was evidenced by CONCRETE MONUMENT

and I further certify that to perpetuate the location of said corner, I did, at the exact location thereof, place a permanent marker consisting of CONCRETE MON.

which reference or witness monuments are located in the manner following:

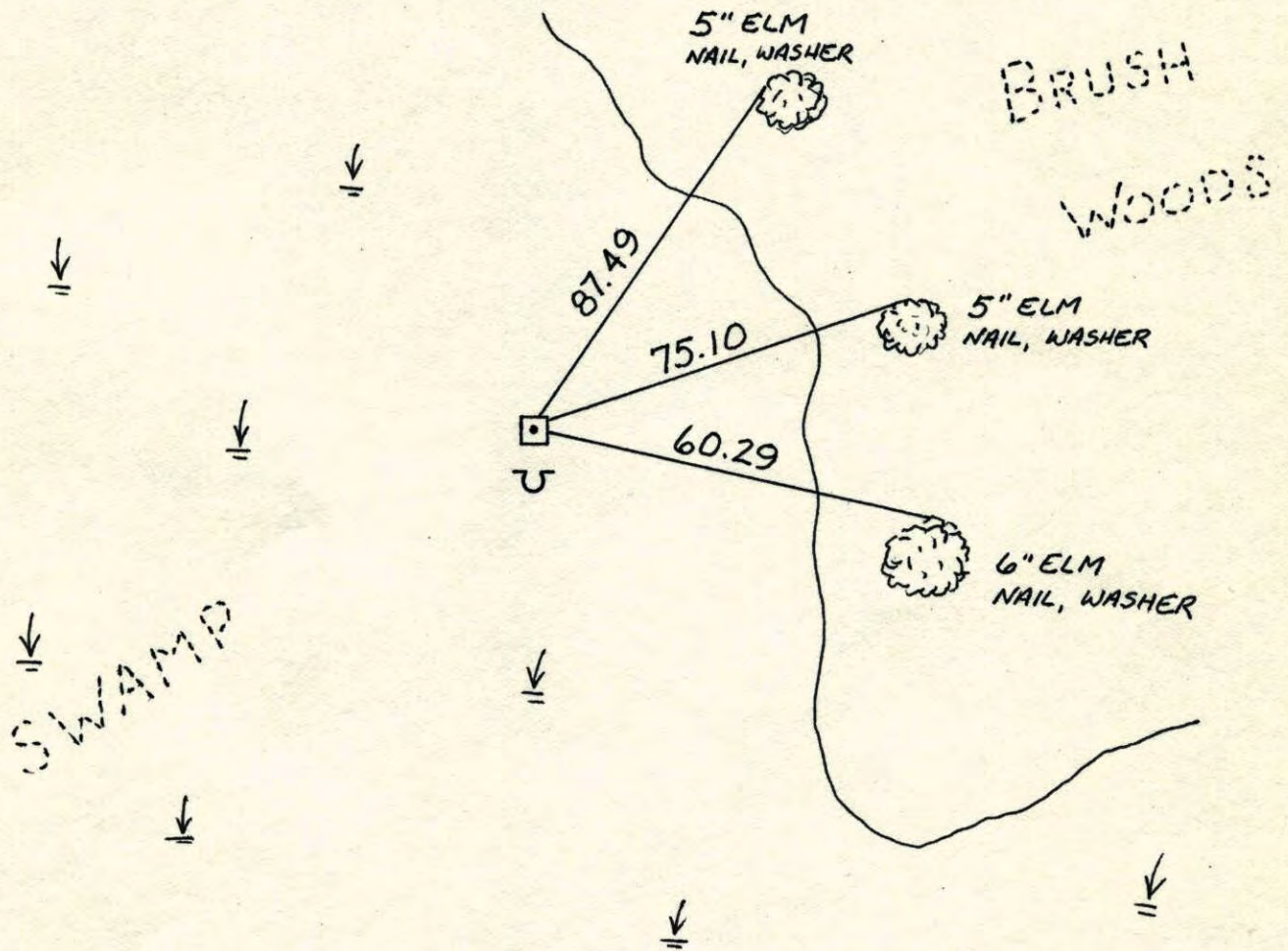

Revised date	Revised date	Revised date
WET 95		

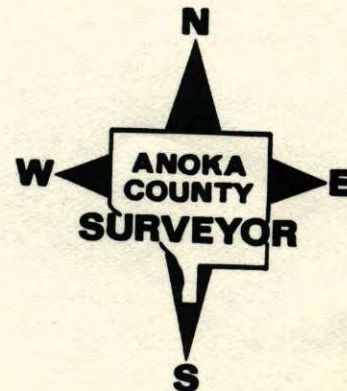

N.W. COR. SEC. 9-T32-R22

FOUND CONCRETE MONUMENT IN SWAMP (up 1.5')
 PLACED STEEL SIGN POST 1'± SOUTH OF
 MONUMENT WITH WARNING SIGN.

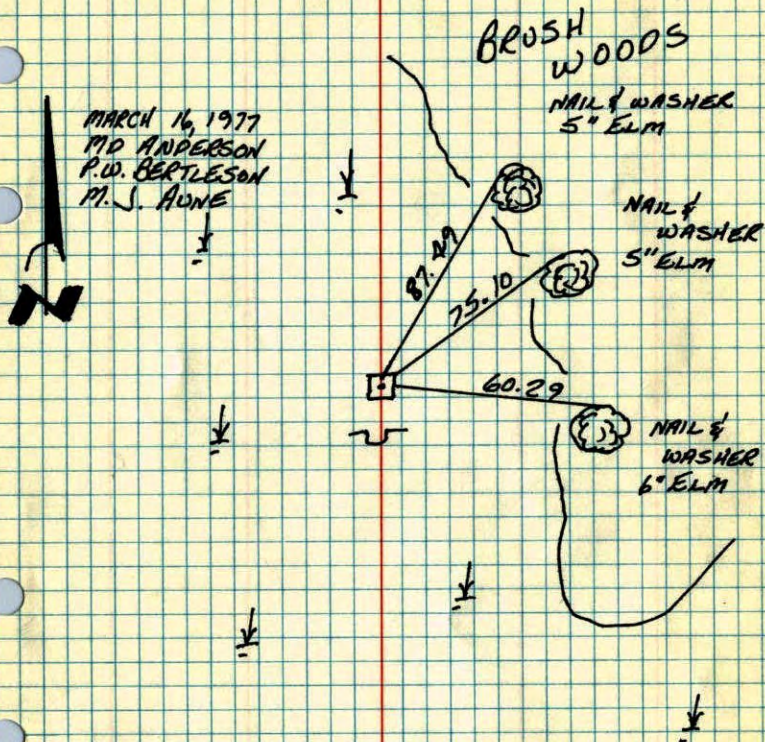

TEMPERATURE CORRECTED
 AND HORIZONTALLY
 TAPED MEASUREMENTS .

ROLAND W. ANDERSON
 COUNTY SURVEYOR
 ANOKA COUNTY, MINNESOTA

N.W. Cor. Sec. 9-T32-R22

Found Conc. Mon. in swamp (up 1.5')
 Placed steel sign post 1'± S. of mon. with
 warning sign

