

# CERTIFICATE OF LOCATION OF GOVERNMENT CORNER

County of Anoka

State of Minnesota

North 1/4 Corner of Sec. 13 Township 32 Range 22

On the 14th day of February, 1979, the described corner was evidenced by a 2" iron pipe

and to perpetuate the location of said corner, at the exact location thereof, a permanent marker was placed consisting of a red and white iron pipe

TELESPAR UP 1' w. SIGN RACING NORTH

AND on the 11th day of January, 2006, said permanent marker was found up 2'± and the ties were updated

Updated reference ties are as shown below.

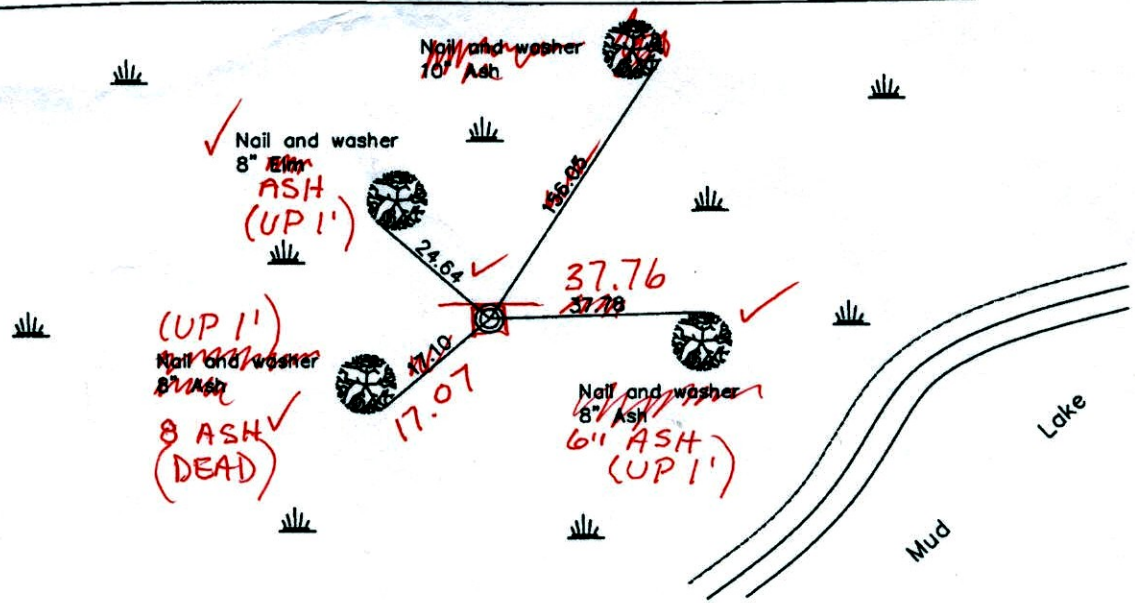
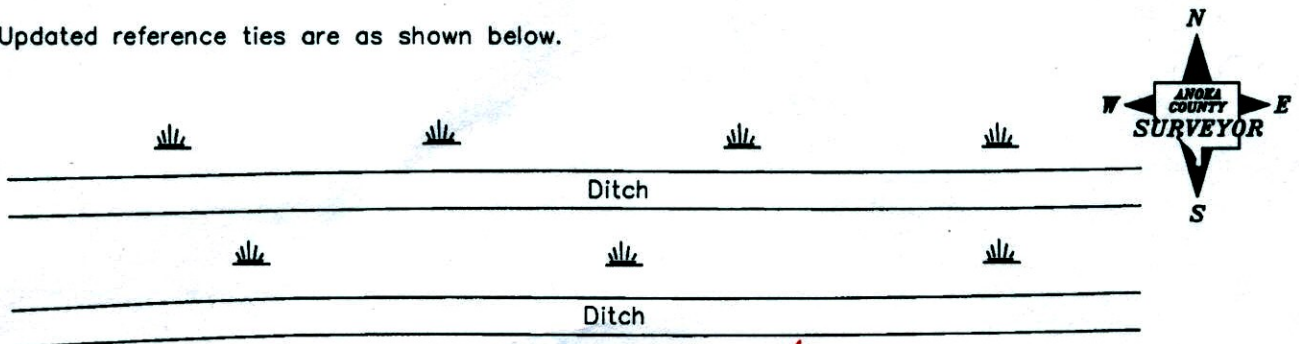

12-17-14  
BK-SS  
TAPED

Revised date
1985
1995
1/11/06

N.A.D. 1983 Coordinates (1996 Adjustment)	
County Project Coordinates	
Northing	185122.4252
Easting	561015.4990
Date	1/11/06

I hereby certify that this United States public land survey monument record is correct and complete to the best of my knowledge and belief.

*Larry D. Hoium* Date 1/11/06

Larry D. Hoium, Anoka County Surveyor

Minnesota License Number 18165

3D = 0.07      N = 185122.4464      E = 561015.5005

# CERTIFICATE OF LOCATION OF GOVERNMENT CORNER

County of Anoka

State of Minnesota

North  $\frac{1}{4}$  Corner of Sec. 13 Township 32 Range 22

On the 14th day of February, 1979, the described corner was evidenced by a 2" iron pipe

and to perpetuate the location of said corner, at the exact location thereof, a permanent marker was placed consisting of a red and white iron pipe

AND on the 11th day of January, 2006, said permanent marker was found up 2'± and the ties were updated

Updated reference ties are as shown below.

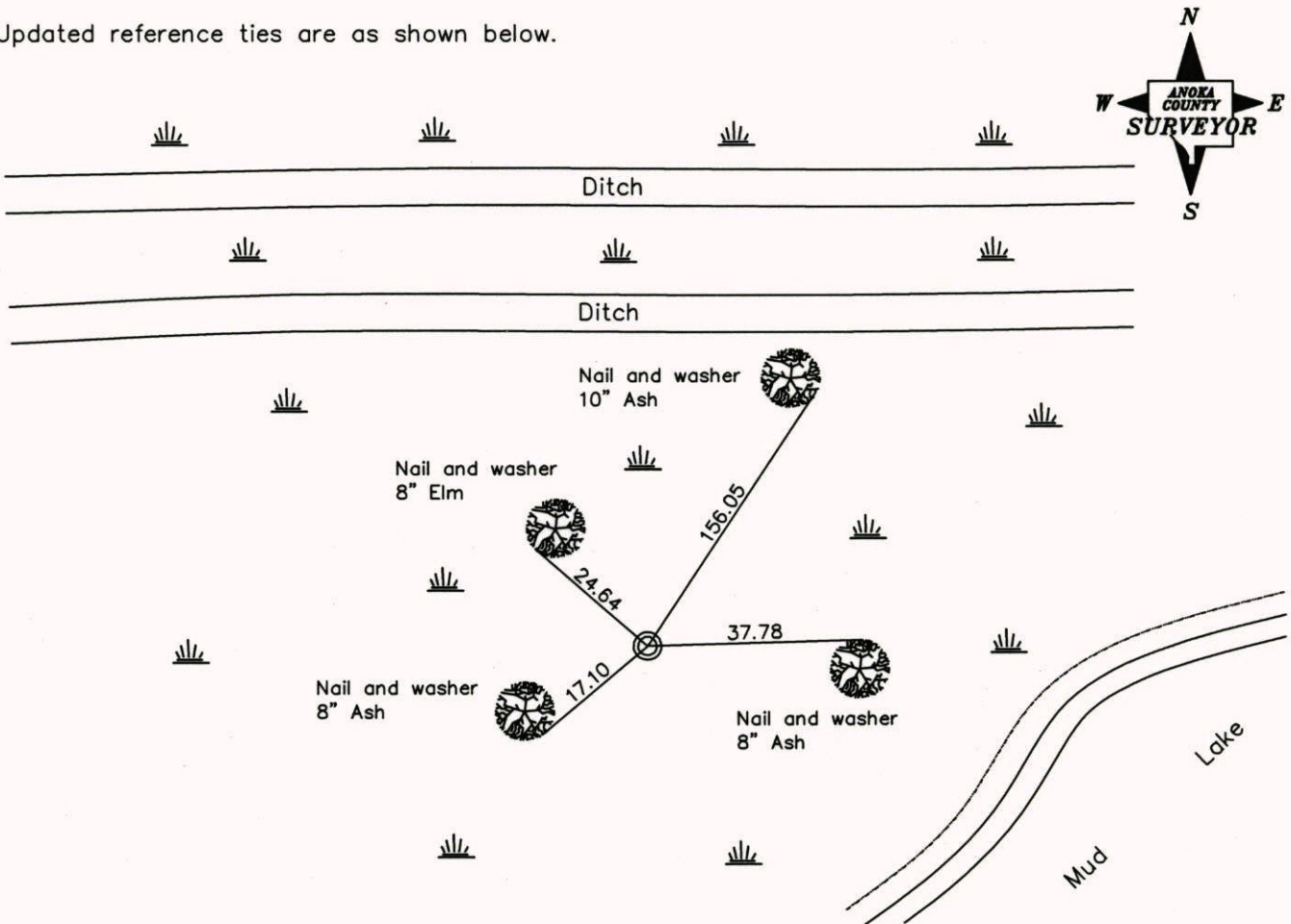

**Revised date**

1985
1995
1/11/06

**N.A.D. 1983 Coordinates  
(1996 Adjustment)**

County Project Coordinates
Northing <u>185122.4252</u>
Easting <u>561015.4990</u>
Date <u>1/11/06</u>

I hereby certify that this United States public land survey monument record is correct and complete to the best of my knowledge and belief.

*Larry D. Hoium* Date 1/11/06  
 \_\_\_\_\_, Anoka County Surveyor  
 Minnesota License Number 18165



# CERTIFICATE OF LOCATION OF GOVERNMENT CORNER

County of Anoka

State of Minnesota

NORTH 1/4 Corner of Sec. 13 Township 32 Range 22

I hereby certify that on the 14 day of FEB., 1979, I found the described corner which was evidenced by 2" IRON PIPE

and I further certify that to perpetuate the location of said corner, I did, at the exact location thereof, place a permanent marker consisting of RED & WHITE IRON PIPE (UP 2' +/-)

which reference or witness monuments are located in the manner following:

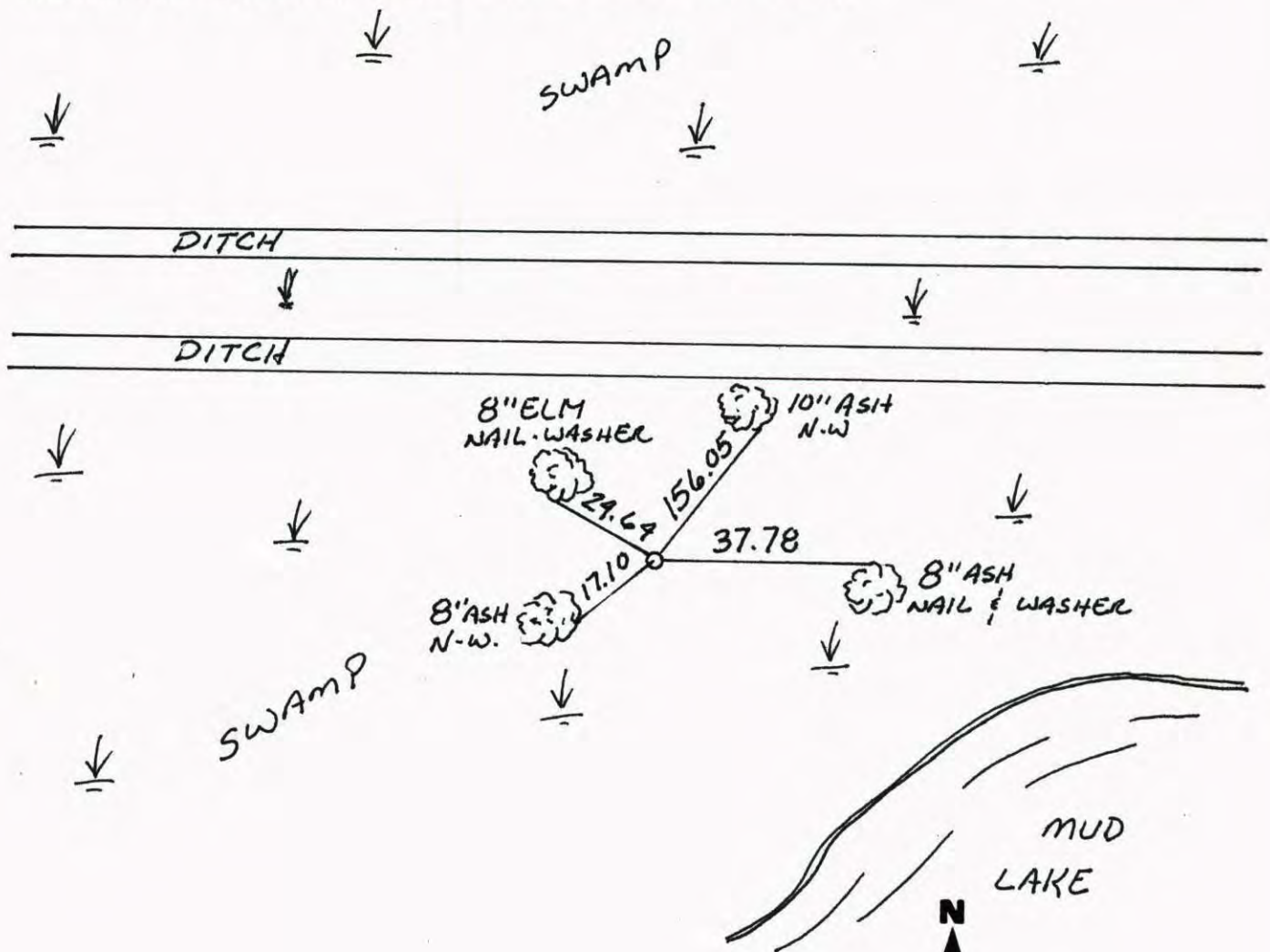

Revised date	Revised date	Revised date
WET '85		
" 95		
1-11-06		

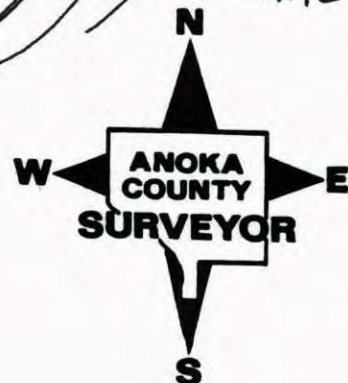



1-11-06  
GPS'D

# CERTIFICATE OF LOCATION OF GOVERNMENT CORNER

County of Anoka State of Minnesota

NORTH QUARTER Corner of Sec. 13 Township 32 Range 22

I hereby certify that on the 14<sup>th</sup> day of FEBRUARY, 1979, I found the described corner which was evidenced by 2" IRON PIPE

and I further certify that to perpetuate the location of said corner, I did, at the exact location thereof, place a permanent marker consisting of RED & WHITE IRON PIPE (UP 2' 3")

which reference or witness monuments are located in the manner following:

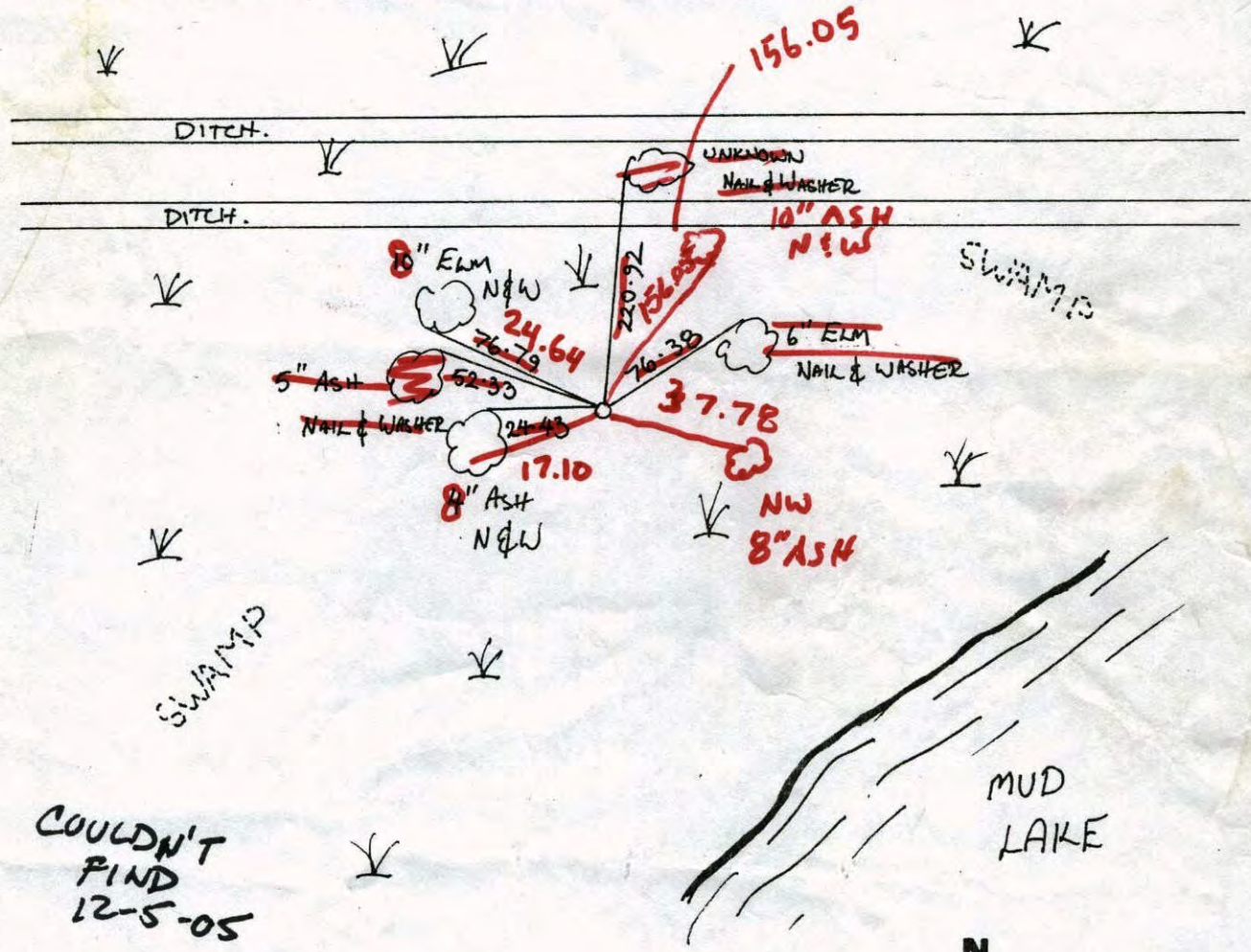

Revised date	Revised date	Revised date
WET 85		
" 95		

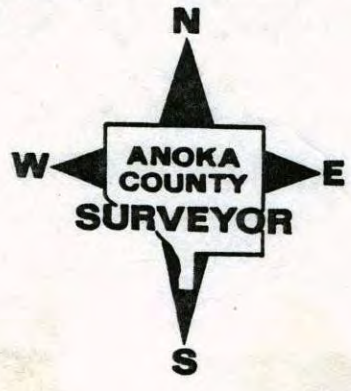



N<sup>1</sup>/<sub>4</sub> CORNER SECTION 13-T32-R22

REPLACED OLD 2" IRON PIPE WITH RED AND WHITE IRON PIPE AND TIED. IRON PIPE UP 2.5' WITH SIGN.

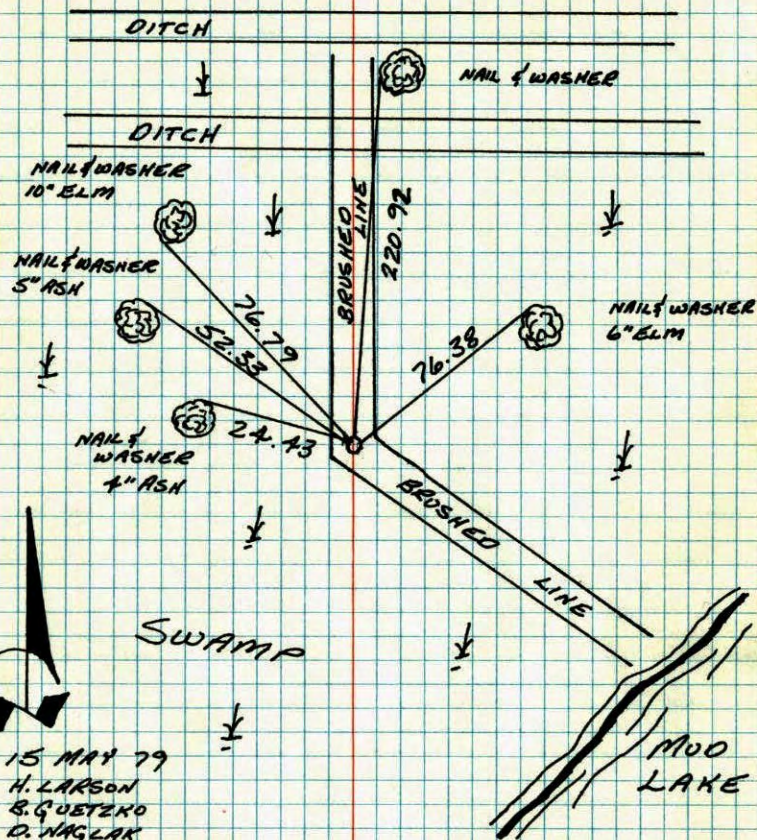

15 MAY 79  
H. LARSON  
B. GUETZKO  
D. NAGLAK

TEMPERATURE CORRECTED  
AND HORIZONTALLY  
TAPED MEASUREMENTS

ROLAND W. ANDERSON  
COUNTY SURVEYOR  
ANOKA COUNTY, MINNESOTA

N<sup>1</sup>/<sub>4</sub> COR. SECTION 13 T32 R22

REPLACED OLD 2" IRON PIPE WITH RED AND WHITE IRON PIPE AND TIED. I.P. UP 2.5' WITH SIGN.

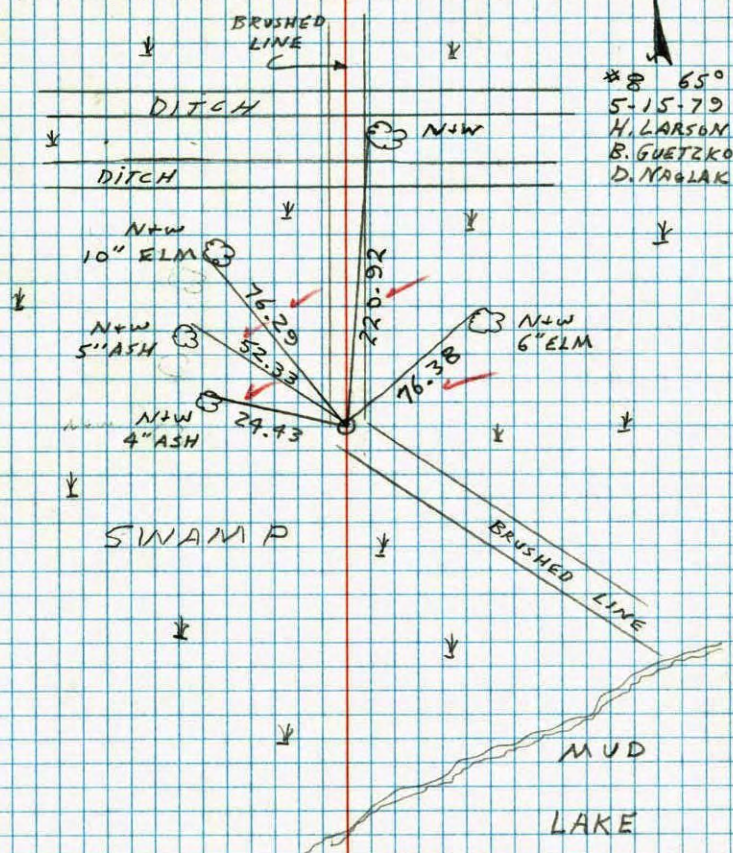

\*8 65°  
5-15-79  
H. LARSON  
B. GUETZKO  
D. NAGLAK



N<sup>1</sup>/<sub>4</sub> CORNER SECTION 13-T32-R22

FOUND AND TIED INTO SECTION WORK, A 2" IRON PIPE USED BY DON HULT. PIPE FLUSH IN SWAMP WITH STEEL POST ON SOUTH SIDE.

14 FEB 79  
H. LARSON  
D. NAGLAK

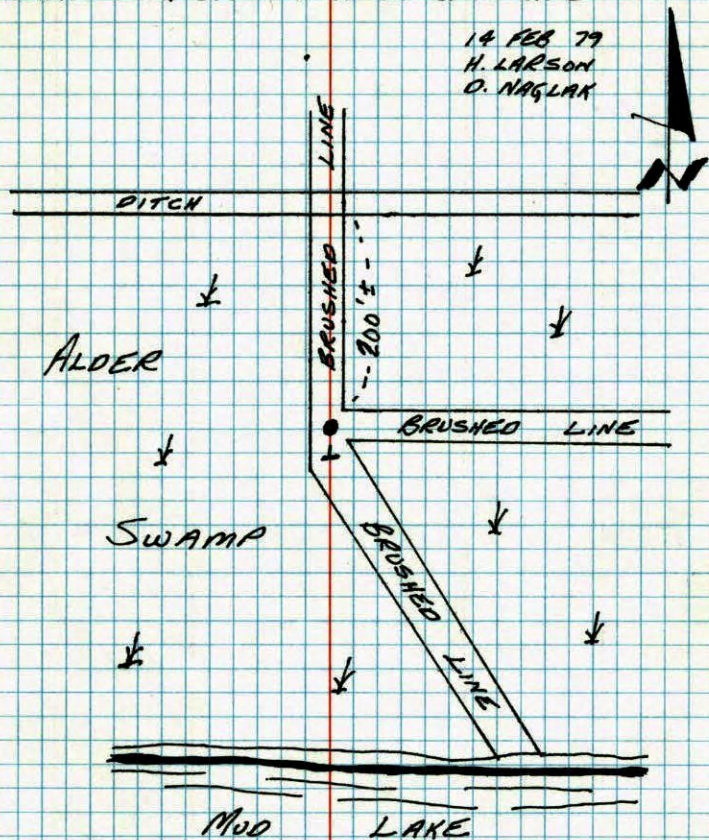

SEE NEW TIE BOOK  
R+W IP. TIED H.L.

TEMPERATURE CORRECTED  
AND HORIZONTALLY  
TAPED MEASUREMENTS

ROLAND W. ANDERSON  
COUNTY SURVEYOR  
ANOKA COUNTY, MINNESOTA

N<sup>1</sup>/<sub>4</sub> Cor. Section 13 T32 R22

Found and tied in, 2" iron pipe used by D. Hult. pipe flush in swamp with steel post on south side.

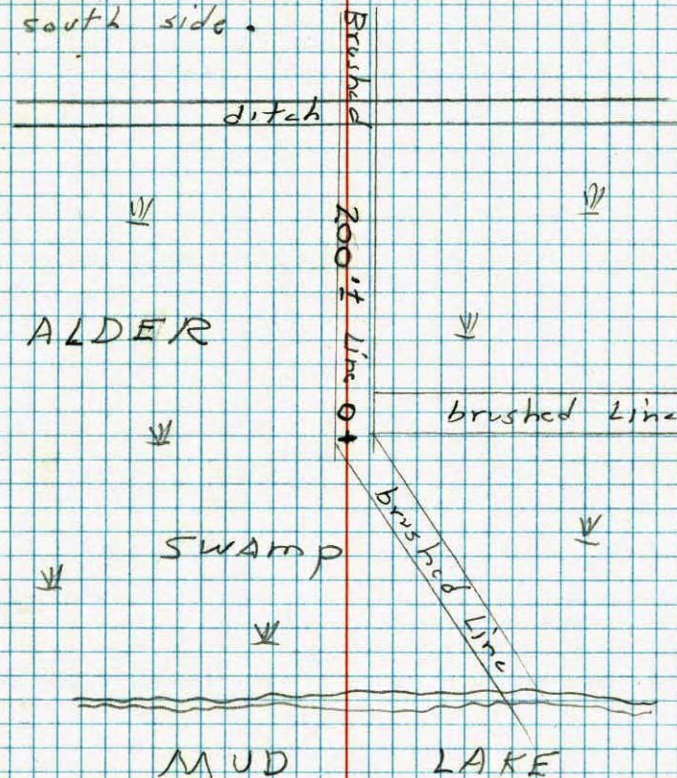

2-14-79

H. Larson  
D. Naglak