

CERTIFICATE OF LOCATION OF GOVERNMENT CORNER

County of Anoka

State of Minnesota

North 1/4 Corner of Sec. 16 Township 32 Range 22

On the 27th day of December, 1976, the described corner was evidenced by area resurvey

and to perpetuate the location of said corner, at the exact location thereof, a permanent marker was placed consisting of a red and white iron pipe - SIGN FACING SOUTH (LEANING E. SLIGHTLY)

AND on the 15th day of February, 2006, said permanent marker was found up 1.5'± ✓

Updated reference ties are as shown below.

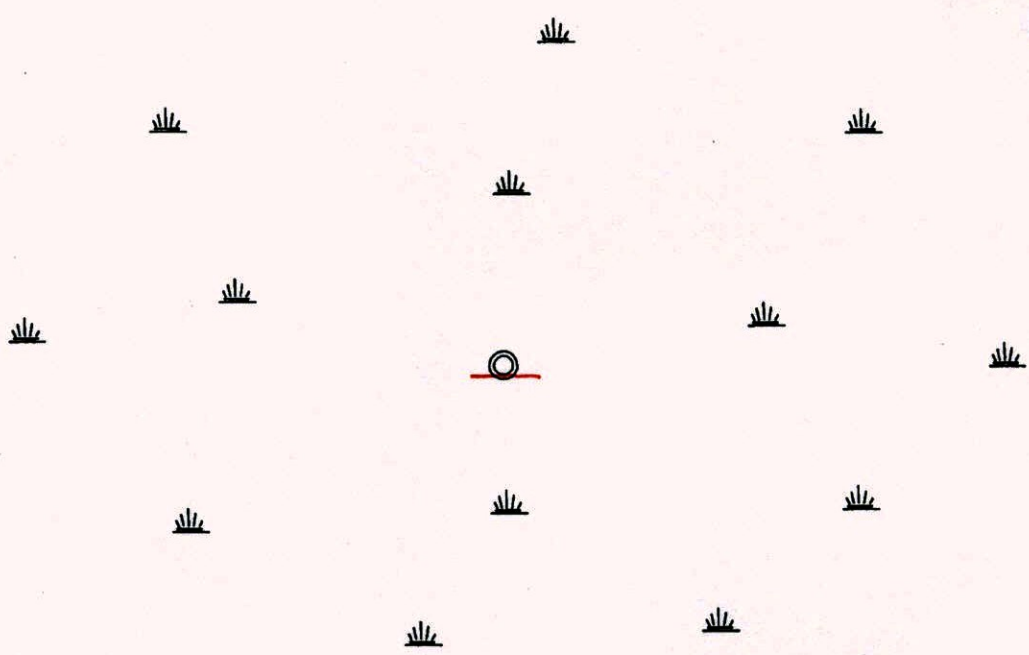
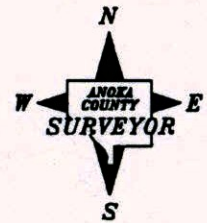

12-12-14
BK-SS

Revised date

1985
1995
2/15/06

N.A.D. 1983 Coordinates
(1996 Adjustment)

County Project Coordinates	
Northing	<u>185213.5677</u>
Easting	<u>545353.5351</u>
Date	<u>2/15/06</u>

I hereby certify that this United States public land survey monument record is correct and complete to the best of my knowledge and belief.

 Date 2/15/06
 _____, Anoka County Surveyor
 Minnesota License Number 18165

3D=0.07

N=185213.5171

E=545353.6545

CERTIFICATE OF LOCATION OF GOVERNMENT CORNER

County of Anoka

State of Minnesota

North 1/4 Corner of Sec. 16 Township 32 Range 22

On the 27th day of December, 1976, the described corner was evidenced by area resurvey

and to perpetuate the location of said corner, at the exact location thereof, a permanent marker was placed consisting of a red and white iron pipe

AND on the 15th day of February, 2006, said permanent marker was found up 1.5'±

Updated reference ties are as shown below.

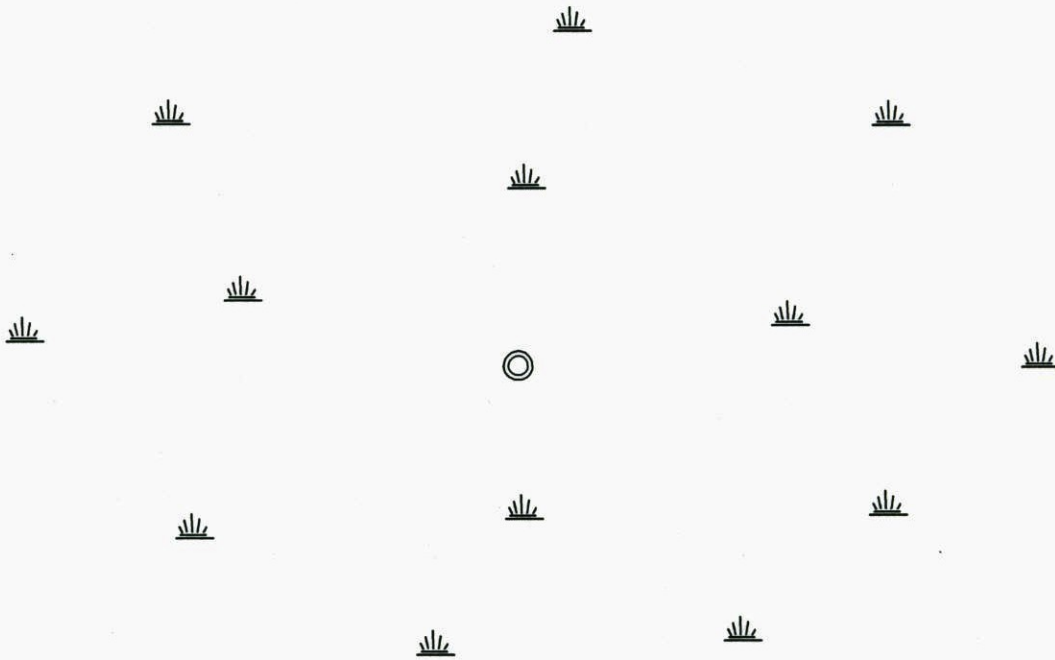
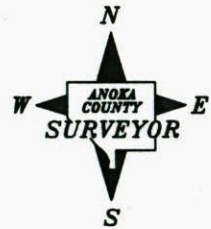

Revised date

1985
1995
2/15/06

N.A.D. 1983 Coordinates
(1996 Adjustment)

County Project Coordinates	
Northing	<u>185213.5677</u>
Easting	<u>545353.5351</u>
Date	<u>2/15/06</u>

I hereby certify that this United States public land survey monument record is correct and complete to the best of my knowledge and belief.

Larry D. Hoium Date 2/15/06
 _____, Anoka County Surveyor
 Minnesota License Number 18165

SAOT 6PS 2.15.06

CERTIFICATE OF LOCATION OF GOVERNMENT CORNER

County of Anoka

State of Minnesota

NORTH QTR. Corner of Sec. 16 Township 32 Range 22

I hereby certify that on the 27 day of DEC., 1976, I found the described corner which was evidenced by AREA RESURVEY

and I further certify that to perpetuate the location of said corner, I did, at the exact location thereof, place a permanent marker consisting of RED, WHITE I.P. UP 1.5'±

which reference or witness monuments are located in the manner following:

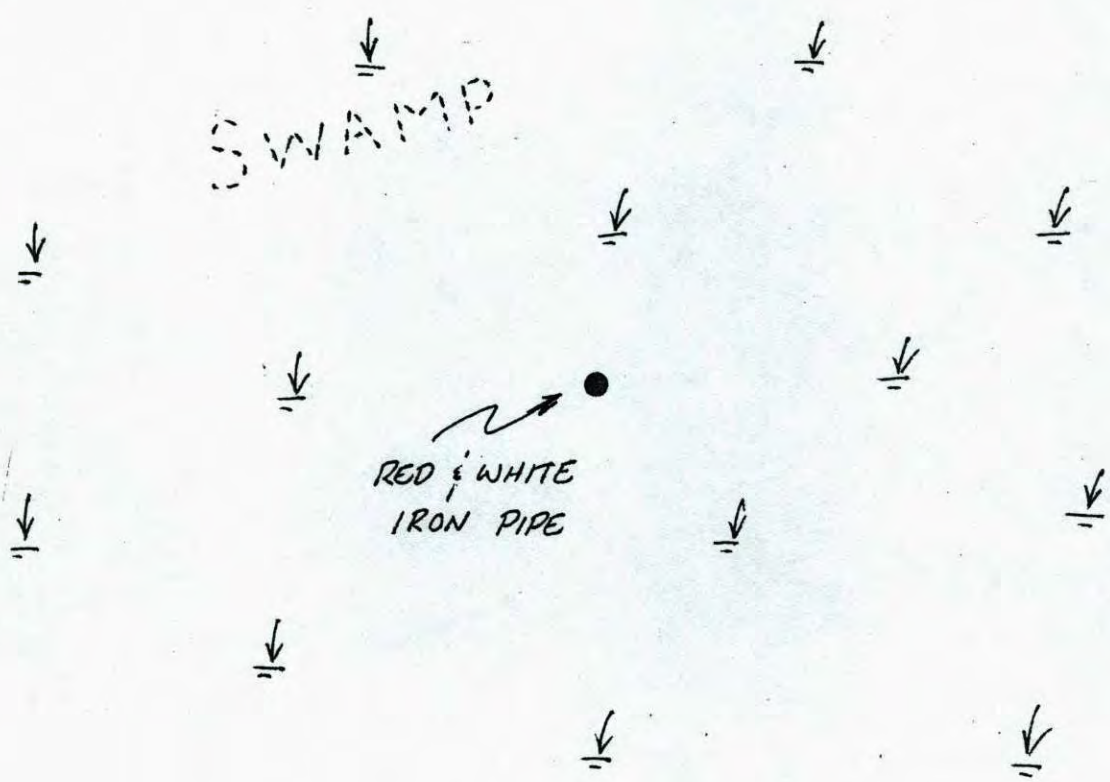

Revised date	Revised date	Revised date
WET 85		
" 95		

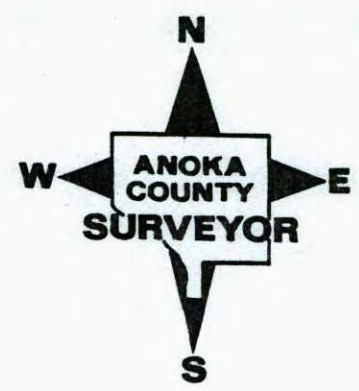

CERTIFICATE OF LOCATION OF GOVERNMENT CORNER

County of Anoka

State of Minnesota

NORTH QTR. Corner of Sec. 16 Township 32 Range 22

I hereby certify that on the 27 day of DEC., 1976, I found the described corner which was evidenced by AREA RESURVEY

and I further certify that to perpetuate the location of said corner, I did, at the exact location thereof, place a permanent marker consisting of RED, WHITE I. P.

which reference or witness monuments are located in the manner following:

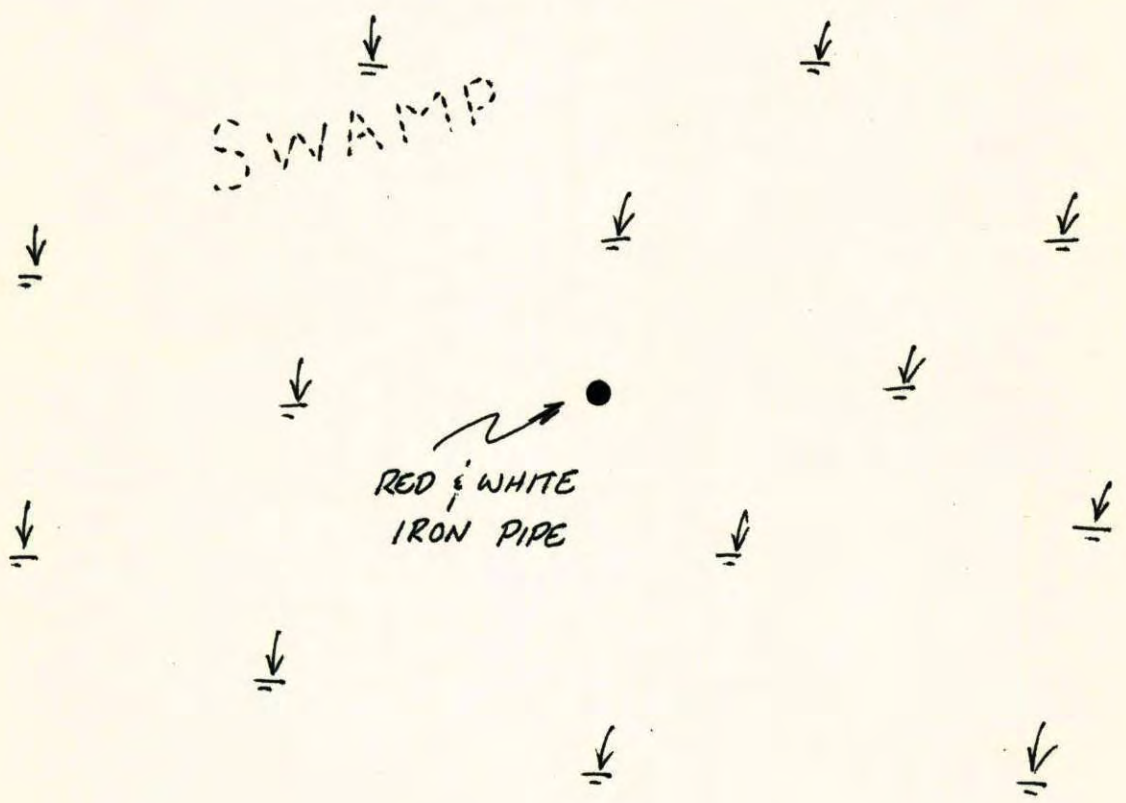

Revised date	Revised date	Revised date
WET 85		
" 95		

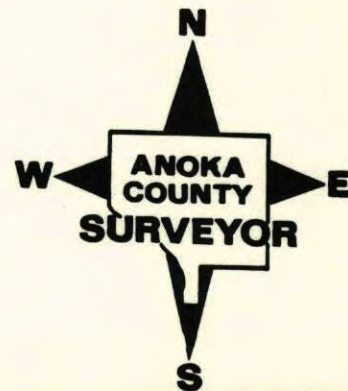

N¹/₄ Cor. Sec. 16, T32, R22

SET RED AND WHITE IRON PIPE FROM AREA RESURVEY.
 PLACED WARNING SIGN ON RED AND WHITE IRON PIPE
 CORNER IN SWAMP

27 DEC 76
 M.D. ANDERSON
 P.W. BERTLESON
 M.J. AUNE



TEMPERATURE CORRECTED
 AND HORIZONTALLY
 TAPED MEASUREMENTS

ROLAND W. ANDERSON
 COUNTY SURVEYOR
 ANOKA COUNTY, MINNESOTA

North ¹/₄ Cor. Sec. 16-T32-R22

Set Red & White Iron pipe from area resurvey
 Placed warning sign on Red & White Iron pipe
 Cor. in Swamp



Dec. 27, 1976
 M.D. Anderson
 P.W. Bertleson
 M.J. Aune

Make reot Notes