

# CERTIFICATE OF LOCATION OF GOVERNMENT CORNER

County of Anoka

State of Minnesota

Witness Corner of Sec. 23 Township 32 Range 22  
(on south line of section)

On the 28th day of February, 1983, the described corner was evidenced by area resurvey

and to perpetuate the location of said corner, at the exact location thereof, a permanent marker was placed consisting of a cast iron monument with a sign and post on the north side

AND on the 17th day of January, 2007, said permanent marker was found and the ties were updated

Updated reference ties are as shown below.

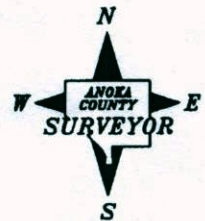

Field

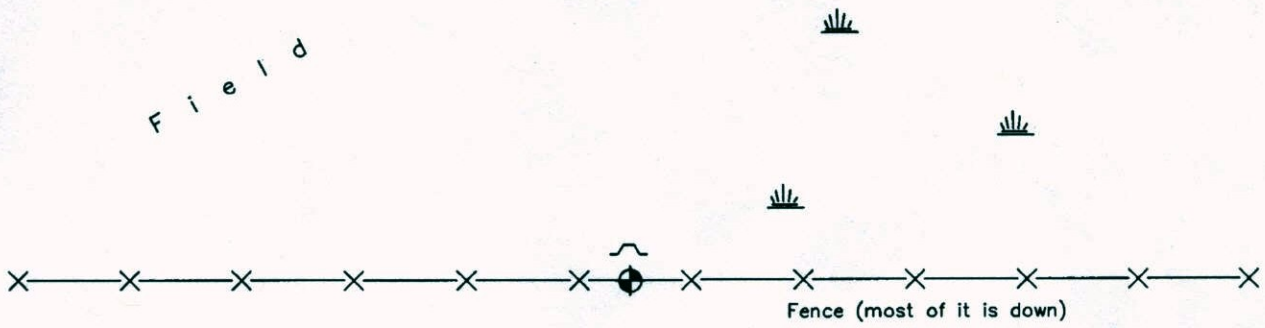

SMALL TREES ? BRUSH

9-24-14  
BK-55  
VRS

Revised date

1/14/92
8/18/95
1/17/07

N.A.D. 1983 Coordinates  
(1996 Adjustment)

County Project Coordinates

Northing	174710.7680
Easting	554156.0574
Date	1/26/06

I hereby certify that this United States public land survey monument record is correct and complete to the best of my knowledge and belief.

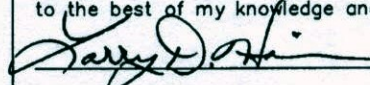
 Date 1/17/07  
 \_\_\_\_\_, Anoka County Surveyor  
 Minnesota License Number 18165

3D=0.06

N=174710.7335 E=554156.0014

# CERTIFICATE OF LOCATION OF GOVERNMENT CORNER

County of Anoka

State of Minnesota

Witness Corner of Sec. 23 Township 32 Range 22  
(on south line of section)

On the 28th day of February, 1983, the described corner was evidenced by area resurvey

and to perpetuate the location of said corner, at the exact location thereof, a permanent marker was placed consisting of a cast iron monument with a sign and post on the north side

AND on the 17th day of January, 2007, said permanent marker was found and the ties were updated

Updated reference ties are as shown below.



F i e l d

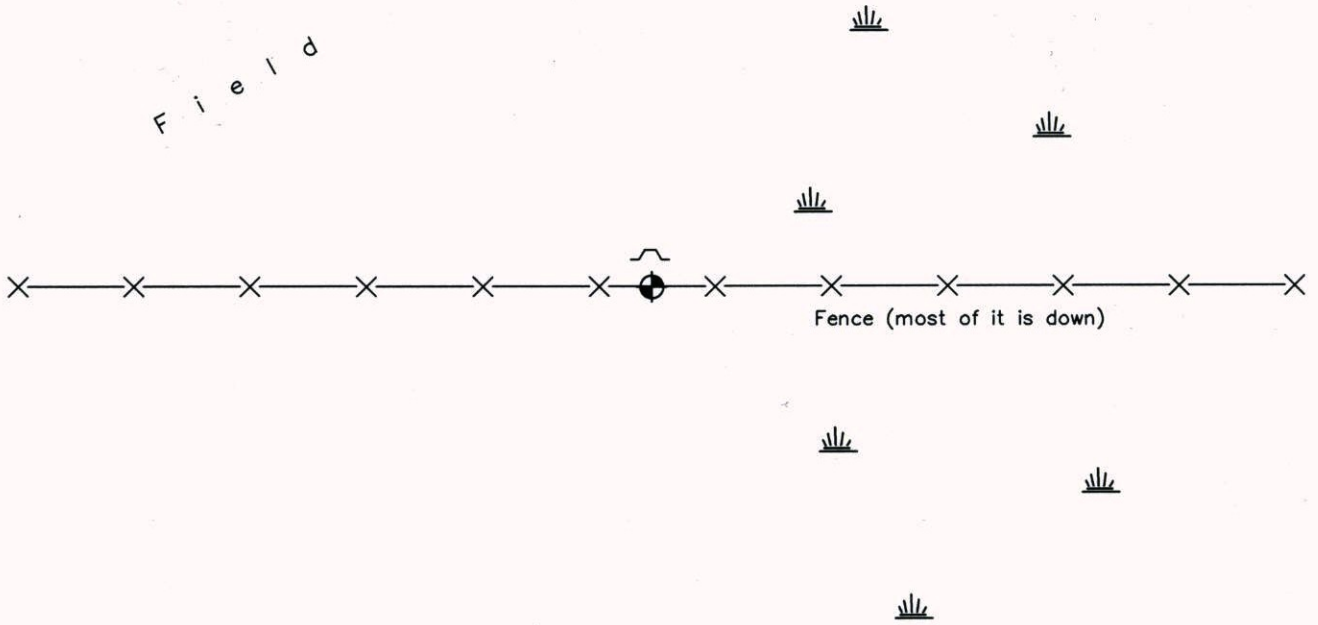

Revised date
1/14/92
8/18/95
1/17/07

N.A.D. 1983 Coordinates (1996 Adjustment)	
County Project Coordinates	
Northing	<u>174710.7680</u>
Easting	<u>554156.0574</u>
Date	<u>1/26/06</u>

I hereby certify that this United States public land survey monument record is correct and complete to the best of my knowledge and belief.

*Larry D. Hoium* Date 1/17/07

Larry D. Hoium, Anoka County Surveyor

Minnesota License Number 18165



# CERTIFICATE OF LOCATION OF GOVERNMENT CORNER

County of Anoka

State of Minnesota

WITNESS Corner of Sec. 23 Township 32 Range 22  
 ON SOUTH LINE

I hereby certify that on the 28<sup>TH</sup> day of FEB., 1983, I found the described corner which was evidenced by AREA RESURVEY

and I further certify that to perpetuate the location of said corner, I did, at the exact location thereof, place a permanent marker consisting of CAST IRON MONUMENT. SIGN AND POST ON NORTH SIDE

which reference or witness monuments are located in the manner following:

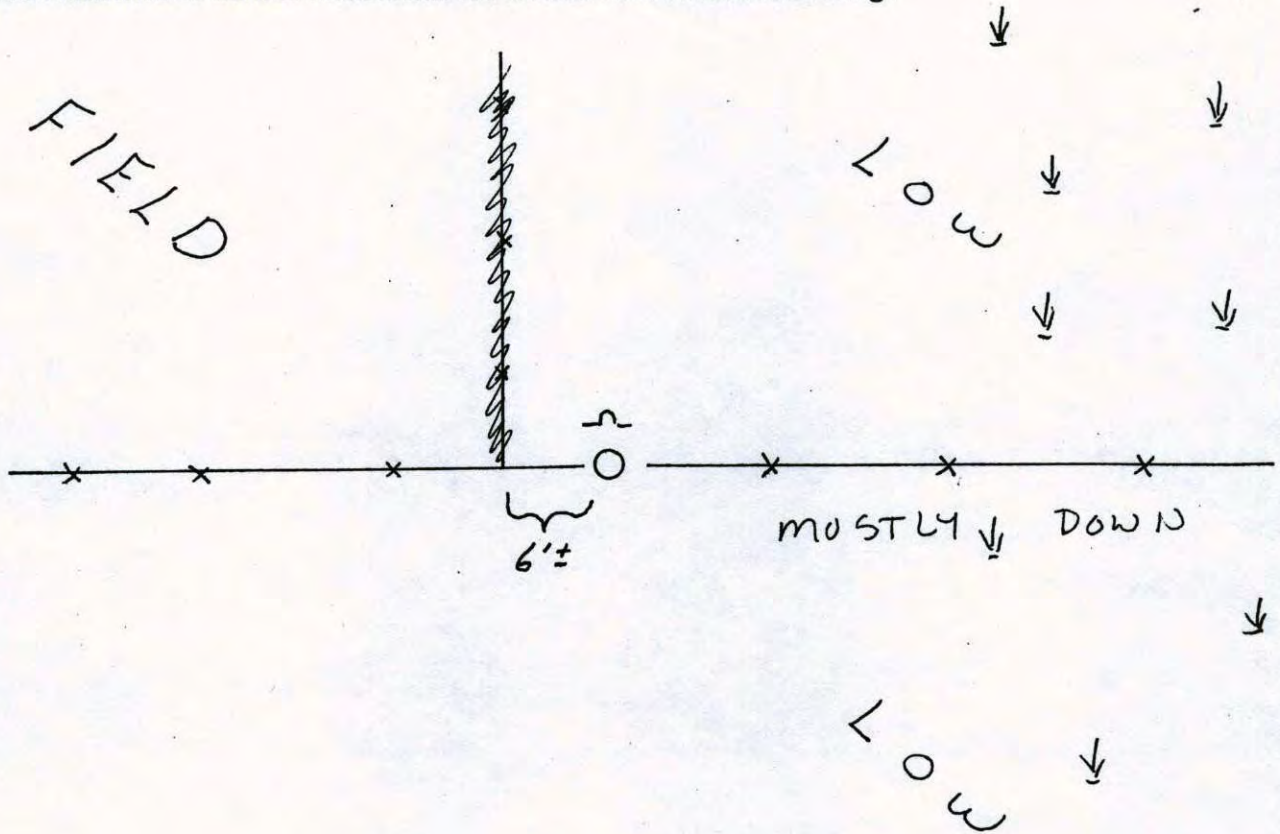

Revised date	Revised date	Revised date
2-28-83		
1-14-92		
8-18-95		
1-17-07		

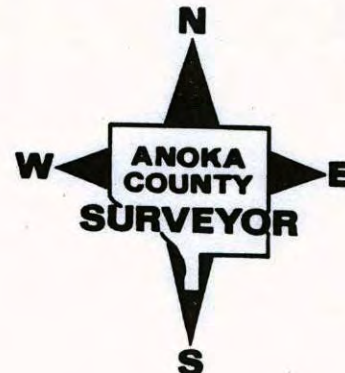



# CERTIFICATE OF LOCATION OF GOVERNMENT CORNER

County of Anoka

State of Minnesota

WITNESS Corner of Sec. 23 Township 32 Range 22  
 ON SOUTH LINE

I hereby certify that on the 28<sup>TH</sup> day of FEB., 19 83, I found the described corner which was evidenced by AREA RESURVEY

and I further certify that to perpetuate the location of said corner, I did, at the exact location thereof, place a permanent marker consisting of CAST IRON MONUMENT. SIGN AND POST ON NORTH SIDE

which reference or witness monuments are located in the manner following:

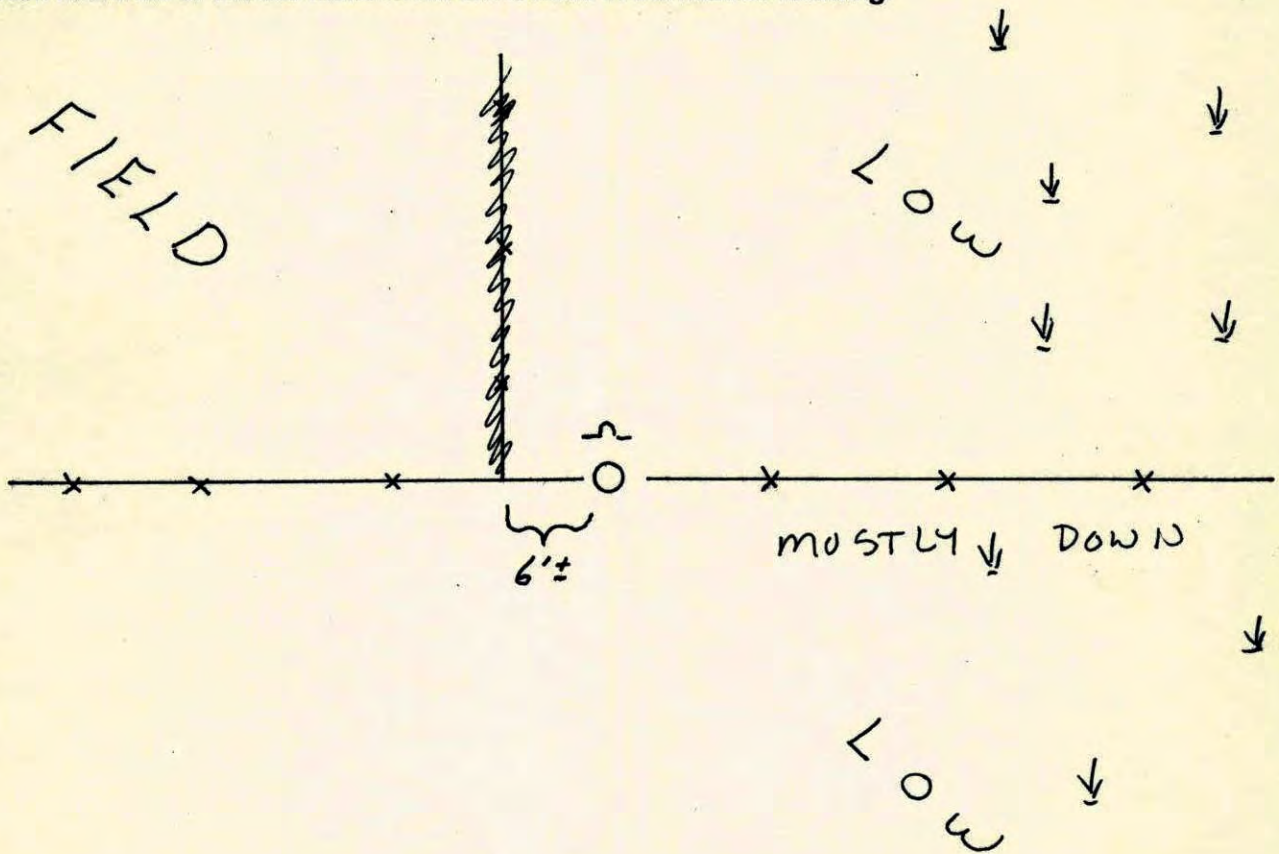

Revised date	Revised date	Revised date
2-28-83		
1-14-92		
8-18-95		
1-17-07		

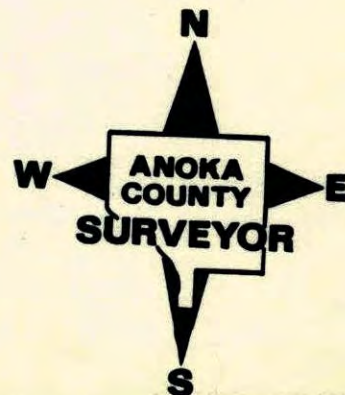



WC. ON SOUTH LINE OF SEC. 23 T32 R22  
 REPLACED  $\frac{1}{2}$ " IRON PIPE WITH CAST IRON  
 C.I., FLUSH WITH SIGN AND POST ON NORTH  
 SIDE.

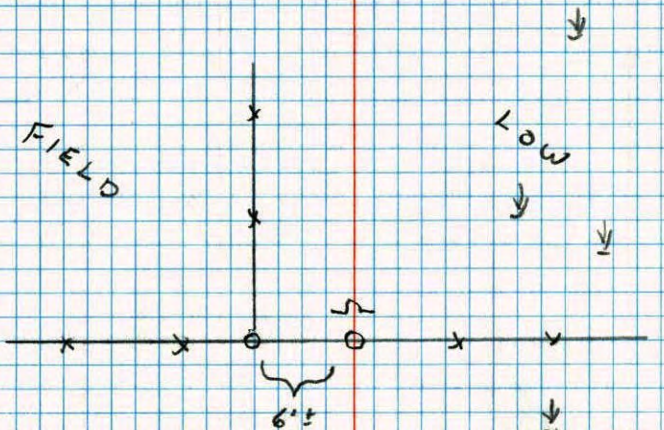

1-14-92  
 H. LARSON  
 B. KLEINZ  
 M. STEWART

NO. 448

TELEPHONE

WC ON SOUTH LINE OF SEC. 23 T32 R22  
 SET  $\frac{1}{2}$ " IR FROM AREA RESURVEY  
 SIGN AND POST ON NORTH SIDE.

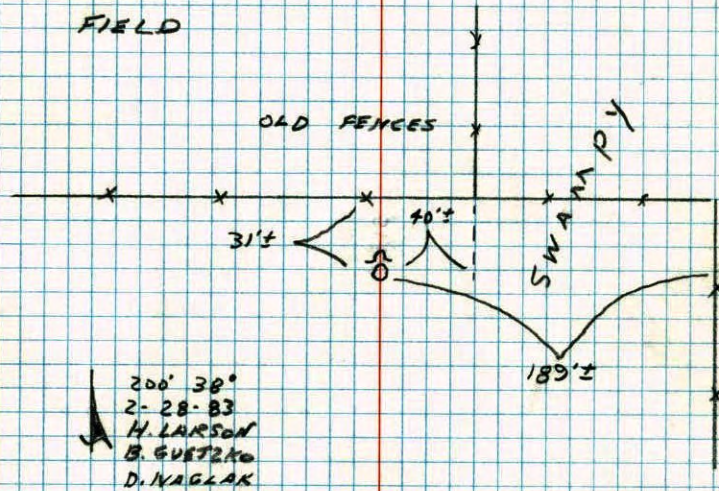

200' 38"  
 2-28-83  
 H. LARSON  
 B. GUSTAKO  
 D. NAGLAK

NO. 448

TELEPHONE