

CERTIFICATE OF LOCATION OF GOVERNMENT CORNER

County of Anoka

State of Minnesota

North $\frac{1}{4}$ Corner of Sec. 6 Township 31 Range 24

On the 26th day of July, 1966, the described corner was evidenced by a 6"X6" granite monument

and to perpetuate the location of said corner, at the exact location thereof, a permanent marker was placed consisting of a position on a manhole cover with punch marks on the manhole rim to the North, South, East and West

AND on the 15th day of July, 2022, said permanent marker was found and the ties were updated

Updated reference ties are as shown below.

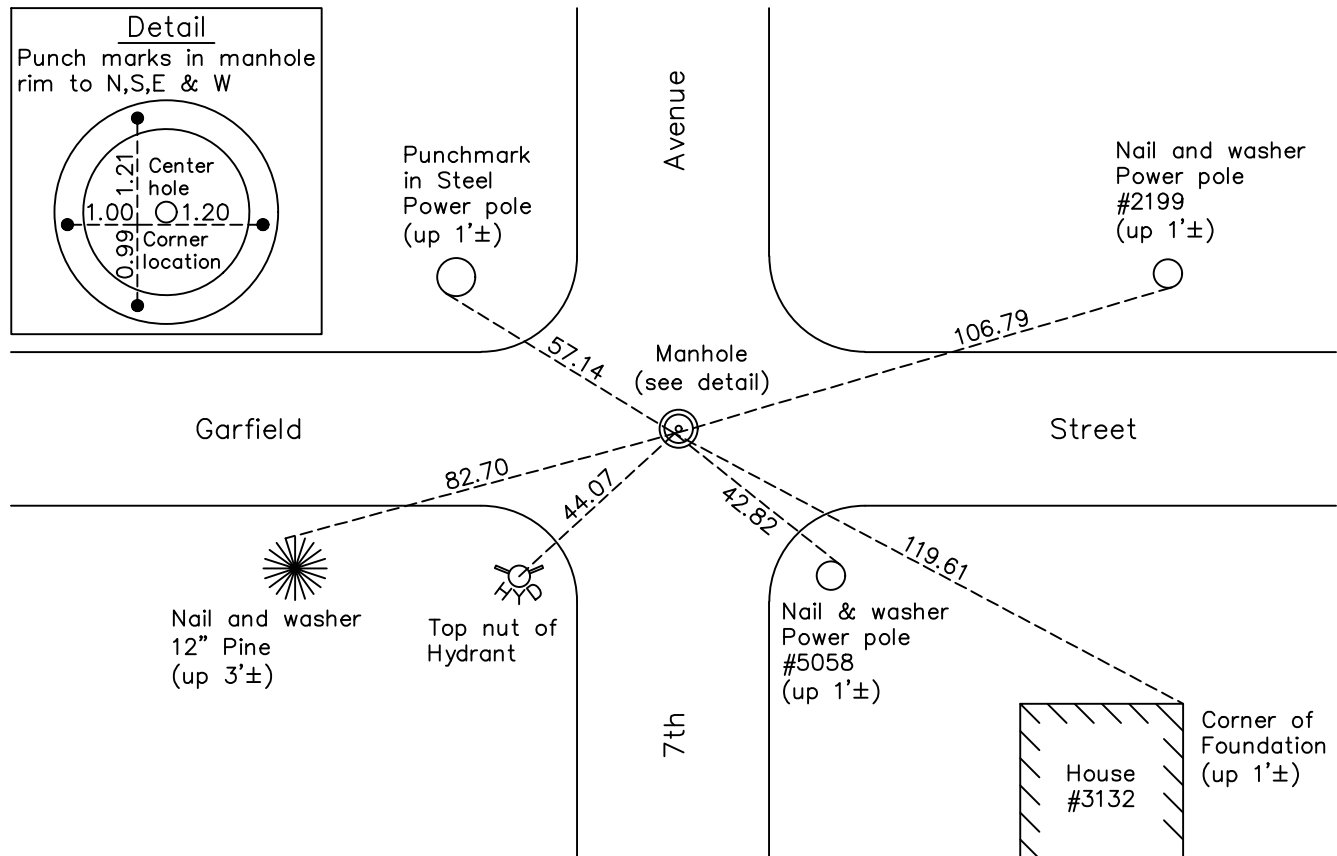

Revision Date
10/25/22

N.A.D. 1983 Coordinates
(1996 Adjustment)

County Project Coordinates	
Northing	<u>164602.6481</u>
Easting	<u>471333.2348</u>
Date	<u>11/22/00</u>

I hereby certify that this United States public land survey monument record is correct and complete to the best of my knowledge and belief.

David Zieglmeier Date 2/8/23

David Zieglmeier Anoka County Surveyor
Minnesota License Number 46179

HISTORY OF GOVERNMENT CORNER

Page No. 12

County of Anoka

State of Minnesota

North 1/4 Corner of Sec. 6 Township 31 Range 24

CORNER HISTORY:

April 10, 1943 - Cartwright found 6"X6" granite monument down 14". Established ties to monument.

May 18, 1956 - W.J. Lundstrom found granite monument and updated ties.

February 17, 1960 - Found pinched iron pipe and updated ties.

February 25, 1960 - Found 6"X6" granite monument down 14" with a 3/4" iron pipe directly over center of monument. Updated ties.

November 28, 1960 - Updated ties and removed granite monument prior to sewer construction.

July 26, 1966 - Set location of corner on manhole after construction using ties. Set P.K. nails to the North, South, East and West and filed notches in rim of manhole. Updated ties.

August 17, 1967 - Found P.K. nails North, South, East and West and found that the file notches in rim were incorrect. Updated ties.

August 6, 1970 - Found P.K. nails North, South, East and West and updated ties.

July 5, 1974 - Found P.K. nails North, South, East and West and updated ties.

June 15, 1977 - Found P.K. nails North, South, East and West and updated ties.

July 14, 1980 - Found P.K. nails North, South, East and West and updated ties.

June 16, 1986 - Found P.K. nails North, South, East and West and updated ties.

October 28, 1988 - Found P.K. nails North, South, East and West and updated ties.

August 20, 1990 - Found P.K. nails North, South, East and West and updated ties.

August 22, 1994 - Found P.K. nails North, South, East and West and updated ties.

January 2, 1998 - Found evidence corner location missing. Reset position of corner on manhole and set punch marks in rim of manhole using resurvey. Updated ties.

November 22, 2000 - Found punch marks in rim of manhole and established NAD 1983 (1996 Adjustment) Anoka County Project Coordinates by Static GPS methods. Updated ties.

March 29, 2010 - Found evidence of corner location missing. Manhole cover and rim appeared to have been replaced. Position to be remarked.

February 18, 2011 - Reestablished corner location on manhole cover and updated ties. Verified location of corner by static GPS methods.

April 6, 2015 - Found punch marks on manhole cover. Verified position by VRS GPS methods. Updated ties.

February 27, 2020 - Found punch marks on manhole cover. Verified position by VRS GPS methods. Updated ties.

HISTORY OF GOVERNMENT CORNER

Page No. 12

History Page 2

County of Anoka

State of Minnesota

North 1/4 Corner of Sec. 6 Township 31 Range 24

CORNER HISTORY:

July 15, 2022 - Found punch marks on manhole cover. Verified position by VRS GPS methods. Updated ties.