

CERTIFICATE OF LOCATION OF GOVERNMENT CORNER

County of Anoka

State of Minnesota

West 1/4 Corner of Sec. 5 Township 31 Range 24

On the 4th day of November, 1966, the described corner was evidenced by a concrete monument last found March 25, 1964 prior to road construction

and to perpetuate the location of said corner, at the exact location thereof, a permanent marker was placed consisting of a cast iron monument

AND on the 15th day of July, 2022, said permanent marker was found flush to surface and the ties were updated.

Updated reference ties are as shown below.

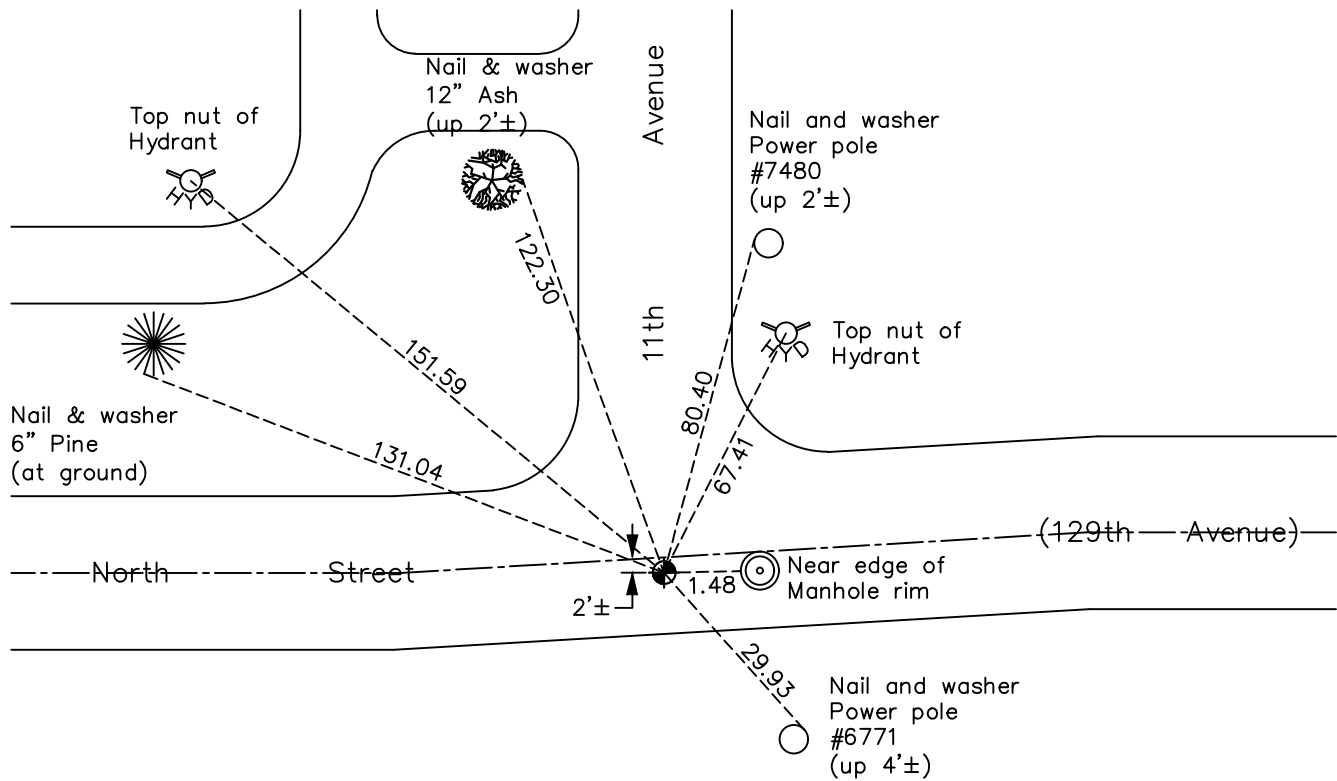

Revision Date
 10/25/22

N.A.D. 1983 Coordinates
 (1996 Adjustment)

County Project Coordinates	
Northing	161826.1733
Easting	473884.6198
Date	8/07/01

I hereby certify that this United States public land survey monument record is correct and complete to the best of my knowledge and belief.
David Zieglmeier Date 2/8/23
 David Zieglmeier Anoka County Surveyor
 Minnesota License Number 46179

HISTORY OF GOVERNMENT CORNER

Page No. 17

County of Anoka

State of Minnesota

West 1/4 Corner of Sec. 5 Township 31 Range 24

CORNER HISTORY:

April 14, 1943 - H.A. Cartwright found concrete monument flush with surface. Established ties to monument.

August 9, 1955 - C.E. Coulter found a concrete monument flush with the surface on side slope and 16.5' north of centerline. Updated ties.

February 17, 1960 - Found concrete monument flush with the surface on slope of road and updated ties.

March 25, 1964 - Set construction (transit) ties to concrete monument prior to road construction.

November 18, 1964 - Set P.K. nail after road construction using construction ties. Set P.K. nails 2.00' North and East of corner position.

November 4, 1966 - Replaced P.K. nail with a cast iron monument set flush with surface and updated ties. Monument is 4'± south of centerline.

July 23, 1970 - Found cast iron monument and updated ties.

July 2, 1974 - Found cast iron monument and updated ties. Set P.K.nails 2' North and West of monument.

June 15, 1977 - Found cast iron monument and updated ties.

June 25, 1980 - Found cast iron monument flush and updated ties.

June 16, 1986 - Found cast iron monument and updated ties.

August 21, 1990 - Found cast iron monument and updated ties.

August 18, 1994 - Found cast iron monument and updated ties.

August 7, 2001 - Found cast iron monument and established NAD 1983 (1996 Adjustment) Anoka County Project Coordinates by Static GPS methods. Updated ties.

March 17, 2010 - Found cast iron monument flush and updated ties.

April 13, 2015 - Found cast iron monument flush. Verified position by VRS GPS methods. Updated ties.

June 12, 2017 - Found cast iron monument flush, set construction ties and updated corner ties prior to nearby construction. Painted up monument but did not remove.

April 4, 2019 - Found cast iron monument and removed prior to construction.

April 21, 2020 - Set cast iron monument flush after construction using static GPS methods. Updated ties.

July 15, 2022 - Found cast iron monument flush. Verified position by VRS GPS methods. Updated ties.