

CERTIFICATE OF LOCATION OF GOVERNMENT CORNER

County of Anoka

State of Minnesota

Southwest Corner of Sec. 1 Township 31 Range 24

On the 26th day of August, 1960, the described corner was evidenced by an iron pipe

and to perpetuate the location of said corner, at the exact location thereof, a permanent marker was placed consisting of a cast iron monument

AND on the 21th day of July, 2022, said permanent marker was found flush and the ties were updated

Updated reference ties are as shown below.

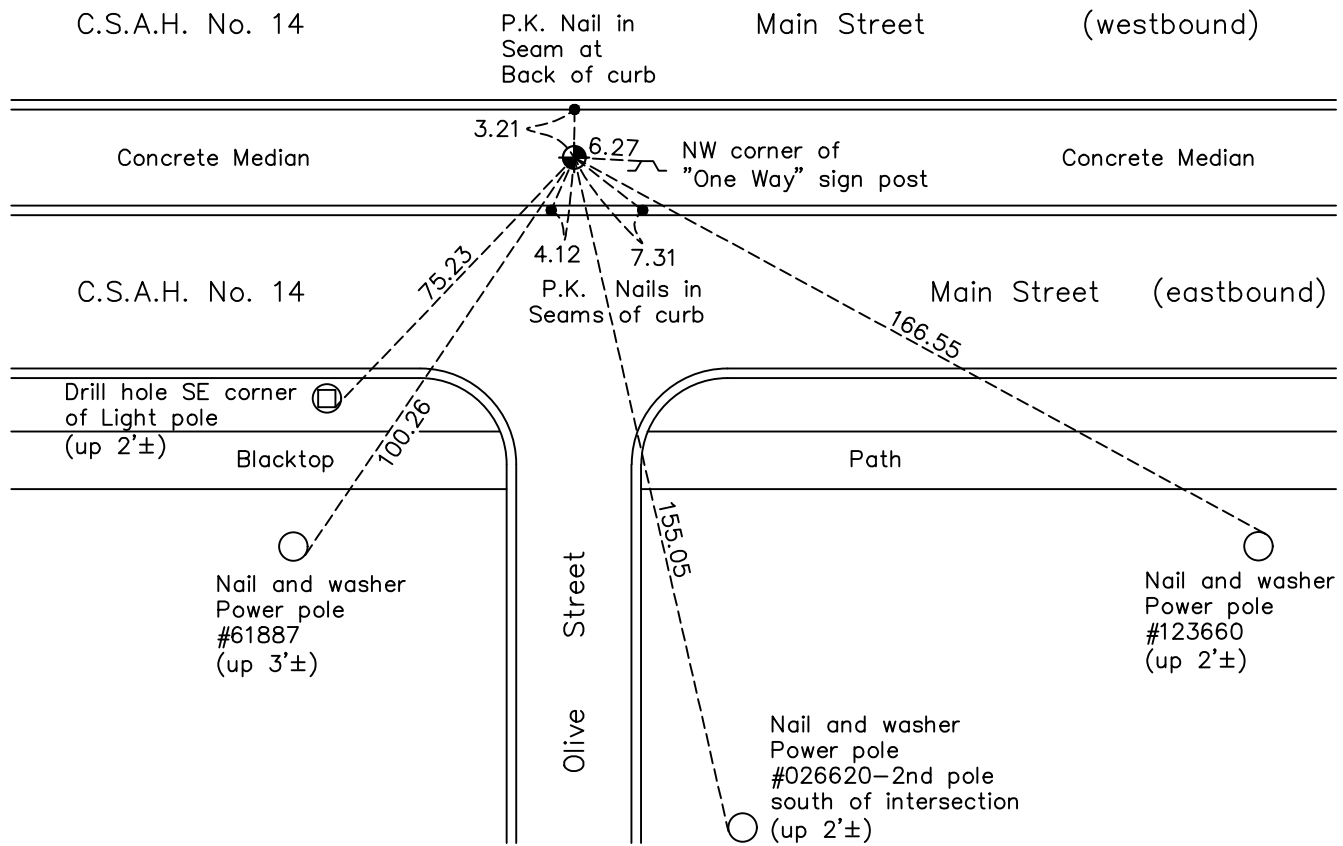

N.A.D. 1983 Coordinates
(1996 Adjustment)

County Project Coordinates	
Northing	158913.7621
Easting	494879.9780
Date	9/19/01

Revision Date
10/31/2022

I hereby certify that this United States public land survey monument record is correct and complete to the best of my knowledge and belief.

David Zieglmeier Date 2/8/23

David Zieglmeier Anoka County Surveyor
Minnesota License Number 46179

HISTORY OF GOVERNMENT CORNER

Page No. 29

County of Anoka

State of Minnesota

Southwest Corner of Sec. 1 Township 31 Range 24

CORNER HISTORY:

June 28, 1943 - H.A. Cartwright found concrete monument down 4". Established ties to monument.

July 1955 - Minder Engineering Co. found concrete monument and updated ties.

August 26, 1960 - Replaced iron pipe found with a cast iron monument set flush with surface and updated ties. Monument is 4.5'± south of road centerline.

June 26, 1964 - Found cast iron monument and updated ties.

July 11, 1966 - Found cast iron monument and updated ties.

July 21, 1970 - Found cast iron monument, raised monument 1/2" and updated ties. Monument is 4.5'± south of road centerline.

July 5, 1974 - Found cast iron monument and updated ties.

June 17, 1977 - Found cast iron monument and updated ties.

June 23, 1980 - Found cast iron monument and updated ties.

June 24, 1991 - Found cast iron monument and updated ties.

August 8, 1994 - Found cast iron monument and updated ties.

September 19, 2001 - Found cast iron monument and established NAD 1983 (1996 Adjustment) Anoka County Project Coordinates by Static GPS methods. Updated ties.

March 30, 2010 - Found cast iron monument with a P.K. nail 4.50' north on intersection of centerlines and updated ties.

June 21, 2011 - Updated ties, verified location with VRS and removed cast iron monument prior to road construction.

August 14, 2012 - Set cast iron monument flush after road construction using corner ties. Verified location of corner by Static GPS methods.

April 16, 2015 - Found cast iron monument flush. Verified position by VRS GPS methods. Updated ties.

January 15, 2020 - Found cast iron monument flush. Verified position by VRS GPS methods. Updated ties.

July 21, 2022 - Found cast iron monument flush. Verified position by VRS GPS methods. Updated ties.