

# CERTIFICATE OF LOCATION OF GOVERNMENT CORNER

County of Anoka

State of Minnesota

## Northeast Corner of Sec. 9 Township 31 Range 24

On the 26th day of September, 1962, the described corner was evidenced by a 3/4" iron pipe

and to perpetuate the location of said corner, at the exact location thereof, a permanent marker was placed consisting of a 0.5' top section of a cast iron monument set in concrete

AND on the 3rd day of August, 2022, said permanent marker was found and the ties were updated

Updated reference ties are as shown below.

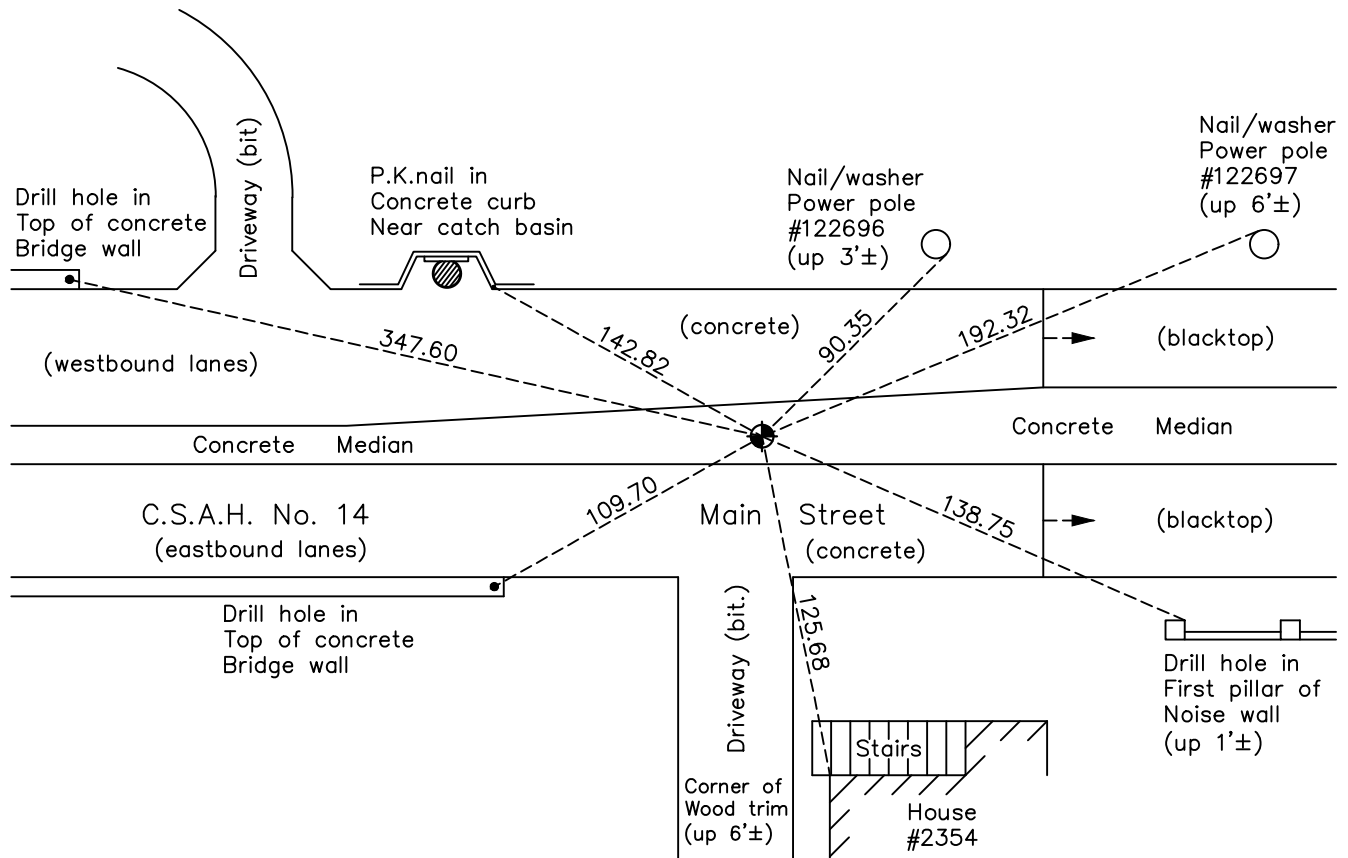

Revision Date  
 10/31/2022

N.A.D. 1983 Coordinates  
 (1996 Adjustment)

County Project Coordinates	
Northing	159193.9888
Easting	484372.5737
Date	9/26/01

I hereby certify that this United States public land survey monument record is correct and complete to the best of my knowledge and belief.  
*David Zieglmeier* Date 2/8/23  
 David Zieglmeier Anoka County Surveyor  
 Minnesota License Number 46179

# HISTORY OF GOVERNMENT CORNER

Page No. 33

County of Anoka

State of Minnesota

## Northeast Corner of Sec. 9 Township 31 Range 24

### **CORNER HISTORY:**

April 10, 1943 - H.A. Cartwright found 6" X 6" granite monument down 3" in the centerline of Main Street. Established ties to monument.

June 24, 1960 - Found pinched iron pipe down 6". Dug below iron pipe and found nothing. Replaced iron pipe in its original position.

September 26, 1962 - Swung ties from Cartwright, Hoium and Minder. Found P.K. nail straddles, then dug down and found 3/4" bent iron pipe down 0.2' which fit straddles when straightened. Also found 3/4" pinched iron pipe down 0.8' which fell 0.2' East of above described 3/4" iron pipe. Set cast iron monument at intersection of straddles and updated ties.

July 21, 1966 - Found cast iron monument and updated ties.

July 21, 1970 - Found cast iron monument and updated ties.

July 5, 1974 - Found cast iron monument and updated ties.

June 17, 1977 - Found cast iron monument and updated ties.

June 25, 1980 - Found cast iron monument and updated ties.

June 24, 1991 - Found cast iron monument and updated ties.

August 9, 1994 - Found cast iron monument and updated ties.

September 26, 2001 - Found cast iron monument and established NAD 1983 (1996 Adjustment) Anoka County Project Coordinates by Static GPS methods.

November 1, 2001 - Found cast iron monument and updated ties.

April 10, 2003 - Set construction ties (transit) prior to road construction.

December 8, 2003 - Set cast iron monument in concrete after road construction using construction ties.

March 18, 2010 - Found cast iron monument flush with surface and updated ties.

July 20, 2010 - Set construction ties (transit) prior to road construction.

August 29, 2011 - Set a 0.5' long top section of a cast iron monument in concrete after road construction using construction ties.

March 20, 2015 - Found cast iron monument. Verified position by VRS GPS methods. Updated ties.

January 22, 2020 - Found cast iron monument. Verified position by VRS GPS methods. Updated ties.

August 3, 2022 - Found cast iron monument. Verified position by VRS GPS methods. Updated ties.