

CERTIFICATE OF LOCATION OF GOVERNMENT CORNER

County of Anoka

State of Minnesota

East 1/4 Corner of Sec. 7 Township 31 Range 24

On the 11th day of August, 1960, the described corner was evidenced by a concrete monument

and to perpetuate the location of said corner, at the exact location thereof, a permanent marker was placed consisting of a cast iron monument

AND on the 12th day of May, 2023, said permanent marker was set cast iron monument after road construction, verified using RTK GPS methods. Updated ties.

Updated reference ties are as shown below.

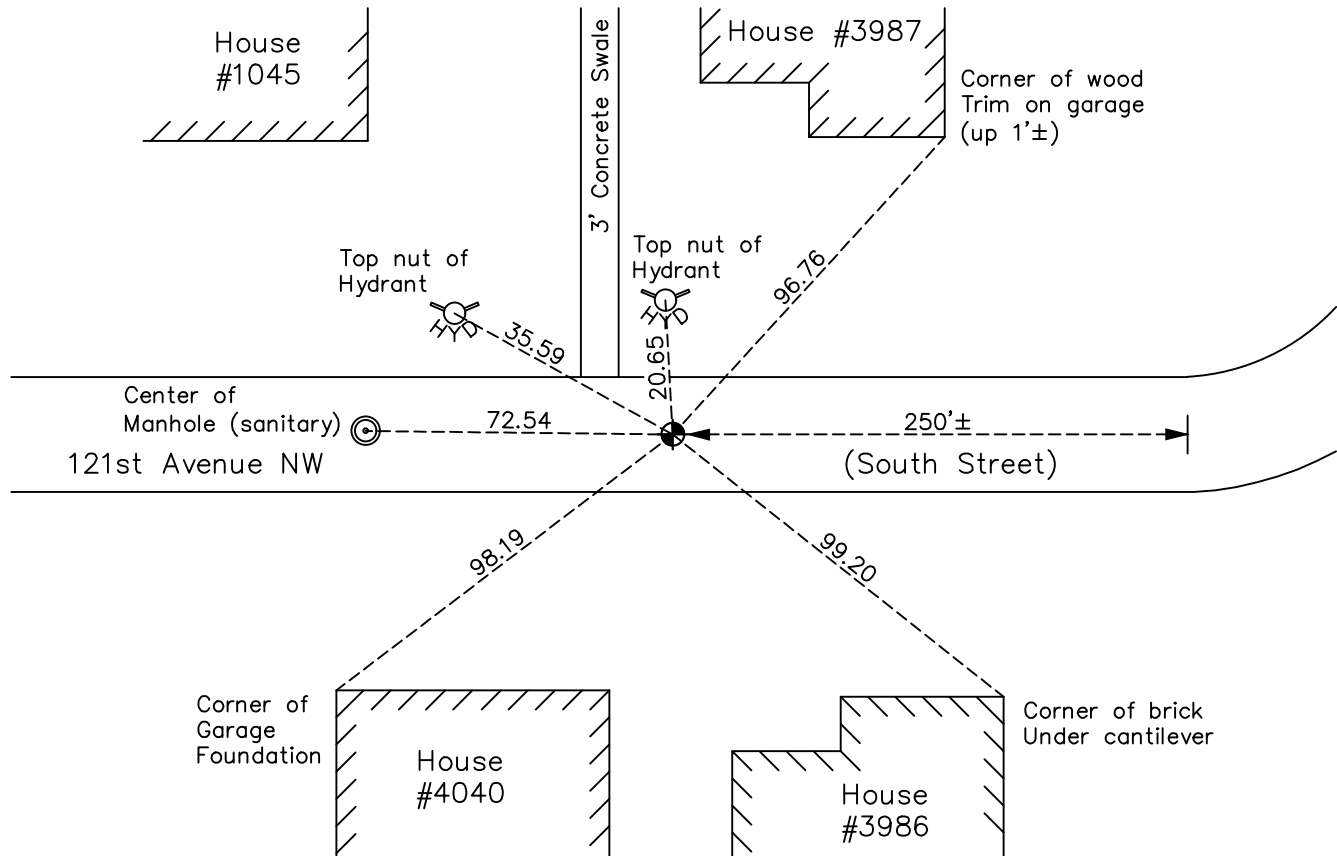

Revision Date

5/31/2023

N.A.D. 1983 Coordinates
(1996 Adjustment)

County Project Coordinates	
Northing	156526.1169
Easting	473801.2099
Date	8/14/01

I hereby certify that this United States public land survey monument record is correct and complete to the best of my knowledge and belief.

David Zieglmeier Date 12/11/23

David Zieglmeier Anoka County Surveyor
Minnesota License Number 46179

HISTORY OF GOVERNMENT CORNER

Page No. 39

County of Anoka

State of Minnesota

East 1/4 Corner of Sec. 7 Township 31 Range 24

CORNER HISTORY:

June 1, 1943 - H.A. Cartwright found concrete monument flush with surface. Established ties to monument.

August 11, 1960 - Found concrete monument flush with surface and updated ties.

September 2, 1964 - Found concrete monument flush with surface and 0.2' West of fence. Updated ties.

July 27, 1966 - Found concrete monument and updated ties.

July 23, 1970 - Found concrete monument down 0.5'± and updated ties.

7/3/74, 6/16/77, 6/30/80, 7/18/83, 6/18/86 - Found concrete monument and updated ties.

August 27, 1990 - Replaced concrete monument with a cast iron monument after road construction. Updated ties.

August 17, 1994 - Found cast iron monument and updated ties.

August 14, 2001 - Found cast iron monument and established NAD 1983 (1996 Adjustment) Anoka County Project Coordinates by Static GPS methods. Updated ties.

March 12, 2010 - Found cast iron monument and updated ties.

May, 2015- Found cast iron monument. Verified position by VRS GPS methods. Updated ties.

April 9, 2019 - Found cast iron monument. Updated corner ties. Removed monument prior to road construction.

April 21, 2020 - Reset cast iron monument flush after road construction using static GPS methods Updated ties.

May 12, 2023 - Reset cast iron monument after road construction, verified position using RTK GPS methods. Updated ties. Job no. 22-131