

CERTIFICATE OF LOCATION OF GOVERNMENT CORNER

County of Anoka

State of Minnesota

West 1/4 Corner of Sec. 16 Township 31 Range 24

On the 28th day of July, 1970, the described corner was evidenced by a 1" brass plug

and to perpetuate the location of said corner, at the exact location thereof, a permanent marker was placed consisting of a cast iron monument (partial) above concrete

AND on the 21st day of July, 2022, said permanent marker was found flush and the
ties were updated

Updated reference ties are as shown below.

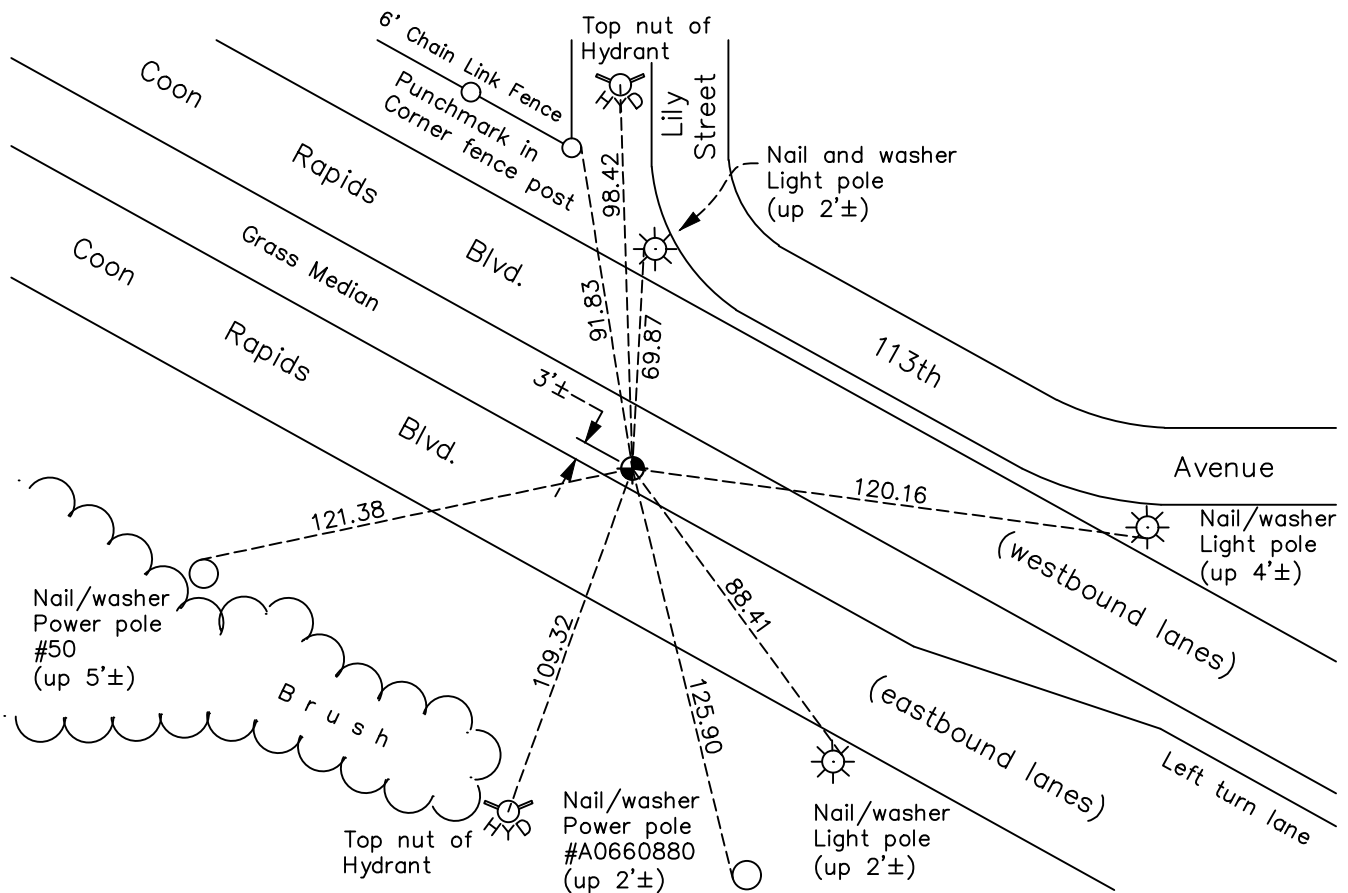

Revision Date
 12/14/2022

N.A.D. 1983 Coordinates
 (1996 Adjustment)

County Project Coordinates	
Northing	151252.4590
Easting	478959.2288
Date	8/30/01

I hereby certify that this United States public land survey monument record is correct and complete to the best of my knowledge and belief.
David Zieglmeier Date 2/28/23
 David Zieglmeier Anoka County Surveyor
 Minnesota License Number 46179

HISTORY OF GOVERNMENT CORNER

Page No. 58

County of Anoka

State of Minnesota

West 1/4 Corner of Sec. 16 Township 31 Range 24

CORNER HISTORY:

May 2, 1944 - H.A. Cartwright found 3/4" brass plug set down 0.1' in highway. Established ties to monument.

October 7, 1958 - Don Coulter found 3/4" brass plug down 0.1'. Updated ties.

August 1, 1960 - Found 1" round brass plug flush with the surface and updated ties.

July 14, 1966 - Found 1" round brass plug flush with the surface and updated ties.

July 28, 1970 - Replaced 1" round brass plug with a broken off cast iron monument set flush with the surface. Set P.K. Nails 2.00' north and east and updated ties.

July 1, 1974 - Found cast iron monument and updated ties.

June 21, 1977 - Found cast iron monument and updated ties.

July 3, 1980 - Found cast iron monument down 0.5' and retied after construction. Position verified by plats of Larson 2nd Addition, Sundquist Addition and Cardinal Heights Plat 4.

July 20, 1983 - Found cast iron monument and updated ties.

June 17, 1986 - Found cast iron monument and updated ties.

August 30, 1990 - Found cast iron monument and updated ties.

August 19, 1994 - Replaced cast iron monument with a new cast iron monument. Updated ties.

August 30, 2001 - Found cast iron monument and established NAD 1983 (1996 Adjustment) Anoka County Project Coordinates by Static GPS methods. Updated ties.

March 15, 2010 - Found cast iron monument and updated ties.

April 17, 2015 - Found cast iron monument broken. Checked position by VRS GPS methods and updated corner ties to center fin.

April 24, 2015 - Reset partial cast iron monument due to old concrete below using static GPS methods. Verified position by VRS GPS methods. Updated ties.

February 3, 2020 - Found cast iron monument flush. Verified position by VRS GPS methods. Updated ties.

July 21, 2022 - Found cast iron monument flush. Verified position by VRS GPS method. Updated ties.