

CERTIFICATE OF LOCATION OF GOVERNMENT CORNER

County of Anoka

State of Minnesota

North 1/4 Corner of Sec. 22 Township 31 Range 24

On the 13th day of July, 1970, the described corner was evidenced by a concrete monument

and to perpetuate the location of said corner, at the exact location thereof, a permanent marker was placed consisting of a cast iron monument

AND on the 8th day of July, 2022, said permanent marker was found flush and the ties were updated

Updated reference ties are as shown below.

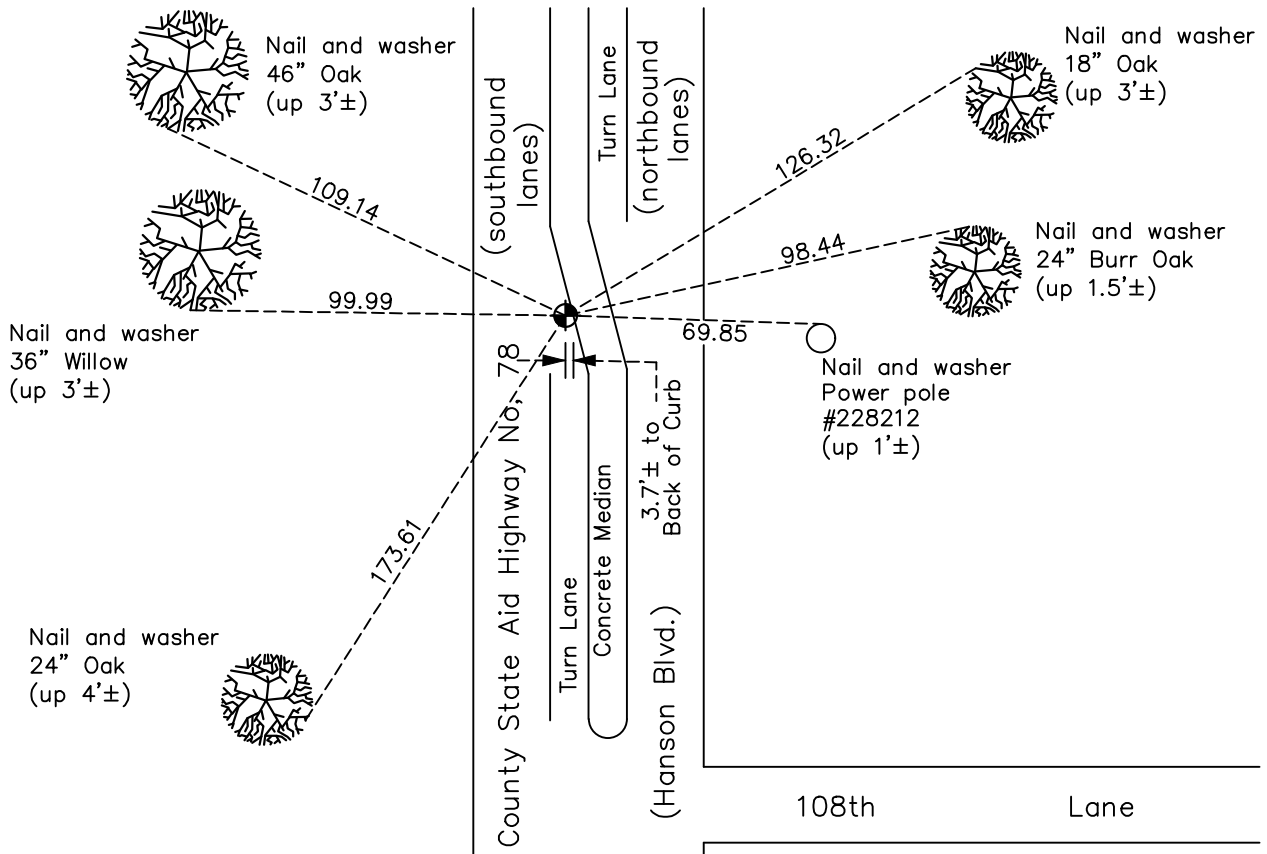

N.A.D. 1983 Coordinates
(1996 Adjustment)

County Project Coordinates	
Northing	<u>148505.8359</u>
Easting	<u>486802.9462</u>
Date	<u>8/06/01</u>

Revision Date
12/16/2022

I hereby certify that this United States public land survey monument record is correct and complete to the best of my knowledge and belief.

David Zieglmeier Date 2/28/23

David Zieglmeier Anoka County Surveyor
Minnesota License Number 46179

HISTORY OF GOVERNMENT CORNER

Page No. 69

County of Anoka

State of Minnesota

North 1/4 Corner of Sec. 22 Township 31 Range 24

CORNER HISTORY:

November 9, 1944 - H.A. Cartwright found concrete monument set down 0.5'. Established ties to monument.

July 28, 1960 - Found concrete monument down 1' with an open end iron pipe set over center of monument. Updated ties.

June 17, 1964 - Found concrete monument and updated ties.

July 13, 1966 - Found concrete monument and updated ties.

August 1, 1968 - Found concrete monument and updated ties prior to road construction.

July 2, 1970 - Set P.K. nail in corner location and set P.K.nails 2.00' north and east.

July 13, 1970 - Set cast iron monument flush with the surface after road construction and updated ties.

July 16, 1974 - Found cast iron monument and updated ties.

June 22, 1977 - Found cast iron monument and updated ties.

July 1, 1980 - Found cast iron monument and updated ties.

June 17, 1986 - Found cast iron monument and updated ties.

August 16, 1994 - Found cast iron monument and updated ties.

March 15, 2000 - Set construction ties and removed cast iron monument prior to road construction.

August 6, 2001 - Found cast iron monument (date reset unknown)and established NAD 1983 (1996 Adjustment) Anoka County Project Coordinates by Static GPS methods. Updated ties.

March 29, 2010 - Found cast iron monument and updated ties.

May 4, 2015 - Found cast iron monument and updated ties.

July 31, 2020 - Reset cast iron monument, set flush to surface, after road construction using static GPS methods. Verified position using VRS GPS and updated ties.

July 8, 2022 - Found cast iron monument flush, verified position by VRS GPS method and updated ties.