

CERTIFICATE OF LOCATION OF GOVERNMENT CORNER

County of Anoka

State of Minnesota

Northwest Corner of Sec. 22 Township 31 Range 24

On the 31st day of July, 1969, the described corner was evidenced by a concrete monument

and to perpetuate the location of said corner, at the exact location thereof, a permanent marker was placed consisting of a cast iron monument

AND on the 29th day of June, 2022, said permanent marker was found flush and the ties were updated

Updated reference ties are as shown below.

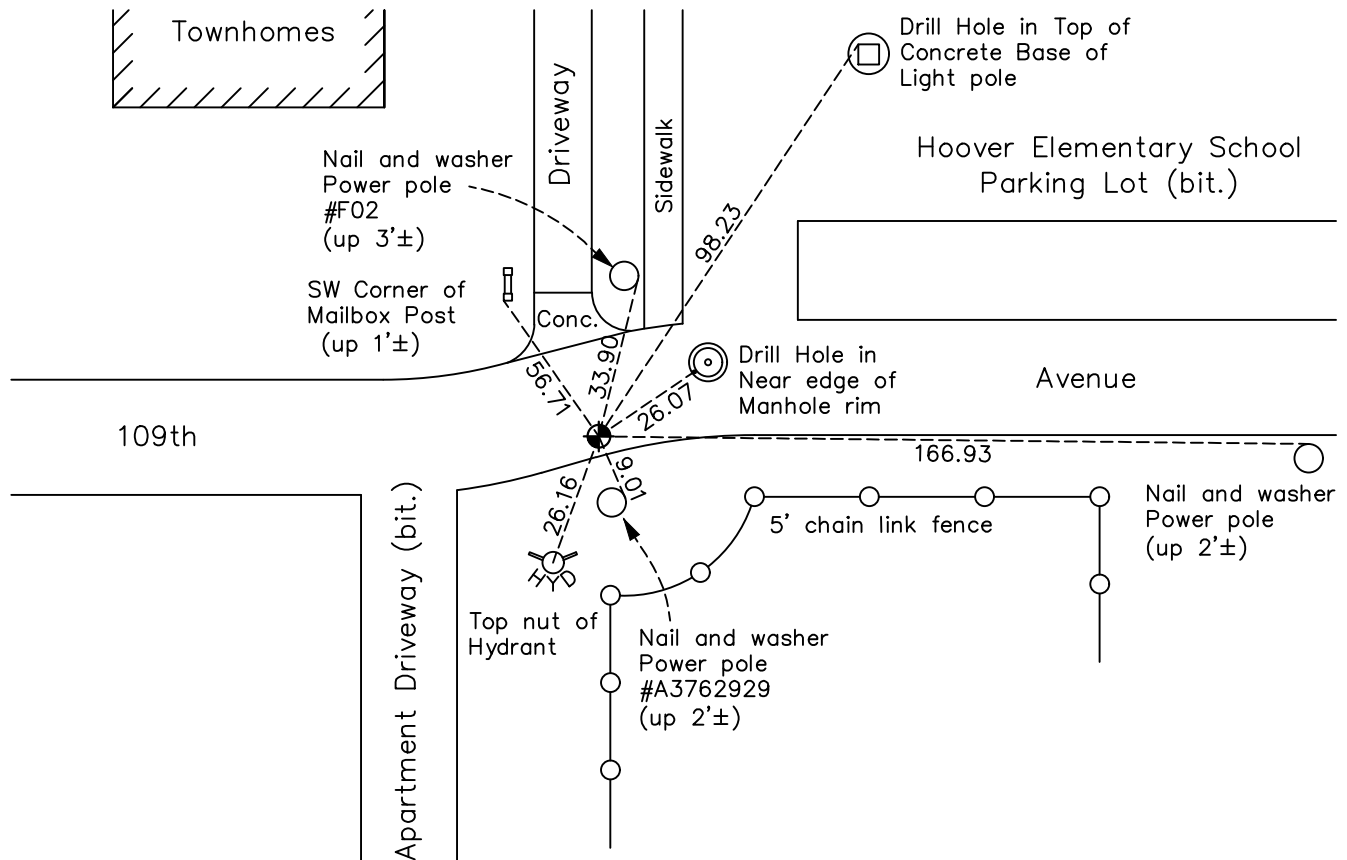

Revision Date
12/16/2022

N.A.D. 1983 Coordinates
 (1996 Adjustment)

County Project Coordinates	
Northing	148591.7333
Easting	484137.5277
Date	8/14/01

I hereby certify that this United States public land survey monument record is correct and complete to the best of my knowledge and belief.

David Zieglmeier Date 2/28/23

David Zieglmeier Anoka County Surveyor
 Minnesota License Number 46179

HISTORY OF GOVERNMENT CORNER

Page No. 70

County of Anoka

State of Minnesota

Northwest Corner of Sec. 22 Township 31 Range 24

CORNER HISTORY:

May 20, 1944 - H.A. Cartwright found monument (type unknown). Established ties to monument.

July 28, 1960 - Found concrete monument set down 0.3'. Set an open end iron pipe on north side flush with monument and updated ties.

June 5, 1964 - Found concrete monument and updated ties.

July 13, 1966 - Found concrete monument and updated ties.

July 31, 1969 - Set cast iron monument flush with the surface using area platting and set P.K. nails 2.00' north and east. Updated ties.

July 16, 1974 - Found cast iron monument and updated ties.

June 23, 1977 - Found cast iron monument and updated ties.

July 1, 1980 - Found cast iron monument and updated ties.

July 18, 1983 - Found cast iron monument and updated ties.

June 19, 1986 - Found cast iron monument and updated ties.

August 14, 1990 - Found cast iron monument and updated ties.

August 12, 1994 - Found cast iron monument and updated ties.

August 14, 2001 - Found cast iron monument and established NAD 1983 (1996 Adjustment) Anoka County Project Coordinates by Static GPS methods. Updated ties.

May 23, 2002 - Set construction ties and removed cast iron monument prior to road construction.

October 21, 2002 - Set cast iron monument after road construction using construction ties. Verified location of corner by Static GPS methods.

March 10, 2010 - Found cast iron monument and updated ties.

April 29, 2015 - Found cast iron monument. Verified position by VRS GPS methods. Updated ties.

January 31, 2020 - Found cast iron monument. Verified position by VRS GPS methods. Updated ties.

June 29, 2022 - Found cast iron monument flush. Verified position by VRS GPS method. Updated ties.