

CERTIFICATE OF LOCATION OF GOVERNMENT CORNER

County of Anoka

State of Minnesota

Witness Corner of Sec. 28 Township 31 Range 24
(on east line of section)

On the 19th day of June, 1975, the described corner was evidenced by a stone
monument

and to perpetuate the location of said corner, at the exact location thereof, a permanent marker was placed consisting of a cast iron monument on top of the stone monument with a sign and post 0.6'± north of monument facing north

AND on the 10th day of January, 2023, said permanent marker was found down 0.5'±,
coordinates were updated using RTK GPS method and the ties were updated

Updated reference ties are as shown below.

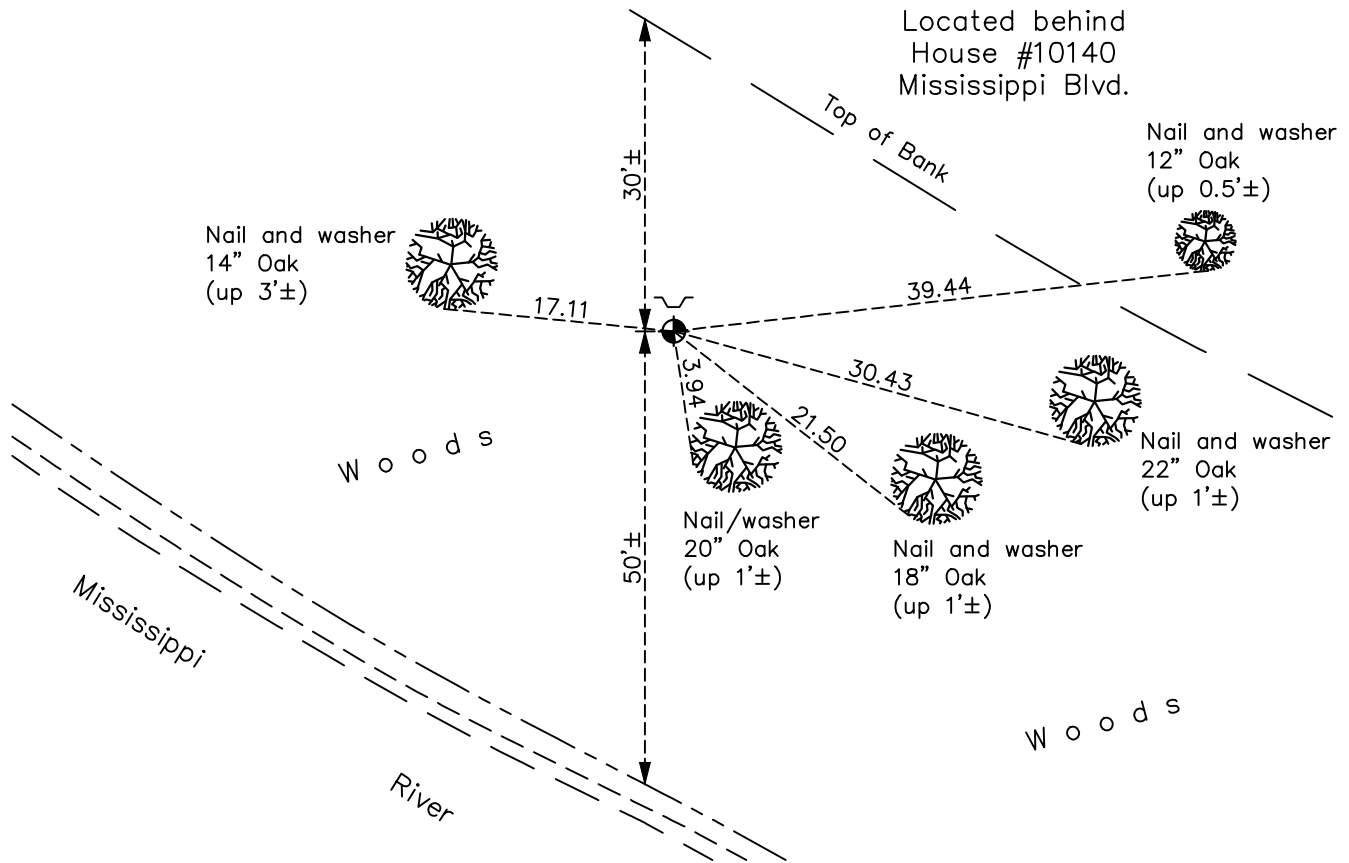

Revision Date
1/11/2023

N.A.D. 1983 Coordinates
(2011 Adjustment)

County Project Coordinates	
Northing	<u>143168.783</u>
Easting	<u>484050.773</u>
Date	<u>01/10/2023</u>

I hereby certify that this United States public land survey monument record is correct and complete to the best of my knowledge and belief.

David Zieglmeier Date 2/28/23

David Zieglmeier Anoka County Surveyor
Minnesota License Number 46179

HISTORY OF GOVERNMENT CORNER

Page No. 85

County of Anoka

State of Minnesota

Witness Corner of Sec. 28 Township 31 Range 24
(on east line of section)

CORNER HISTORY:

June 19, 1975 - Set cast iron monument over stone monument found per testimony of resident to west (Mrs. Locken). Resident to east was Northern States Power Company, now Hennepin County. Set sign and post 1'± north of monument and updated ties.

June 24, 1977 - Found cast iron monument and updated ties.

July 9, 1980 - Found cast iron monument and updated ties.

July 26, 1983 - Found cast iron monument and updated ties.

June 23, 1986 - Found cast iron monument and updated ties.

May 2, 1991 - Found cast iron monument and updated ties.

August 24, 1994 - Found cast iron monument and updated ties.

October 31, 2001 - Found cast iron monument and established NAD 1983 (1996 Adjustment) Anoka County Project Coordinates by Static GPS methods. Updated ties.

March 2010 - Found cast iron monument down 0.5'± with a sign and post 0.6' north. Updated ties.

June 12, 2015 - Found cast iron monument down 0.5'± with a sign and post 0.6' north. Updated ties.

January 30, 2020 - Found cast iron monument down 0.5'± with a sign and post 0.6' north. Updated ties.

July 27, 2022 - Found cast iron monument down 0.5'± with a sign and post 0.6' north. Updated ties.

January 10, 2023 - Found CIM, position verified by RTK GPS and the ties were reviewed and updated. Position requires updated coordinates. Old Coordinates NAD 1983 (1996 adj) Northing 143168.7225; Easting 484051.0206