

CERTIFICATE OF LOCATION OF GOVERNMENT CORNER

County of Anoka

State of Minnesota

MEANDER #14

WEST LINE Corner of Sec. 17 Township 31 Range 24

I hereby certify that on the 18th day of JULY, 1960, I found the described corner which was evidenced by BROKEN CONCRETE

and I further certify that to perpetuate the location of said corner, I did, at the exact location thereof, place a permanent marker consisting of CAST IRON MONUMENT

which reference or witness monuments are located in the manner following:

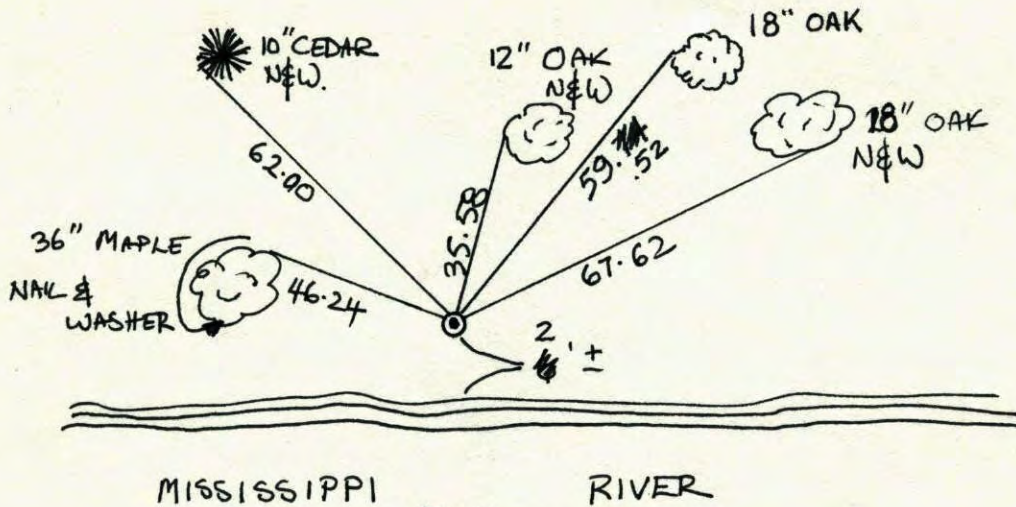

N.A.D.	1983	Co-ordinates
County	Project	Co-ordinates
Northing	<u>152056.4390</u>	
Easting	<u>473771.4716</u>	
State Plane Co-ordinates		
Y	_____	
X	_____	
Date	_____	

Revised date	Revised date	Revised date
7-26-83		
6-19-86		
8-29-90		
8-23-94		
10-11-01		

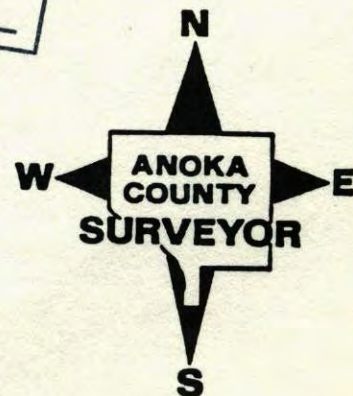



MEANDER #14
WEST LINE

SEC. 17 TW. 31 R. 24

RETIE CAST IRON MONUMENT

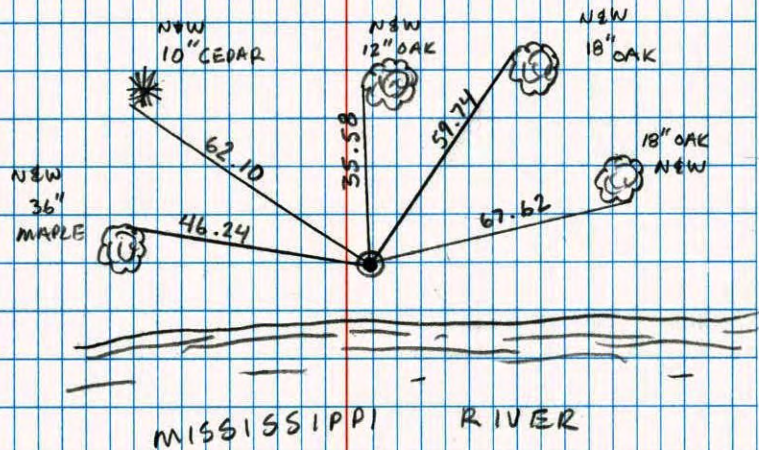
HOUSE # 3990
114TH LANE





 JOSH & JAYME ANDERSON
 8-23-94

NO. 448

NATIONAL PRINTFAST

Meander Corner #14 West Line Sec. 17 T31 R24

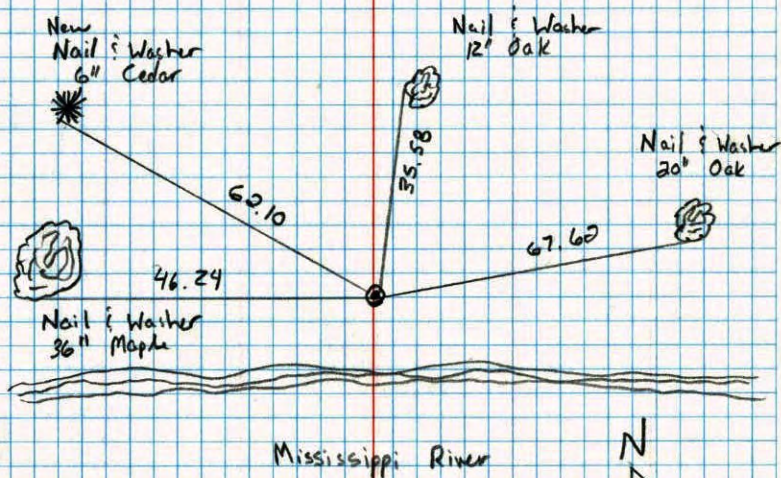
Retied Cast Iron Monument



Mississippi River

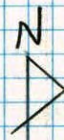

 8-29-90
 M. Zimmerman
 C. Larsen

NO. 448

FIELDONE

M.C. On West Line Of SW $\frac{1}{4}$ Sec. 17-
T31-R24

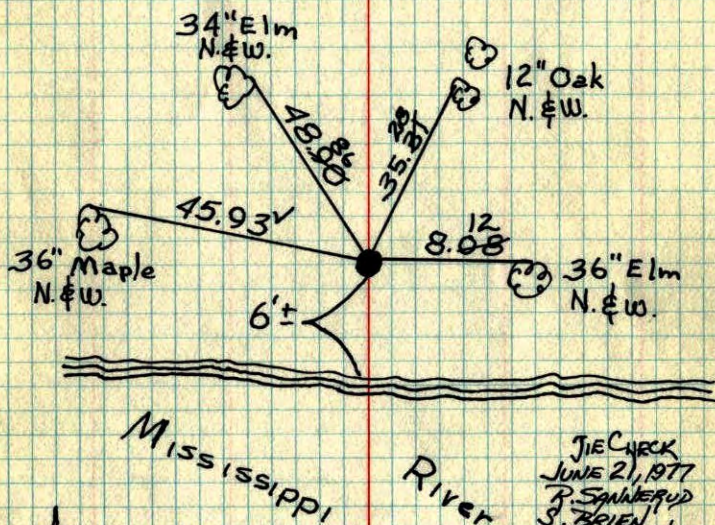
Moved Cast Iron Mon. N. 6.00' Original Was
Sliding Into River C.I. Flush



7-24-1974

H. Larson
J. Boettcher
G. Adams

Temp. 70°
Tape #14

JIE CURCK
JUNE 21, 1977
P. SANNEFUD
S. BRIEN
J. STEPHENS

ROLAND W. ANDERSON
COUNTY SURVEYOR
ANOKA COUNTY, MINNESOTA

TEMPERATURE CORRECTED
AND HORIZONTALLY
TAPED MEASUREMENTS

M.C. on West Line of SW $\frac{1}{4}$ Sec. 17
T31 R24

Moved ~~west~~ cast iron mon. north 6.00'
orig. was sliding into river.

C.I. Flush

70° 7-24-74

H. Larson
J. Boettcher
G. Adams

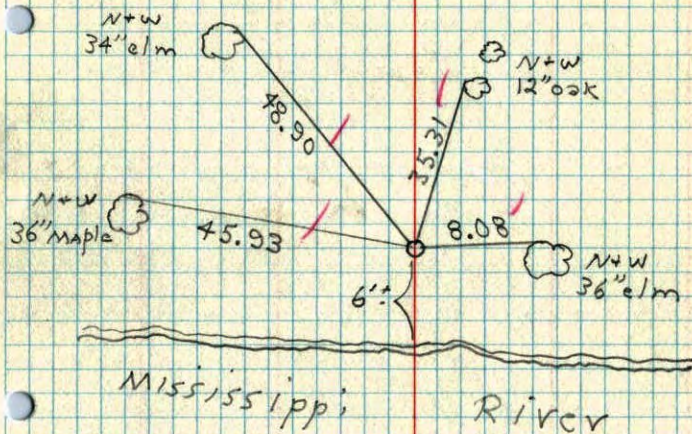

MC # 14 on W. Line - Sec 17 - T 31 - R 24

Conc. Mon. broken off
Iron on North side flush
Mon. flush leaning to East
Replaced broken Concrete Mon. with Cast
Iron Monument flush. July 28, 1970
D. Powell
R. Brien
B. Olson

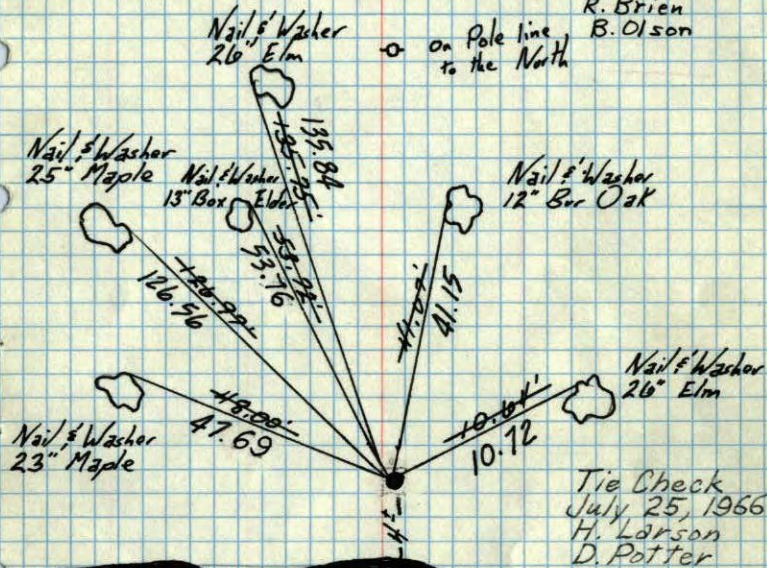

TEMPERATURE CORRECTED
AND HORIZONTALLY
TAPED MEASUREMENTS

Retie 9/2/64
M. D. Anderson
J. Dunlop

ROLAND W. ANDERSON
COUNTY SURVEYOR
ANOKA COUNTY, MINNESOTA

Temp 80°
7/14/60
D. Potter
R. Robinson

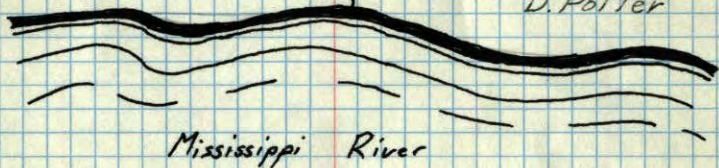

MC # 14 on W. Line - Sec 17 - T 31 - R 24

Conc. Mon. broken off
Iron on North side flush
Mon. flush leaning to East
Replaced broken conc. with C.I. Mon.
flush. up 0.2' 7/28/70
D. Powell
R. Brien
B. Olson

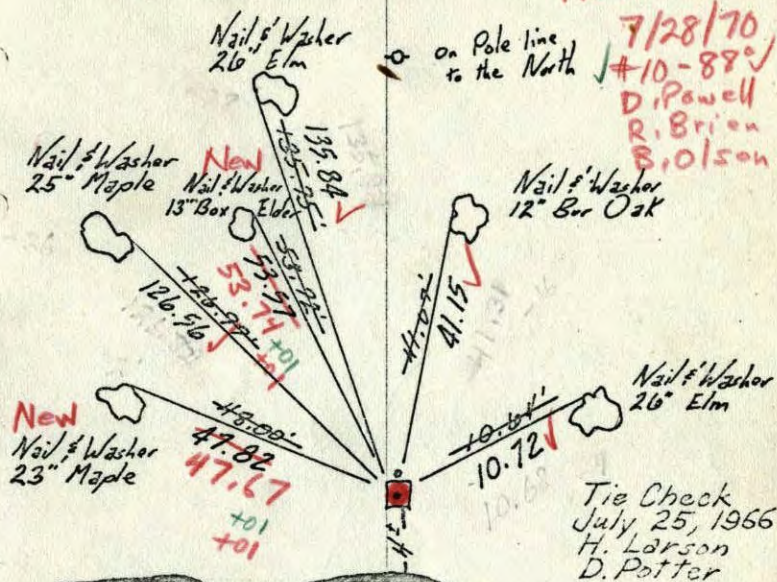

TEMPERATURE CORRECTED
AND HORIZONTALLY
TAPED MEASUREMENTS

Retie 9/2/64
M. D. Anderson
J. Dunlop

ROLAND W. ANDERSON
COUNTY SURVEYOR
ANOKA COUNTY, MINNESOTA

Temp 80°
7/14/60
D. Potter
R. Robinson

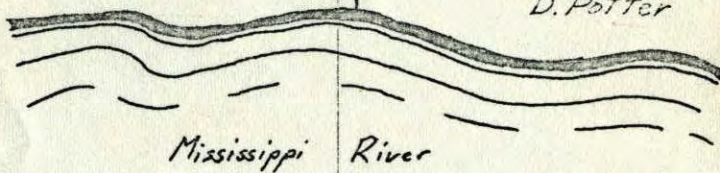

out
 48134.1 MC # 14 on W. Line
 7/19/60 Sec 17, T31, R24
 80° Conc. Man. broken, off
 Iron on North side
 flush
 Conc. Man. flush &
 leaning to East

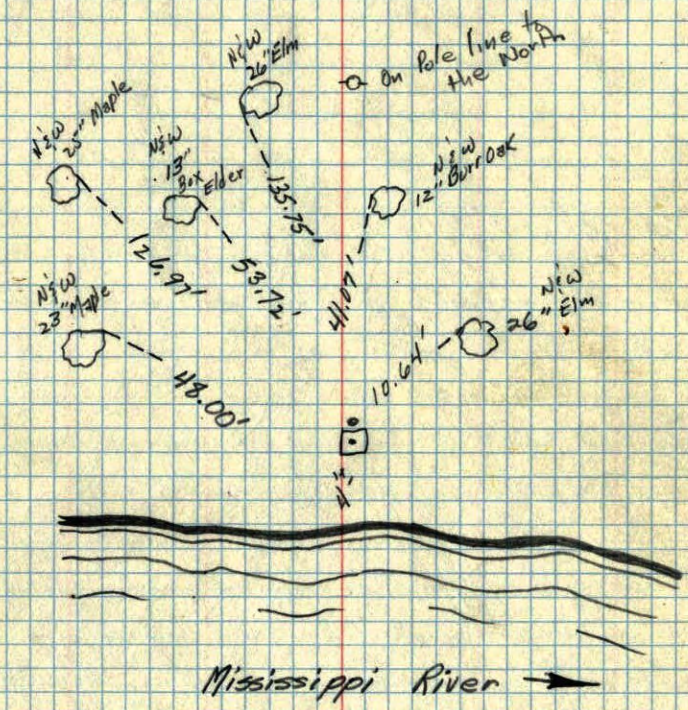

8/15/60

M.C # 14 at W. line of sec 17, T31, R2A
 2" x 4" Sandstone

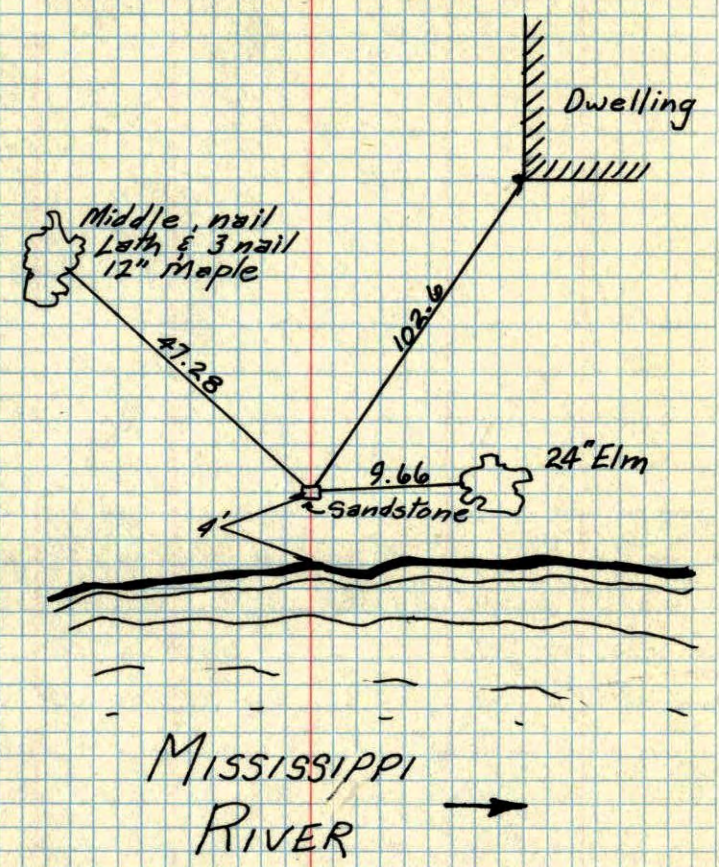

8/19/59
 C.H. Parker

M.C. on West line of Sec. 17 T. 31 R. 24
 Concrete Monument up. 0.1

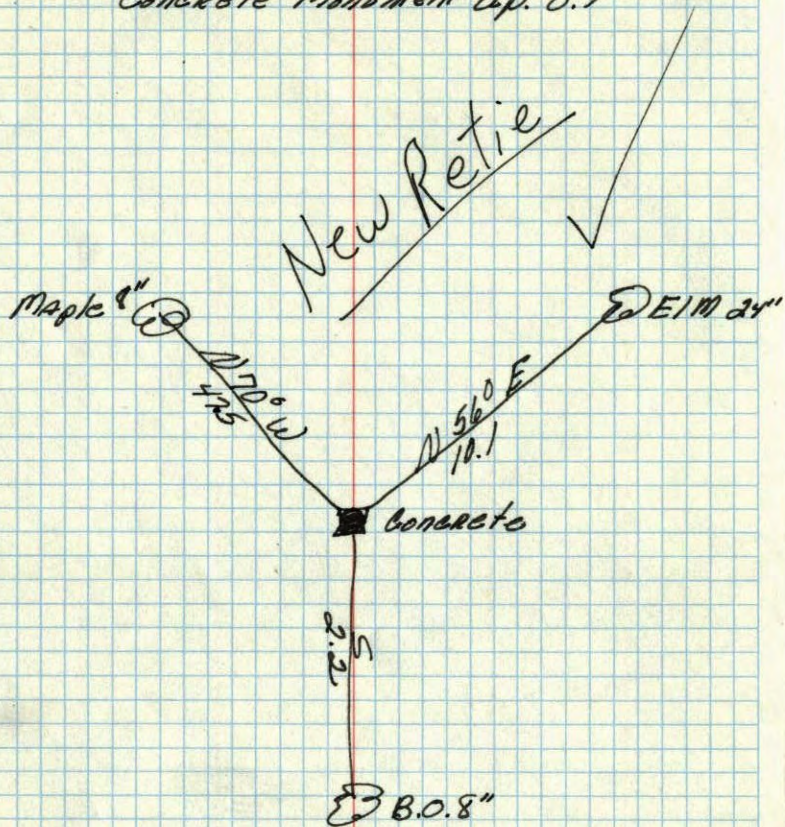

Oct. 9, 1944
 Cactwright

