

CERTIFICATE OF LOCATION OF GOVERNMENT CORNER

County of Anoka

State of Minnesota

South 1/4 Corner of Sec. 18 Township 33 Range 23

On the 28th day of April, 1972, the described corner was evidenced by area resurvey

and to perpetuate the location of said corner, at the exact location thereof, a permanent marker was placed consisting of a cast iron monument with a sign and post on the north side

AND on the 20th day of October, 2021, said permanent marker was found down 0.1'± and the ties were updated

Updated reference ties are as shown below.

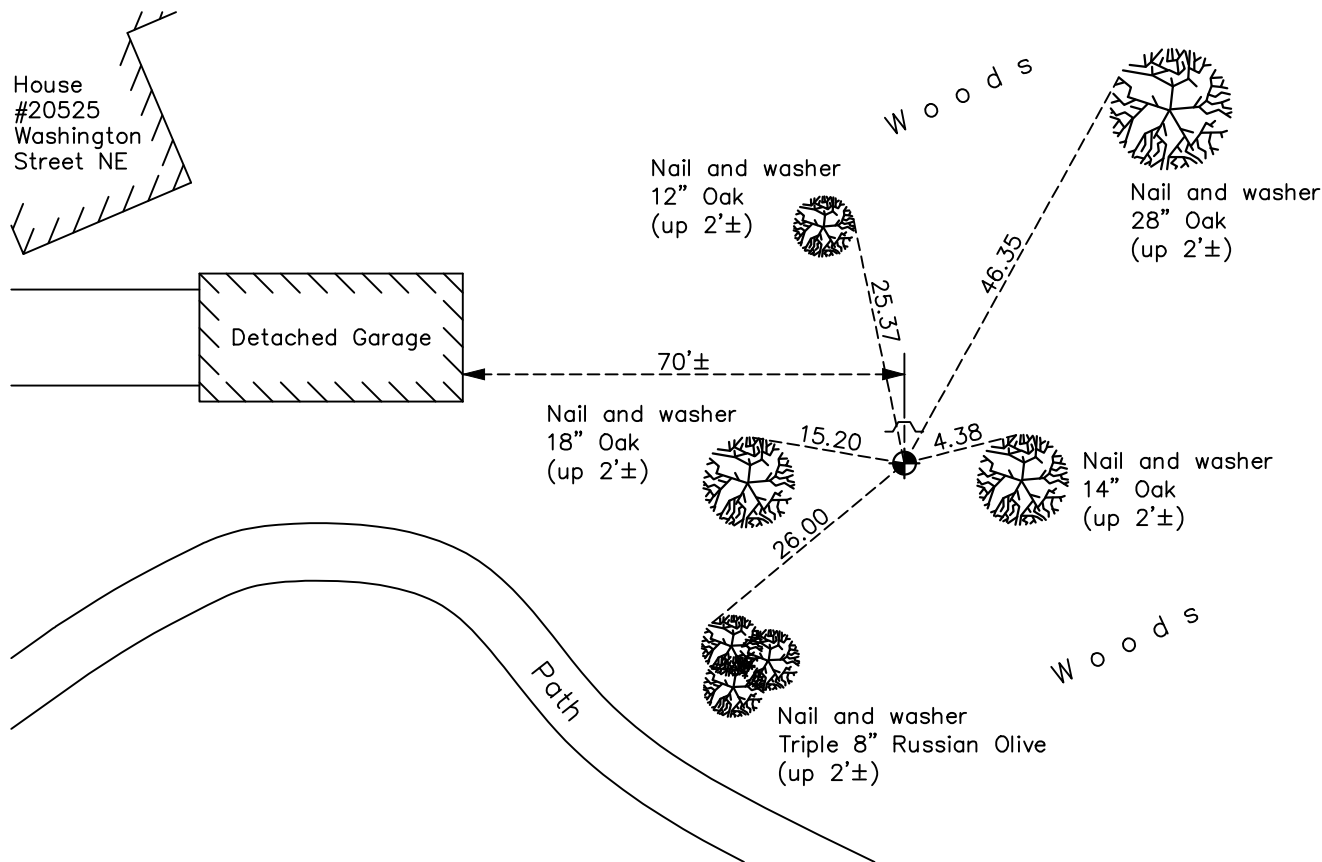

Revision Date
01/10/2022

N.A.D. 1983 Coordinates
 (1996 Adjustment)

County Project Coordinates	
Northing	<u>211691.8898</u>
Easting	<u>502373.2832</u>
Date	<u>3/25/03</u>

I hereby certify that this United States public land survey monument record is correct and complete to the best of my knowledge and belief.
David Zieglmeier Date 2/1/23
 David Zieglmeier Anoka County Surveyor
 Minnesota License Number 46179

HISTORY OF GOVERNMENT CORNER

Page No. 67

County of Anoka

State of Minnesota

South 1/4 Corner of Sec. 18 Township 33 Range 23

CORNER HISTORY:

April 28, 1972 - Set cast iron monument using area resurvey and established ties to monument.

August 6, 1974 - Found cast iron monument and updated ties.

July 11, 1977 - Found cast iron monument and updated ties.

June 15, 1981 - Found cast iron monument and updated ties.

June 19, 1984 - Found cast iron monument and updated ties.

June 11, 1987 - Found cast iron monument and updated ties.

August 12, 1992 - Found cast iron monument and updated ties.

March 25, 2003 - Found cast iron monument and updated ties. Established NAD 1983 (1996 adj.) Anoka County project coordinates by static GPS methods.

January 15, 2013 - Found cast iron monument and updated ties.

April 23, 2018 - Found cast iron monument down 0.1'± and updated ties.

October 20, 2021 - Found cast iron monument down 0.1'±, verified position by VRS GPS and updated ties.