

# CERTIFICATE OF LOCATION OF GOVERNMENT CORNER

County of Anoka

State of Minnesota

## North 1/4 Corner of Sec. 27 Township 34 Range 23

On the 16th day of December, 1976, the described corner was evidenced by area resurvey

and to perpetuate the location of said corner, at the exact location thereof, a permanent marker was placed consisting of a cast iron monument

AND on the 14th day of June, 2023, said permanent marker was found flush with a sign and post on the north side and the ties were updated

Updated reference ties are as shown below.

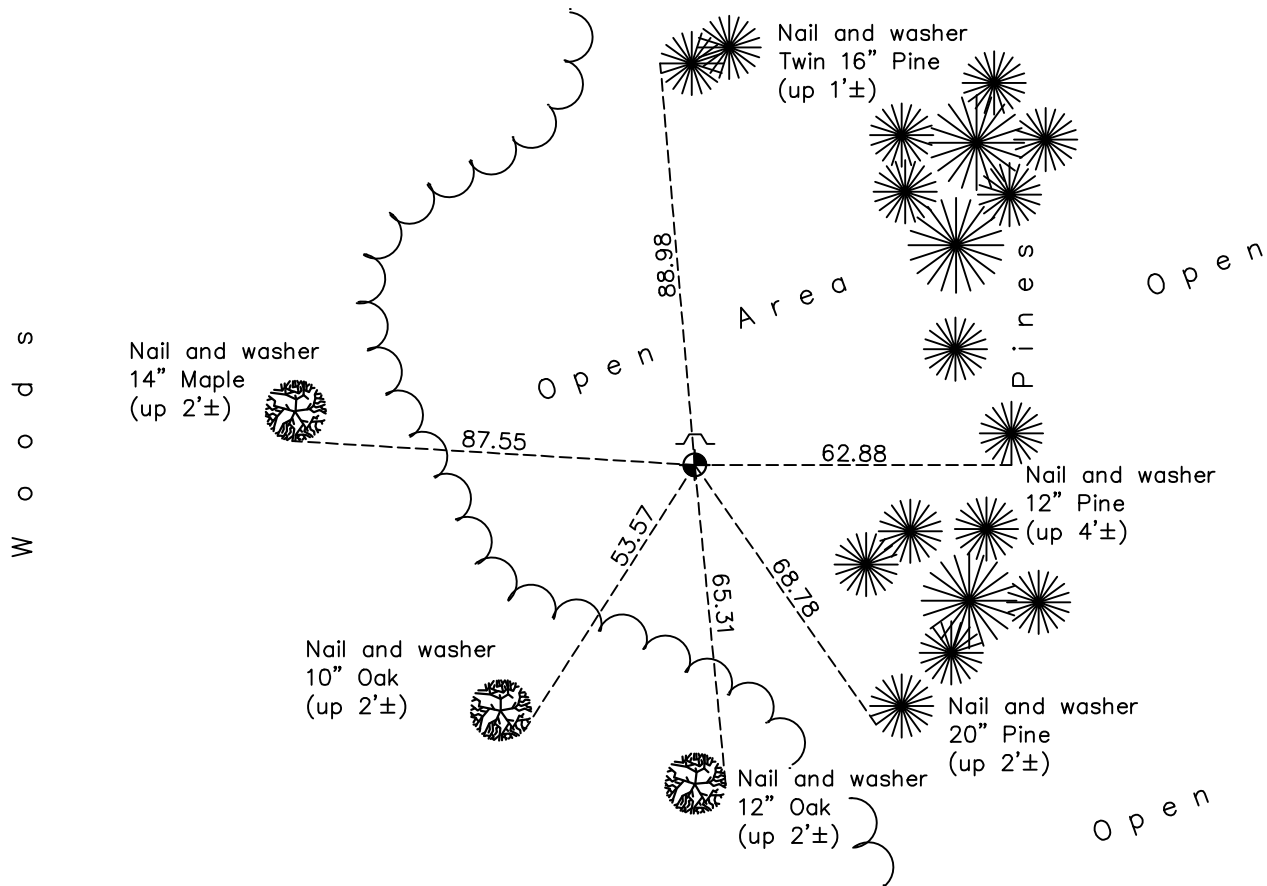

Revision Date  
 6/21/2023

N.A.D. 1983 Coordinates  
 (1996 Adjustment)

County Project Coordinates	
Northing	<u>238177.5884</u>
Easting	<u>518699.5976</u>
Date	<u>4/03/03</u>

I hereby certify that this United States public land survey monument record is correct and complete to the best of my knowledge and belief.

*David Zieglmeier* Date 12/11/23

David M. Zieglmeier, Anoka County Surveyor  
 Minnesota License Number 46179

# HISTORY OF GOVERNMENT CORNER

Page No. 56

County of Anoka

State of Minnesota

North 1/4 Corner of Sec. 27 Township 34 Range 23

## **CORNER HISTORY:**

December 16, 1976 - Set cast iron monument flush using area resurvey and established ties to monument.

August 15, 1978 - Found cast iron monument and updated ties.

June 15, 1982 - Found cast iron monument and updated ties.

March 31, 1988 - Found cast iron monument and updated ties.

September 14, 1992 - Found cast iron monument and updated ties.

April 3, 2003 - Established NAD 1983 (1996 adj.) Anoka County project coordinates by static GPS methods.

December 26, 2012 - Found cast iron monument. Verified position by VRS GPS methods. Updated ties.

May 16, 2019 - Found cast iron monument. Verified position by VRS GPS methods. Updated ties.

December 3, 2021 - Found cast iron monument flush to surface. Verified position by VRS GPS methods.  
Updated ties.

June 14, 2023 - Found cast iron monument flush to surface, verified position by ACS RTK and updated ties.