

CERTIFICATE OF LOCATION OF GOVERNMENT CORNER

County of Anoka

State of Minnesota

North 1/4 Corner of Sec. 28 Township 34 Range 23

On the 3rd day of May, 1977, the described corner was evidenced by area resurvey

and to perpetuate the location of said corner, at the exact location thereof, a permanent marker was placed consisting of a red and white iron pipe with a sign attached (facing south)

AND on the 7th day of March, 2023, said permanent marker was adjusted current monument to published coordinates w/ ACS RTK, lowered to 1'± above surface and updated ties after adjustment

Updated reference ties are as shown below.

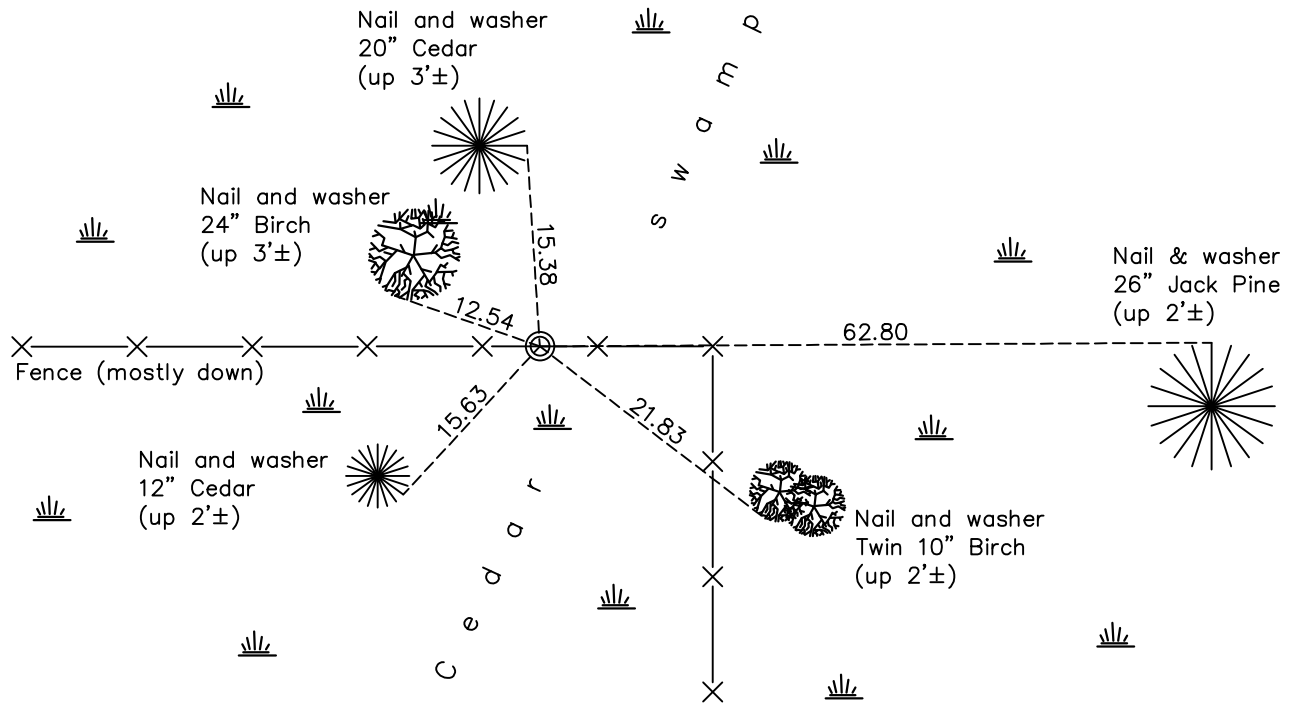

Revision Date

3/27/2023

N.A.D. 1983 Coordinates
(1996 Adjustment)

| County Project Coordinates | |
|----------------------------|-------------|
| Northing | 238155.7422 |
| Easting | 513425.5155 |
| Date | 4/14/03 |

I hereby certify that this United States public land survey monument record is correct and complete to the best of my knowledge and belief.

David Zieglermeier Date 12/11/23

David M. Zieglermeier, Anoka County Surveyor
Minnesota License Number 46179

HISTORY OF GOVERNMENT CORNER

Page No. 58

County of Anoka

State of Minnesota

North 1/4 Corner of Sec. 28 Township 34 Range 23

CORNER HISTORY:

May 3, 1977 - Set red and white iron pipe using area resurvey and established ties to monument.

September 11, 1992 - Found red and white iron pipe and updated ties.

April 14, 2003 - Established NAD 1983 (1996 adj.) Anoka County project coordinates by static GPS methods.

November 1, 2012 - Found red and white iron pipe and updated ties.

November 17, 2021 - Found red and white iron pipe up 3'±, Verified position by VRS GPS methods. Updated ties

March 7, 2023 - Adjusted current monuemnt to published coordinates and lowered to 1'± above surface, Verified position after adjustment by ACS RTK GPS method and updated the ties.