

CERTIFICATE OF LOCATION OF GOVERNMENT CORNER

County of Anoka

State of Minnesota

Witness Corner of Sec. 35 Township 34 Range 23
(on north line of section)

On the 9th day of December, 1976, the described corner was evidenced by a 1" iron pipe

and to perpetuate the location of said corner, at the exact location thereof, a permanent marker was placed consisting of a cast iron monument with a sign and post on the north side

AND on the 5th day of November, 2021, said permanent marker was found and the ties
were updated

Updated reference ties are as shown below.

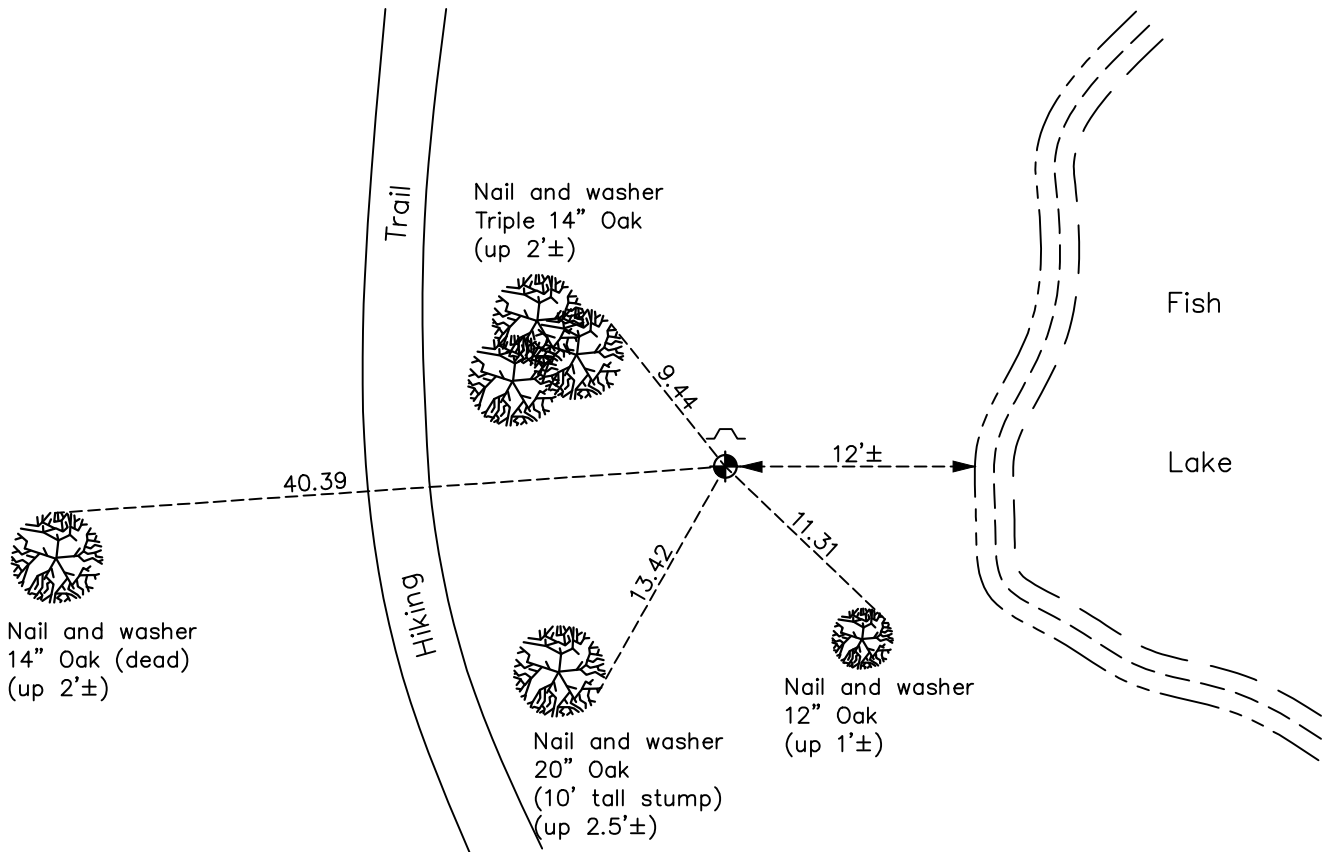

Revision Date
3/30/2022

N.A.D. 1983 Coordinates
 (1996 Adjustment)

| County Project Coordinates | |
|----------------------------|--------------------|
| Northing | <u>232870.6989</u> |
| Easting | <u>523671.8758</u> |
| Date | <u>4/09/03</u> |

I hereby certify that this United States public land survey monument record is correct and complete to the best of my knowledge and belief.
David Zieglmeier Date 2/2/23
 David Zieglmeier Anoka County Surveyor
 Minnesota License Number 46179

HISTORY OF GOVERNMENT CORNER

Page No. 75

County of Anoka

State of Minnesota

Witness Corner of Sec. 35 Township 34 Range 23
(on north line of section)

CORNER HISTORY:

December 9, 1976 - Found 1" iron pipe set in 1908 and replaced with a cast iron monument flush. Established ties to monument.

August 18, 1978 - Found cast iron monument and updated ties.

June 10, 1982 - Found cast iron monument and updated ties.

August 8, 1986 - Found cast iron monument and updated ties.

August 21, 1992 - Found cast iron monument and updated ties.

April 9, 2003 - Established NAD 1983 (1996 adj.) Anoka County project coordinates by static GPS methods.

September 27, 2012 - Found cast iron monument and updated ties.

October 15, 2018 - Found cast iron monument and updated ties.

November 5, 2021 - Found cast iron monument, verified position by VRS GPS method and updated ties.