

CERTIFICATE OF LOCATION OF GOVERNMENT CORNER

County of Anoka

State of Minnesota

North 1/4 Corner of Sec. 33 Township 34 Range 23

On the 17th day of September, 1976, the described corner was evidenced by area resurvey

and to perpetuate the location of said corner, at the exact location thereof, a permanent marker was placed consisting of a red and white iron pipe with sign attached facing north

AND on the 17th day of November, 2021, said permanent marker was found up 3'± and the ties were updated

Updated reference ties are as shown below.

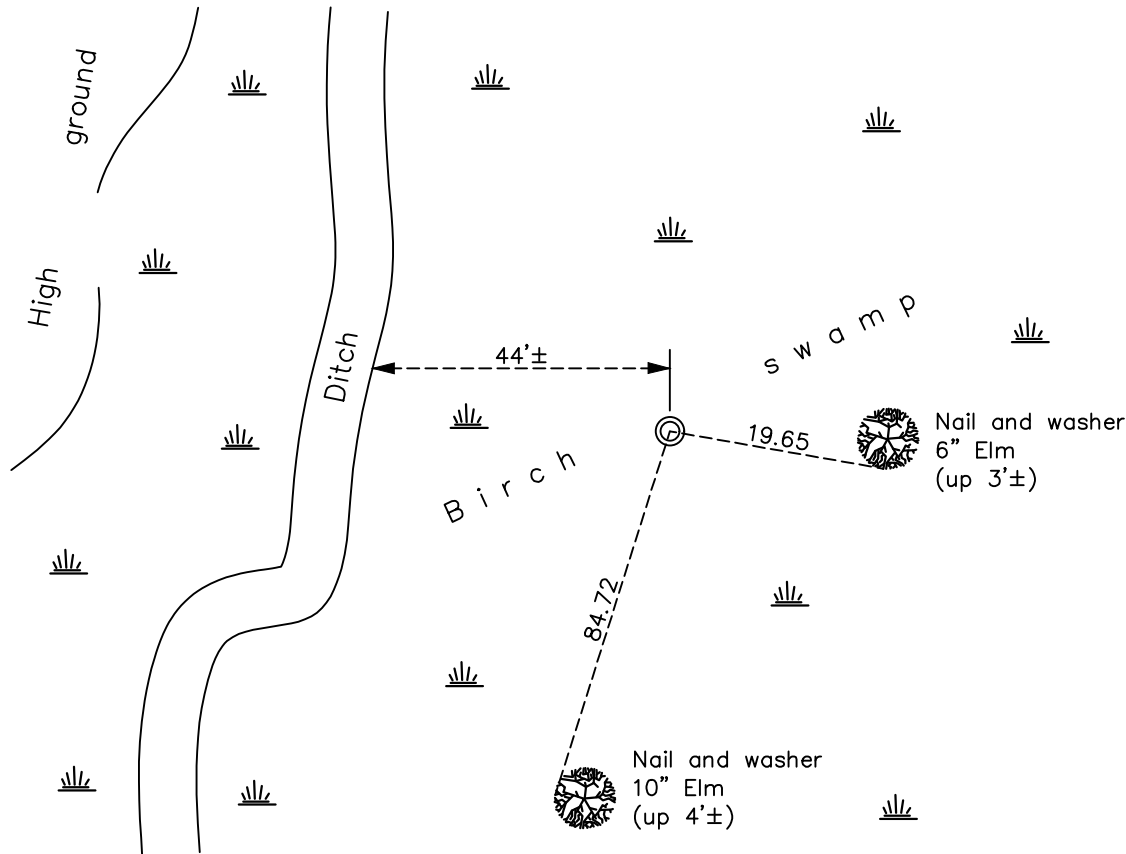

Revision Date
 01/19/2022

N.A.D. 1983 Coordinates
 (1996 Adjustment)

County Project Coordinates	
Northing	<u>232867.4162</u>
Easting	<u>513479.6834</u>
Date	<u>5/15/02</u>

I hereby certify that this United States public land survey monument record is correct and complete to the best of my knowledge and belief.

David Zieglsmeier Date 2/8/23

David M. Zieglsmeier, Anoka County Surveyor
 Minnesota License Number 46179

HISTORY OF GOVERNMENT CORNER

Page No. 79

County of Anoka

State of Minnesota

North 1/4 Corner of Sec. 33 Township 34 Range 23

CORNER HISTORY:

September 17, 1976 - Set red and white iron pipe up 3'± w/sign using area resurvey. Established ties to iron pipe.

June 14, 1993 - Found red and white iron pipe and updated ties.

May 15, 2002 - Established NAD 1983 (1996 adj.) Anoka County project coordinates by static GPS methods.

October 29, 2012 - Found red and white iron pipe up 3'± and updated ties.

March 12, 2019 - Found red and white iron pipe up 3'±. Verified position by VRS GPS methods. Updated ties.

November 17, 2021 - Found red and white iron pipe up 3'±. Verified position by VRS GPS methods. Updated ties.