

# CERTIFICATE OF LOCATION OF GOVERNMENT CORNER

County of Anoka

State of Minnesota

## Northwest Corner of Sec. 33 Township 34 Range 23

On the 18th day of July, 1967, the described corner was evidenced by a 1" iron pipe

and to perpetuate the location of said corner, at the exact location thereof, a permanent marker was placed consisting of a cast iron monument

AND on the 7th day of June, 2021, said permanent marker was reset CIM flush after road construction using static GPS methods. The ties were updated

Updated reference ties are as shown below.

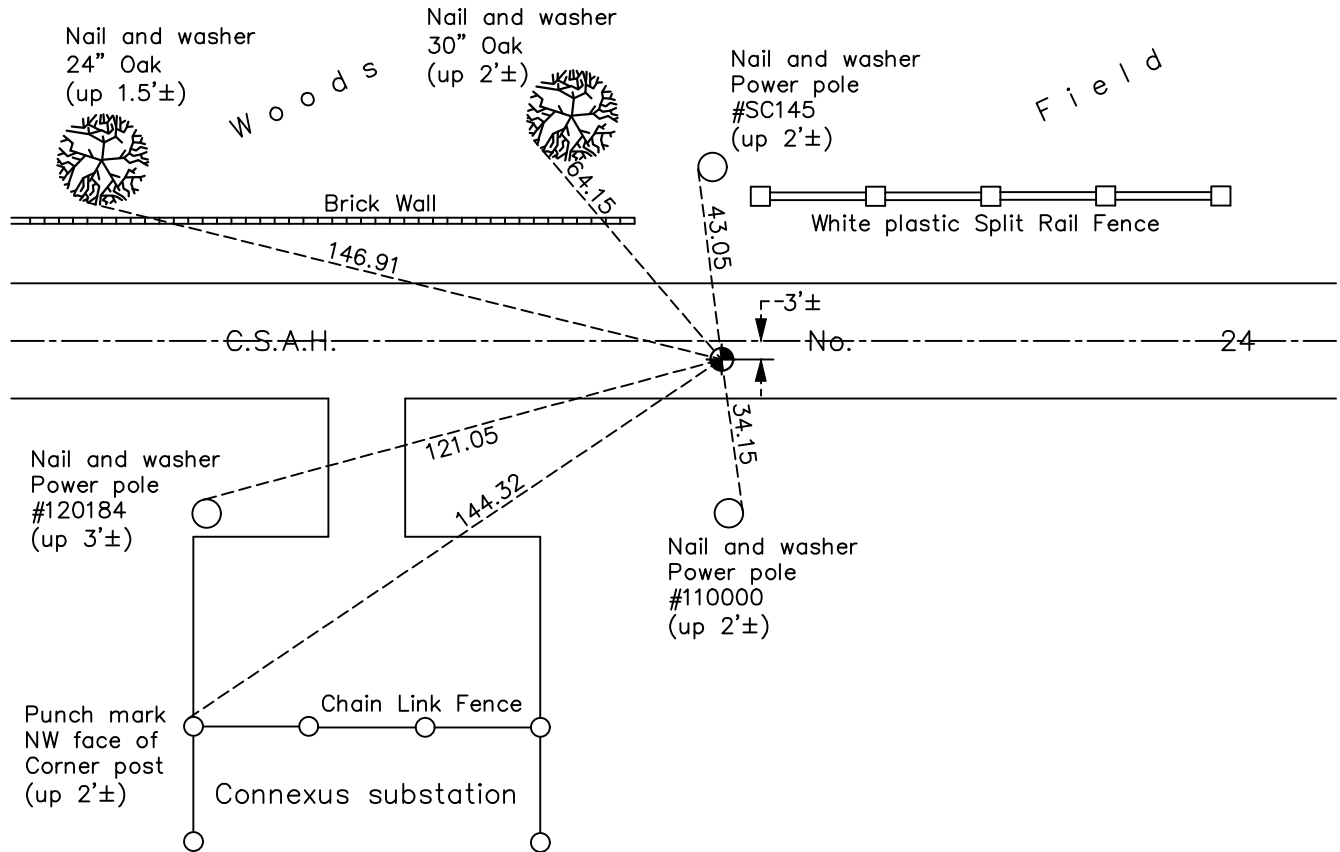

Revision Date  
6/9/21

N.A.D. 1983 Coordinates  
(1996 Adjustment)

| County Project Coordinates |                    |
|----------------------------|--------------------|
| Northing                   | <u>232754.5525</u> |
| Easting                    | <u>510857.8128</u> |
| Date                       | <u>5/09/02</u>     |

I hereby certify that this United States public land survey monument record is correct and complete to the best of my knowledge and belief.

*David Zieglmeier* Date 2/8/23

David M. Zieglmeier, Anoka County Surveyor  
Minnesota License Number 46179

# HISTORY OF GOVERNMENT CORNER

Page No. 80

County of Anoka

State of Minnesota

## Northwest Corner of Sec. 33 Township 34 Range 23

### **CORNER HISTORY:**

June 19, 1959 - Established ties to an iron pipe down 0.3' by County Highway Department.

July 10, 1961 - Found 1" pinched iron down 0.8' and updated ties.

July 23, 1962 - Found 1" iron pipe down 0.8' and updated ties.

July 18, 1967 - Found iron pipe and replaced with cast iron monument and updated ties.

August 17, 1971 - Found cast iron monument and updated ties.

August 11, 1975 - Found cast iron monument and updated ties.

August 22, 1978 - Found cast iron monument and updated ties.

May 27, 1982 - Found cast iron monument and updated ties.

August 1, 1986 - Found cast iron monument and updated ties.

July 31, 1992 - Found cast iron monument flush and updated ties.

August 6, 1997 - Found cast iron monument and updated ties.

May 9, 2002 - Established NAD 1983 (1996 adj.) Anoka County project coordinates by static GPS methods.

August 1, 2012 - Found cast iron monument, verified position by VRS GPS methods and updated ties.

April 5, 2018 - Found cast iron monument down 0.2'±, verified position by VRS GPS methods and updated ties.

April 23, 2021 - Found cast iron monument, set construction ties and verified position by VRS GPS methods prior to road construction. Removed monument.

June 7, 2021 - Reset cast iron monument flush after road construction using static GPS methods. Updated ties.