

CERTIFICATE OF LOCATION OF GOVERNMENT CORNER

County of Anoka

State of Minnesota

East 1/4 Corner of Sec. 3 Township 30 Range 24

On the 14th day of May, 1964, the described corner was evidenced by a concrete monument

and to perpetuate the location of said corner, at the exact location thereof, a permanent marker was placed consisting of a cast iron monument

AND on the 18th day of August, 2022, said permanent marker was found flush with the surface and the ties were updated.

Updated reference ties are as shown below.

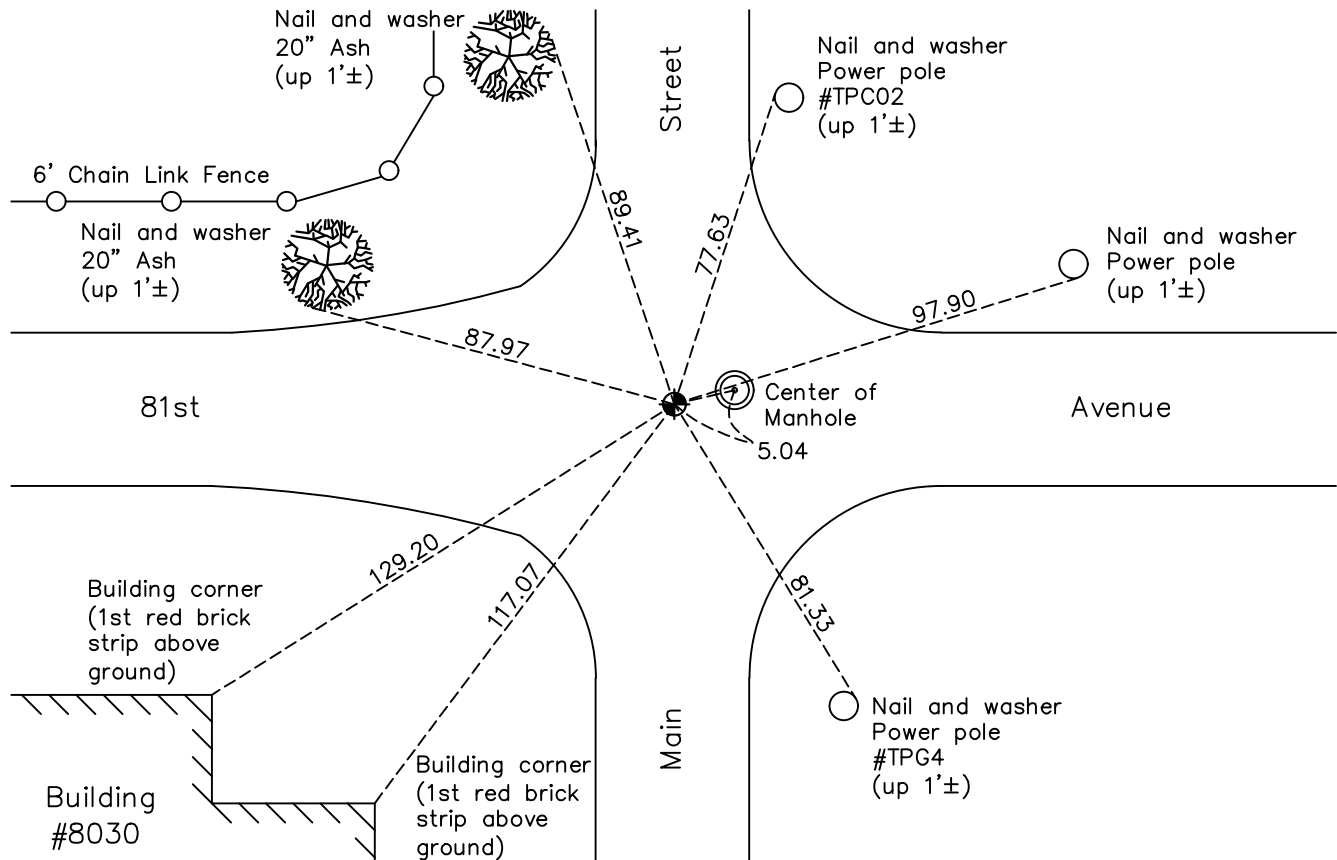

Revision Date
 12/21/22

N.A.D. 1983 Coordinates
 (1996 Adjustment)

County Project Coordinates	
Northing	129141.9321
Easting	499419.4916
Date	7/01/04

I hereby certify that this United States public land survey monument record is correct and complete to the best of my knowledge and belief.
David Zieglmeier Date 12/11/23
 David Zieglmeier Anoka County Surveyor
 Minnesota License Number 46179

HISTORY OF GOVERNMENT CORNER

Page No. 11

County of Anoka

State of Minnesota

East 1/4 Corner of Sec. 3 Township 30 Range 24

CORNER HISTORY:

November 2, 1946 - Harvey Cartwright set a concrete monument up 1'. Established ties to monument.

May 14, 1964 - Found 4" square concrete monument up 10" with top broken off and leaning Southwesterly. Straightened monument and updated ties.

July 8, 1966 - Found broken concrete monument and updated ties.

July 10, 1970 - Found broken concrete monument and replaced with a cast iron monument flush using corner ties. Updated ties.

August 22, 1973 - Reset cast iron monument after road construction using ties set prior to construction. Updated ties.

June 24, 1974 - Found cast iron monument and updated ties.

July 28, 1977 - Found cast iron monument and updated ties.

July 11, 1980 - Found cast iron monument and updated ties.

March 31, 1986 - Found cast iron monument and set construction ties prior to road construction.

June 24, 1986 - Set cast iron monument after road construction.

September 9, 1986 - Found cast iron monument and updated ties.

July 13, 1989 - Found cast iron monument and updated ties.

August 3, 1994 - Found cast iron monument and updated ties.

April 22, 1996 - Found cast iron monument down, raised flush and updated ties.

July 1, 2004 - Established NAD 1983 (1996 adj.) Anoka County project coordinates by static GPS methods.

August 19, 2008 - Found cast iron monument and updated ties.

November 14, 2014 - Found cast iron monument down 0.5'± with no top and leaning Westerly 0.2'±.

March 24, 2015 - Found broken cast iron monument and checked position of center fin by static GPS methods.

March 31, 2015 - Set cast iron monument flush using static GPS methods. Verified position by VRS GPS methods. Updated ties.

November 19, 2019 - Found cast iron monument. Verified position by VRS GPS methods. Updated ties.

August 18, 2022 - Found cast iron monument. Verified position by VRS GPS methods. Updated ties.