

CERTIFICATE OF LOCATION OF GOVERNMENT CORNER

County of Anoka

State of Minnesota

Witness Corner of Sec. 14 Township 30 Range 24
(on south line of section)

On the 17th day of July, 1965, the described corner was evidenced by ties

and to perpetuate the location of said corner, at the exact location thereof, a permanent marker was placed consisting of a cast iron monument

AND on the 12th day of August, 2022, said permanent marker was found and the ties were updated

Updated reference ties are as shown below.

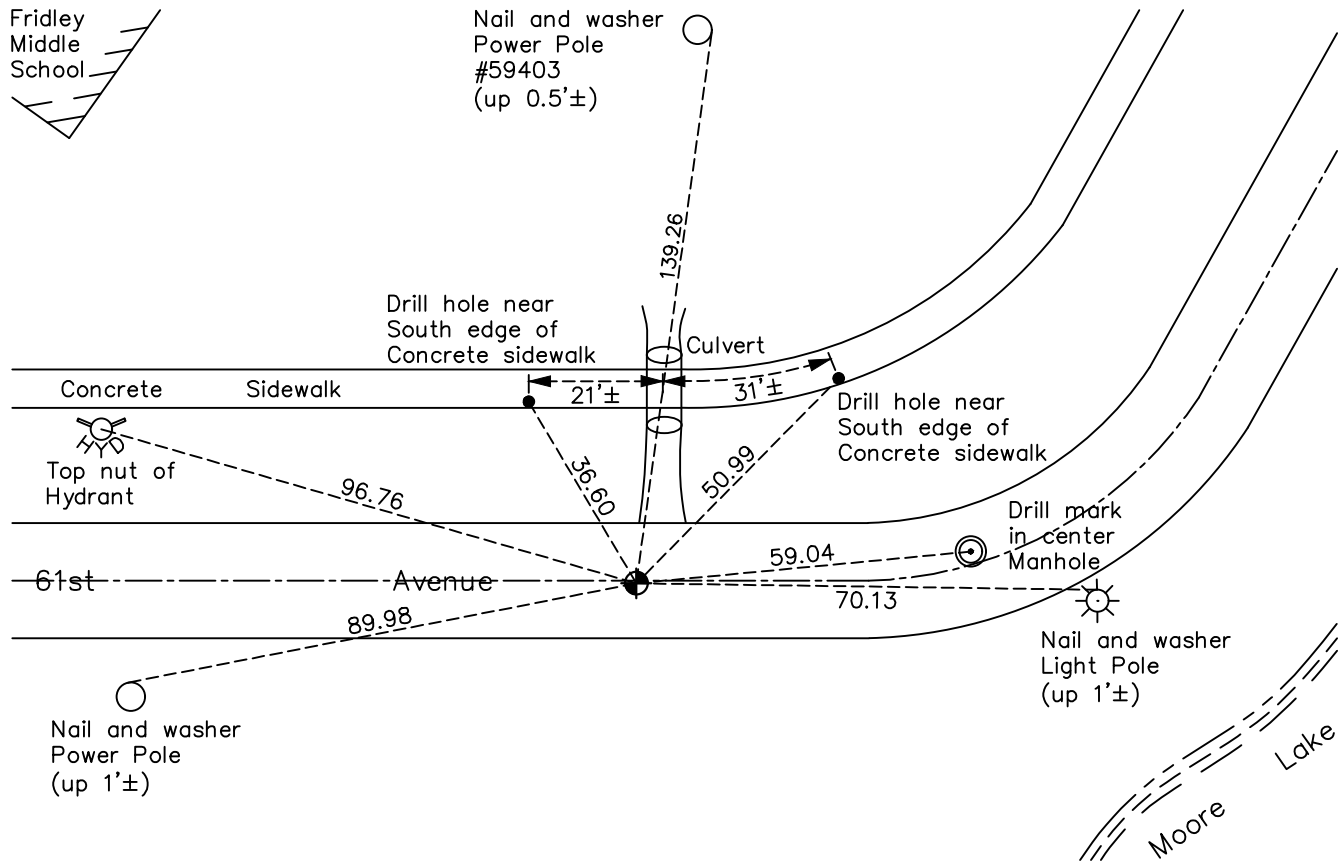

Revision Date
 12/22/22

N.A.D. 1983 Coordinates
 (1996 Adjustment)

County Project Coordinates	
Northing	115884.0406
Easting	504113.8468
Date	7/21/04

I hereby certify that this United States public land survey monument record is correct and complete to the best of my knowledge and belief.
David Zieglmeier Date 12/11/23
 David Zieglmeier Anoka County Surveyor
 Minnesota License Number 46179

HISTORY OF GOVERNMENT CORNER

County of Anoka

State of Minnesota

Witness Corner of Sec. 14 Township 30 Range 24
(on south line of section)

CORNER HISTORY:

July 17, 1965 - Set cast iron monument on South line of Section 14 T30 R24, 253.17' West of Meander corner. Established ties to monument.

July 1, 1966 - Found cast iron monument and updated ties.

August 18, 1970 - Found cast iron monument and updated ties.

June 25, 1974 - Found cast iron monument and updated ties.

August 2, 1977 - Found cast iron monument and updated ties.

May 2, 1978 - Found cast iron monument and updated ties.

July 21, 1980 - Found cast iron monument broken. Replaced with a new cast iron monument and updated ties.

July 1, 1986 - Found cast iron monument and updated ties.

July 14, 1989 - Found cast iron monument and updated ties.

July 27, 1994 - Found cast iron monument and updated ties.

November 25, 1998 - Found cast iron monument and updated ties.

July 21, 2004 - Established NAD 1983 (1996 adj.) Anoka County project coordinates by static GPS methods.

September 5, 2008 - Found cast iron monument and updated ties.

July 9, 2010 - Found cast iron monument. Verified position by VRS GPS methods, set construction ties and updated corner ties prior to road construction. Removed monument.

May 13, 2011 - Set temporary P.K. nail using construction ties after road construction. Checked position against corner ties.

May 25, 2011 - Found temporary P.K. nail and replaced with a cast iron monument. Verified position by VRS GPS methods. Updated ties.

October 28, 2014 - Found cast iron monument. Verified position by VRS GPS methods. Updated ties.

December 6, 2019 - Found cast iron monument. Verified position by VRS GPS methods. Updated ties.

August 12, 2022 - Found cast iron monument. Verified position by VRS GPS methods. Updated ties.