

# CERTIFICATE OF LOCATION OF GOVERNMENT CORNER

County of Anoka

State of Minnesota

## West 1/4 Corner of Sec. 1 Township 32 Range 23

On the 31st day of October, 1966, the described corner was evidenced by area resurvey

and to perpetuate the location of said corner, at the exact location thereof, a permanent marker was placed consisting of a cast iron monument

AND on the 19th day of August, 2014, said permanent marker was Found missing due to area development. Set witness corner 500' to the south in blacktop road on 8/22/14.

Updated reference ties are as shown below.

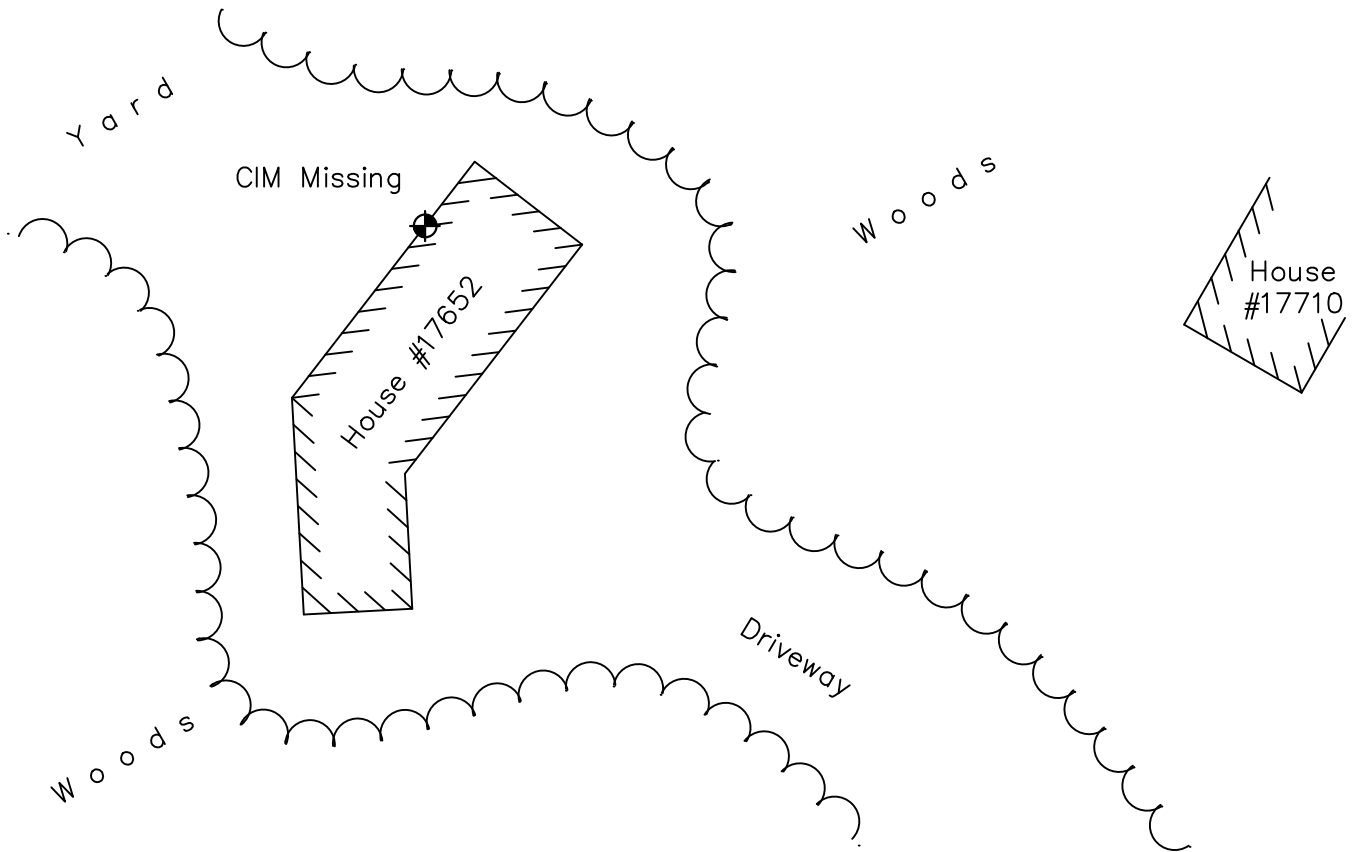

Revision Date  
 5/6/2022

N.A.D. 1983 Coordinates  
 (1996 Adjustment)

County Project Coordinates	
Northing	<u>193460.6945</u>
Easting	<u>526806.6731</u>
Date	<u>8/14/96</u>

I hereby certify that this United States public land survey monument record is correct and complete to the best of my knowledge and belief.

*David Zieglmeier* Date 5/31/22

David M. Zieglmeier, Anoka County Surveyor  
 Minnesota License Number 46179

# HISTORY OF GOVERNMENT CORNER

Page No. 19

County of Anoka

State of Minnesota

West 1/4 Corner of Sec. 1 Township 32 Range 23

## **CORNER HISTORY:**

February 1855 - This corner was established by Hiram Taylor, Deputy Surveyor. Taylor marked the position by "Set quarter section post" with two bearing trees marked as accessories.

October 31, 1966 - Set cast iron monument down  $0.1' \pm$  using area resurvey. Established ties to monument.

May 25, 1971 - Found cast iron monument and updated ties.

June 4, 1975 - Found cast iron monument and updated ties.

June 5, 1978 - Found cast iron monument and updated ties.

June 23, 1981 - Found cast iron monument and updated ties.

August 9, 1983 - Found cast iron monument flush and updated ties after tree damage from storm.

June 29, 1984 - Found cast iron monument and updated ties.

July 6, 1987 - Found cast iron monument and updated ties.

November 15, 1991 - Found cast iron monument and updated ties.

August 14, 1996 - Found cast iron monument and updated ties. Established NAD 1983 (1996 adj.) Anoka County project coordinates by static GPS methods.

2001 - Approximate date of development to the area.

August 19, 2014 - Found cast iron monument missing due to area development. Set temporary P.K. nail 500' south of original location for a witness corner position.

August 22, 2014 - Set cast iron monument as witness corner 500' south of West 1/4 corner using area resurvey. Established ties to cast iron monument. Verified position by VRS GPS methods.