

CERTIFICATE OF LOCATION OF GOVERNMENT CORNER

County of Anoka

State of Minnesota

East 1/4 Corner of Sec. 8 Township 32 Range 23

On the 5th day of March, 1962, the described corner was evidenced by a 1" iron pipe

and to perpetuate the location of said corner, at the exact location thereof, a permanent marker was placed consisting of a cast iron monument

AND on the 18th day of February, 2021, said permanent marker was found down 0.1'± and the ties were updated

Updated reference ties are as shown below.

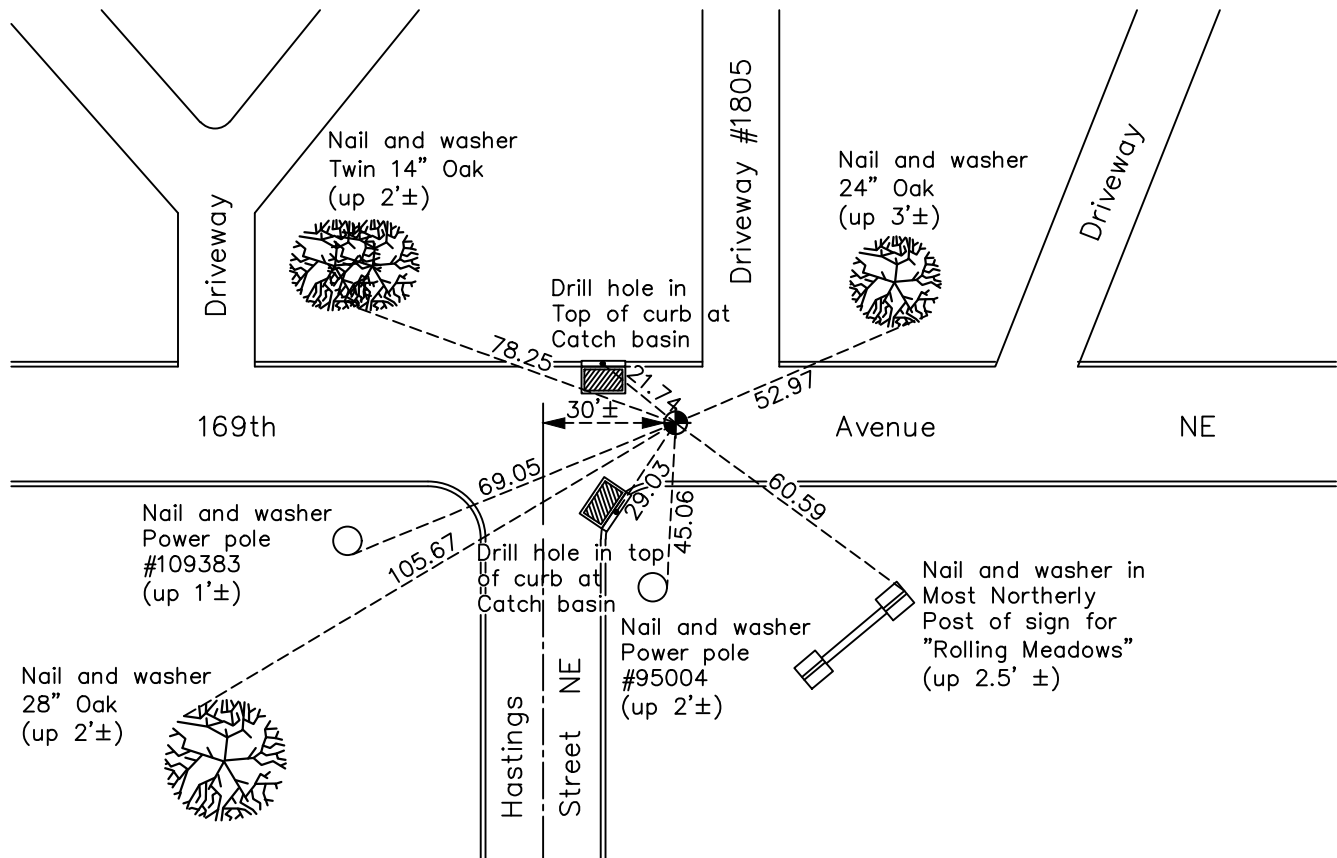

Revision Date

7/09/2021

N.A.D. 1983 Coordinates
(1996 Adjustment)

County Project Coordinates	
Northing	<u>188223.1637</u>
Easting	<u>510806.0427</u>
Date	<u>11/28/01</u>

I hereby certify that this United States public land survey monument record is correct and complete to the best of my knowledge and belief.

David Zieglmeier Date 5/31/22

David Zieglmeier Anoka County Surveyor
Minnesota License Number 46179

HISTORY OF GOVERNMENT CORNER

Page No. 36

County of Anoka

State of Minnesota

East 1/4 Corner of Sec. 8 Township 32 Range 23

CORNER HISTORY:

February 1855 - This corner was established by Hiram Taylor, Deputy Surveyor. Taylor marked the position by "Set quarter section post" with one bearing tree marked as an accessory.

March 5, 1962 - Found 3/4" iron pipe down 0.3'± and updated ties.

July 16, 1964 - Found 1" iron pipe down 3'± and set cast iron monument down 0.5'±. Updated ties.

July 21, 1966 - Found cast iron monument and updated ties.

June 2, 1971 - Found cast iron monument and updated ties.

August 22, 1974 - Found cast iron monument broken and replaced with a new cast iron monument down 1.5'±. Updated ties.

June 6, 1975 - Found cast iron monument and updated ties.

June 9, 1978 - Found cast iron monument and updated ties.

November 18, 1980 - Found cast iron monument and updated ties.

June 25, 1981 - Found cast iron monument and updated ties.

June 29, 1984 - Found cast iron monument and updated ties.

October 19, 1991 - Found cast iron monument and updated ties.

August 2, 1996 - Found cast iron monument and updated ties.

April 7, 2011 - Found cast iron monument broken and down 2'±. Checked corner ties to center fin.

May 20, 2011 - Set new cast iron monument flush with road on top of broken cast iron monument (leaning) using static GPS methods. Updated ties. Verified position by VRS GPS methods.

March 10, 2017 - Found cast iron monument down 0.1'±. Verified position by VRS GPS methods. Updated ties.

February 18, 2021 - Found cast iron monument down 0.1'±. Verified position by VRS GPS methods. Updated ties.