

CERTIFICATE OF LOCATION OF GOVERNMENT CORNER

County of Anoka

State of Minnesota

West 1/4 Corner of Sec. 12 Township 32 Range 23

On the 22nd day of November, 1965, the described corner was evidenced by area resurvey

and to perpetuate the location of said corner, at the exact location thereof, a permanent marker was placed consisting of a cast iron monument down 1'±

AND on the 12th day of April, 2021, said permanent marker was found broken. Replaced with a new, solid cast iron monument down 1' ± and the ties were updated.

Updated reference ties are as shown below.

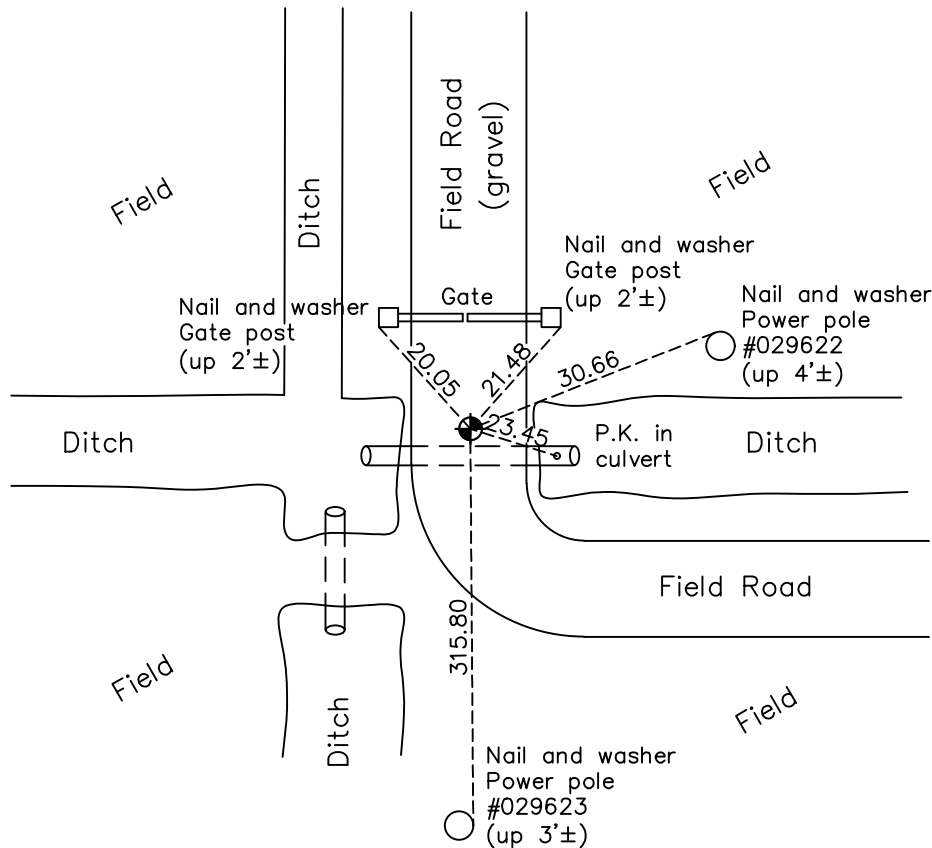

Revision Date
7/09/2021

N.A.D. 1983 Coordinates
(1996 Adjustment)

County Project Coordinates	
Northing	<u>188129.6858</u>
Easting	<u>526822.8815</u>
Date	<u>1/28/02</u>

I hereby certify that this United States public land survey monument record is correct and complete to the best of my knowledge and belief.

David Zieglmeier Date 5/31/22

David Zieglmeier Anoka County Surveyor
Minnesota License Number 46179

HISTORY OF GOVERNMENT CORNER

Page No. 42

County of Anoka

State of Minnesota

West 1/4 Corner of Sec. 12 Township 32 Range 23

CORNER HISTORY:

February 1855 - This corner was established by Hiram Taylor, Deputy Surveyor. Taylor marked the position by "Set quarter section post in 1 foot water, no trees near, impossible to make mound."

November 22, 1965 - Set cast iron monument flush using area resurvey. Corner ties not available.

July 21, 1966 - Found cast iron monument. Corner ties not available.

October 21, 1969 - Reset cast iron monument using construction ties. Established corner ties to monument.

May 25, 1971 - Found cast iron monument and updated ties.

June 27, 1975 - Reset cast iron monument down 1'±. Updated ties.

June 9, 1978 - Found cast iron monument and updated ties.

June 26, 1984 - Found cast iron monument and updated ties.

December 31, 1990 - Found cast iron monument down 1'± and updated ties.

September 19, 1991 - Reset cast iron monument down 1'± using one remaining corner tie and an area resurvey. Updated ties.

August 15, 1996 - Found cast iron monument and updated ties.

January 28, 2002 - Found cast iron monument and updated ties. Established NAD 1983 (1996 adj.) Anoka County project coordinates by static GPS methods.

July 21, 2011 - Found cast iron monument down 1'± and updated ties.

March 24, 2017 - Found cast iron monument down 1'±. Verified position by VRS GPS methods. Updated ties.

April 12, 2021 - Found cast iron monument w/ top broken off. Updated ties using center of fins and verified position of corner by VRS GPS methods.

April 23, 2021 - Replaced broken CIM with new solid cast iron monument down 1' ±