

# CERTIFICATE OF LOCATION OF GOVERNMENT CORNER

County of Anoka

State of Minnesota

## West 1/4 Corner of Sec. 13 Township 32 Range 23

On the 1st day of December, 1965, the described corner was evidenced by area resurvey

and to perpetuate the location of said corner, at the exact location thereof, a permanent marker was placed consisting of a cast iron monument (with sign & post on the east side)

AND on the 12th day of April, 2021, said permanent marker was found flush and the ties were updated

Updated reference ties are as shown below.

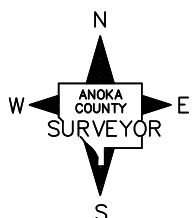
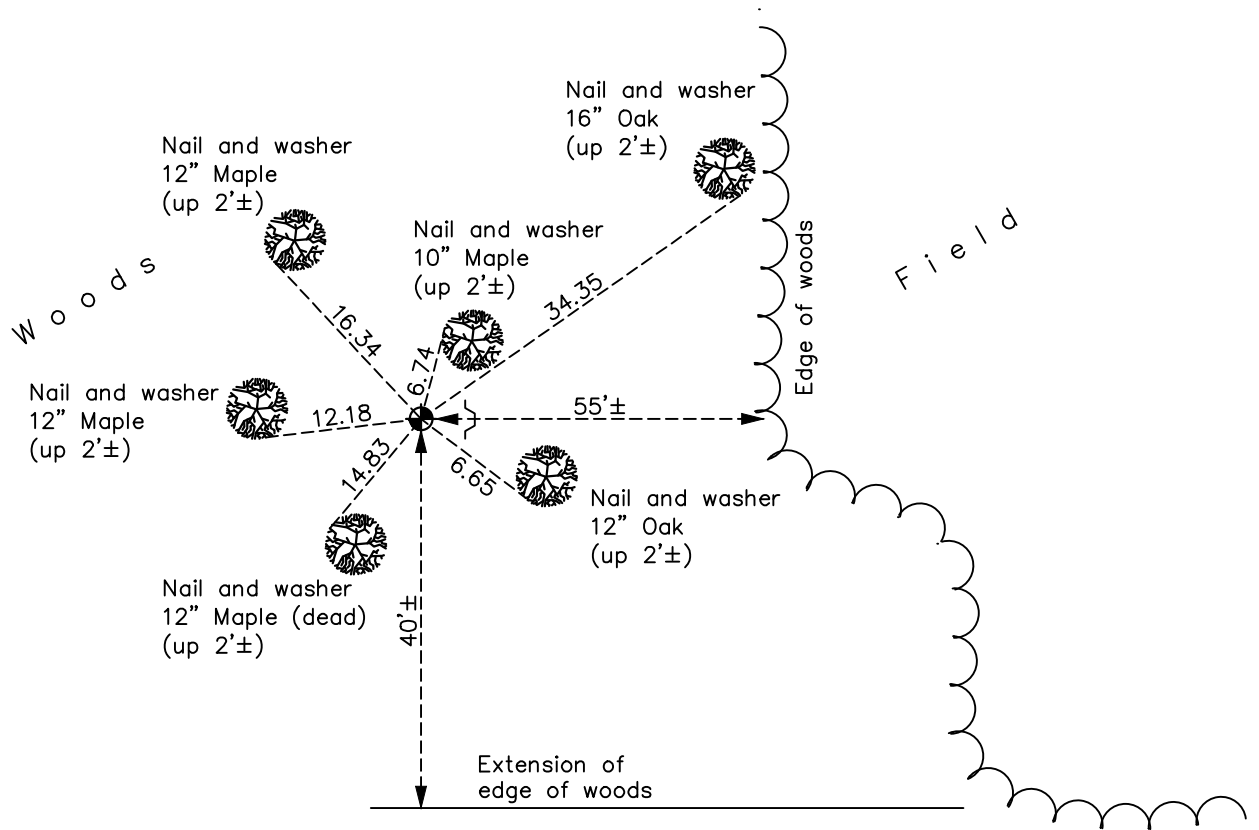

Revision Date  
7/20/2021

N.A.D. 1983 Coordinates  
 (1996 Adjustment)

County Project Coordinates	
Northing	<u>182700.2440</u>
Easting	<u>526790.0251</u>
Date	<u>12/12/02</u>

I hereby certify that this United States public land survey monument record is correct and complete to the best of my knowledge and belief.  
*David Zieglmeier* Date 7/14/22  
 David Zieglmeier Anoka County Surveyor  
 Minnesota License Number 46179

# HISTORY OF GOVERNMENT CORNER

Page No. 63

County of Anoka

State of Minnesota

West 1/4 Corner of Sec. 13 Township 32 Range 23

## **CORNER HISTORY:**

February 1855 - This corner was established by Hiram Taylor, Deputy Surveyor. Taylor marked the position by "Set quarter section post" with two bearing trees marked as accessories.

December 1, 1965 - Set cast iron monument flush using area resurvey. Established ties to monument.

August 2, 1966 - Found cast iron monument and updated ties.

June 24, 1971 - Found cast iron monument and updated ties.

June 23, 1975 - Found cast iron monument and updated ties.

June 13, 1978 - Found cast iron monument and updated ties.

July 16, 1984 - Found cast iron monument and updated ties.

January 3, 1991 - Found cast iron monument and updated ties.

September 4, 1996 - Found cast iron monument and updated ties.

December 12, 2002 - Established NAD 1983 (1996 adj.) Anoka County project coordinates by static GPS methods.

March 30, 2011 - Found cast iron monument with top broken off. Checked corner ties to center fin.

May 23, 2011 - Replaced broken cast iron monument with new cast iron monument using static GPS methods. Updated ties. Set sign and post on the east side.

March 13, 2017 - Found cast iron monument flush and updated ties.

April 12, 2021 - Found cast iron monument flush and updated ties. Verified position by VRS GPS methods.