

CERTIFICATE OF LOCATION OF GOVERNMENT CORNER

County of Anoka

State of Minnesota

Meander Corner of Sec. 17 Township 32 Range 23 (on east side of island)

On the 2nd day of July, 1959, the described corner was evidenced by a one inch iron pipe

and to perpetuate the location of said corner, at the exact location thereof, a permanent marker was placed consisting of an iron pipe with brass cap labeled 'US General Land Office Survey-1919' and leaning NE 0.3'±

AND on the 17th day of February, 2021, said permanent marker was Found and the ties were updated.

Updated reference ties are as shown below.

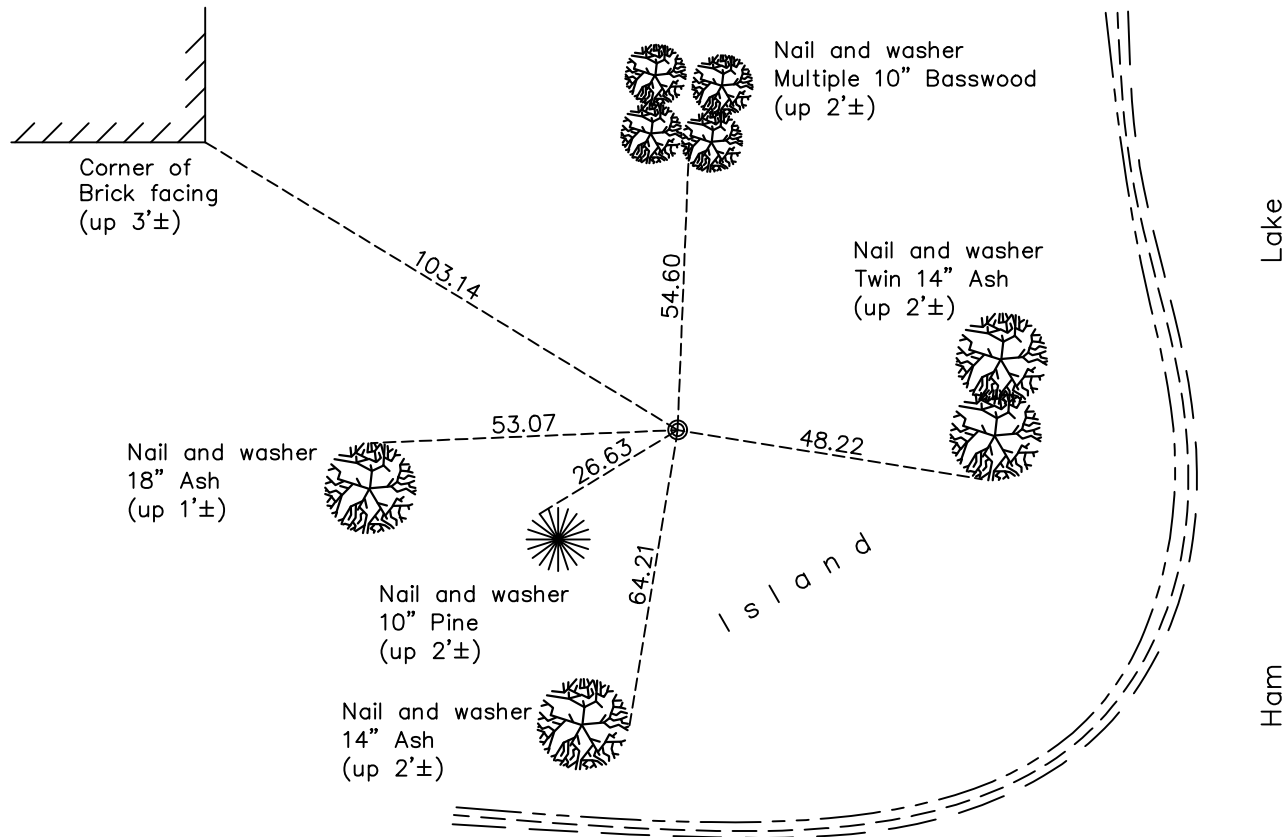

Revision Date
7/22/2021

N.A.D. 1983 Coordinates
 (1996 Adjustment)

County Project Coordinates	
Northing	<u>180246.9442</u>
Easting	<u>510819.8478</u>
Date	<u>2/05/02</u>

I hereby certify that this United States public land survey monument record is correct and complete to the best of my knowledge and belief.
David Zieglmeier Date 7/14/22
 David Zieglmeier Anoka County Surveyor
 Minnesota License Number 46179

HISTORY OF GOVERNMENT CORNER

Page No. 74

County of Anoka

State of Minnesota

Meander Corner of Sec. 17 Township 32 Range 23 (on east side of island)

CORNER HISTORY:

July 2, 1959 - Found 1" iron pipe with cap containing government marks bent north 0.1'±. Updated ties.

July 13, 1964 - Found 1" iron pipe with cap and updated ties.

August 11, 1966 - Found 1" iron pipe with cap and updated ties.

June 14, 1971 - Found 1" iron pipe with cap and updated ties.

June 18, 1975 - Found 1" iron pipe with cap and updated ties.

June 14, 1978 - Found 1" iron pipe with cap and updated ties.

November 3, 1980 - Found 1" iron pipe with cap and updated ties.

July 12, 1984 - Found 1" iron pipe with cap and updated ties.

June 17, 1992 - Found 1" iron pipe with cap and updated ties.

August 5, 1996 - Found 1" iron pipe with cap and updated ties.

February 5, 2002 - Found 1" iron pipe with cap and updated ties. Established NAD 1983 (1996 adj.) Anoka County project coordinates by static GPS methods.

April 29, 2011 - Found 1" iron pipe with G.L.O. brass cap leaning 0.3'± northeasterly. Updated ties.

March 2017 - Found 1" iron pipe with G.L.O. brass cap leaning 0.3'± northeasterly. Updated ties.

February 17, 2021 - Found 1" iron pipe with G.L.O. brass cap leaning 0.3'± northeasterly. Updated ties.