

CERTIFICATE OF LOCATION OF GOVERNMENT CORNER

County of Anoka

State of Minnesota

Meander#9 Corner of Sec. 16 Township 32 Range 23 (on south line of section)

On the 10th day of June, 1960, the described corner was evidenced by a concrete monument

and to perpetuate the location of said corner, at the exact location thereof, a permanent marker was placed consisting of the same concrete monument with a sign and post on the south side

AND on the 15th day of January, 2021, said permanent marker was found up 0.1'± and the ties were updated

Updated reference ties are as shown below.

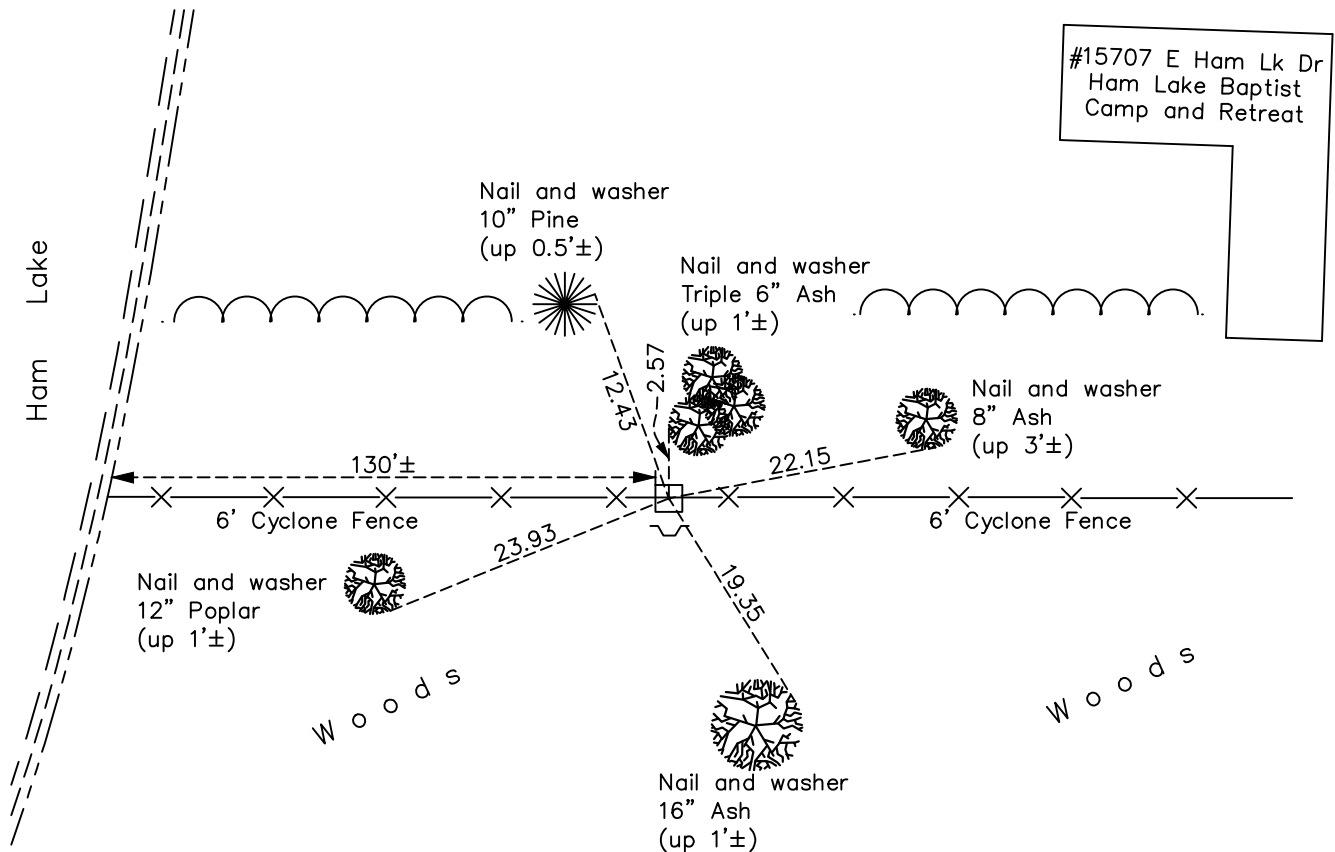

#15707 E Ham Lk Dr
Ham Lake Baptist
Camp and Retreat

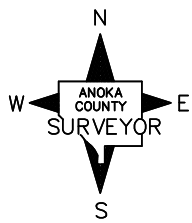

Revision Date
7/22/2021

N.A.D. 1983 Coordinates
(1996 Adjustment)

County Project Coordinates	
Northing	180263.6848
Easting	512706.3997
Date	2/05/02

I hereby certify that this United States public land survey monument record is correct and complete to the best of my knowledge and belief.
David Zieglmeier Date 7/21/22
David Zieglmeier Anoka County Surveyor
Minnesota License Number 46179

HISTORY OF GOVERNMENT CORNER

Page No. 75

County of Anoka

State of Minnesota

Meander#9 Corner of Sec. 16 Township 32 Range 23 (on south line of section)

CORNER HISTORY:

February 1855 - This corner was established by Hiram Taylor, Deputy Surveyor. Taylor marked the position by "At lake, set meander post" with one bearing tree marked as an accessory.

December 1, 1948 - Found concrete monument up 0.3'± with iron pipe on north side. Updated ties.

June 10, 1960 - Found concrete monument up 0.3'± with iron pipe on north side. Updated ties.

June 15, 1964 - Found concrete monument with iron pipe on north side. Updated ties.

June 7, 1971 - Found concrete monument with iron pipe on north side. Updated ties.

June 18, 1975 - Found concrete monument with iron pipe on north side. Updated ties.

June 14, 1978 - Found concrete monument with iron pipe on north side. Updated ties.

July 12, 1984 - Found concrete monument with iron pipe on north side. Updated ties.

January 3, 1991 - Found concrete monument and updated ties.

June 1, 1993 - Found concrete monument and updated ties.

August 13, 1996 - Found concrete monument and updated ties.

February 5, 2002 - Found concrete monument and updated ties. Established NAD 1983 (1996 adj.) Anoka County project coordinates by static GPS methods.

February 28, 2011 - Found concrete monument up 0.1'± and updated ties.

February 16, 2017 - Found concrete monument up 0.1'± and updated ties.

January 15, 2021 - Found concrete monument up 0.1'± and updated ties.