

CERTIFICATE OF LOCATION OF GOVERNMENT CORNER

County of Anoka

State of Minnesota

Meander#10 Corner of Sec. 21 Township 32 Range 23

(on west line of section)

On the 17th day of May, 1963, the described corner was evidenced by area resurvey

and to perpetuate the location of said corner, at the exact location thereof, a permanent marker was placed consisting of a cast iron monument

AND on the 8th day of January, 2021, said permanent marker was found with 3 T-posts around the monument and the ties were updated

Updated reference ties are as shown below.

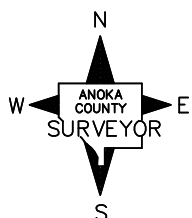
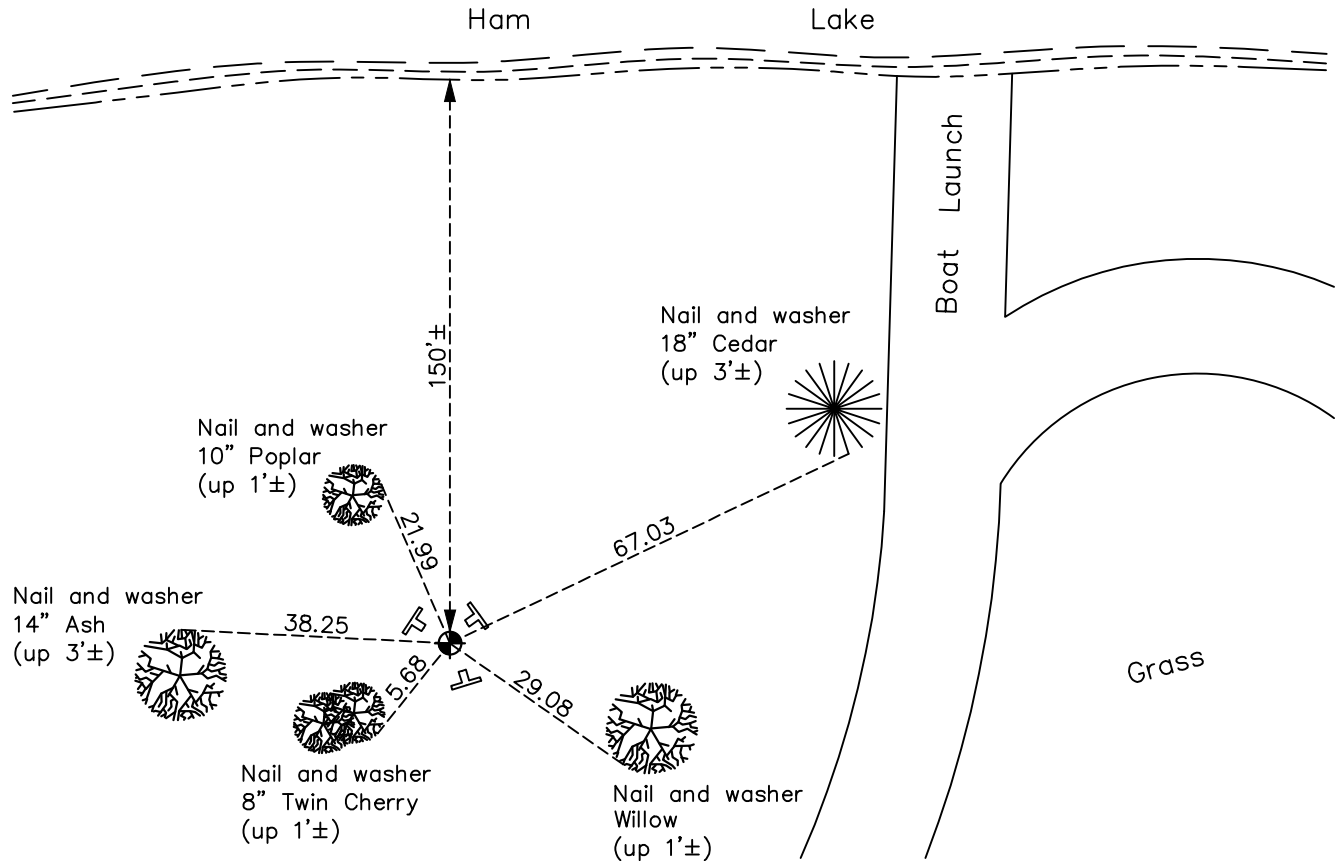

Revision Date
7/22/2021

N.A.D. 1983 Coordinates
(1996 Adjustment)

County Project Coordinates	
Northing	<u>179172.7790</u>
Easting	<u>510894.4015</u>
Date	<u>12/01/01</u>

I hereby certify that this United States public land survey monument record is correct and complete to the best of my knowledge and belief.

David Zieglmeier Date 7/21/22

David Zieglmeier Anoka County Surveyor
Minnesota License Number 46179

HISTORY OF GOVERNMENT CORNER

Page No. 84

County of Anoka

State of Minnesota

Meander#10 Corner of Sec. 21 Township 32 Range 23
(on west line of section)

CORNER HISTORY:

February 1855 - This corner was established by Hiram Taylor, Deputy Surveyor. Taylor marked the position by "At lake set meander post" with one bearing tree marked as an accessory.

May 17, 1963 - Set cast iron monument flush using area resurvey. Established ties to monument.

July 15, 1964 - Found cast iron monument and updated ties.

August 8, 1966 - Found cast iron monument and updated ties.

June 4, 1971 - Found cast iron monument and updated ties.

June 18, 1975 - Found cast iron monument and updated ties.

June 15, 1978 - Found cast iron monument and updated ties.

July 18, 1984 - Found cast iron monument and updated ties.

June 29, 1987 - Found cast iron monument and updated ties.

September 16, 1992 - Found cast iron monument broken and replaced with a new cast iron monument. Updated ties. Set sign and post on the north side.

September 3, 1996 - Found cast iron monument and updated ties.

December 1, 2001 - Found cast iron monument and updated ties. Established NAD 1983 (1996 adj.) Anoka County project coordinates by static GPS methods.

March 4, 2011 - Found cast iron monument surrounded by 3 T-posts. Updated ties.

February 15, 2017 - Found cast iron monument surrounded by 3 T-posts. Updated ties.

January 8, 2021 - Found cast iron monument surrounded by 3 T-posts. Updated ties. Verified position of corner by VRS GPS method.