

CERTIFICATE OF LOCATION OF GOVERNMENT CORNER

County of Anoka

State of Minnesota

Southeast Corner of Sec. 24 Township 32 Range 23

On the 3rd day of May, 1965, the described corner was evidenced by a concrete monument

and to perpetuate the location of said corner, at the exact location thereof, a permanent marker was placed consisting of a 6' long 2" square steel Telespar monument with a punch marked 'County Surveyor' cap.

AND on the 13th day of April, 2021, said permanent marker was found and the ties were updated

Updated reference ties are as shown below.

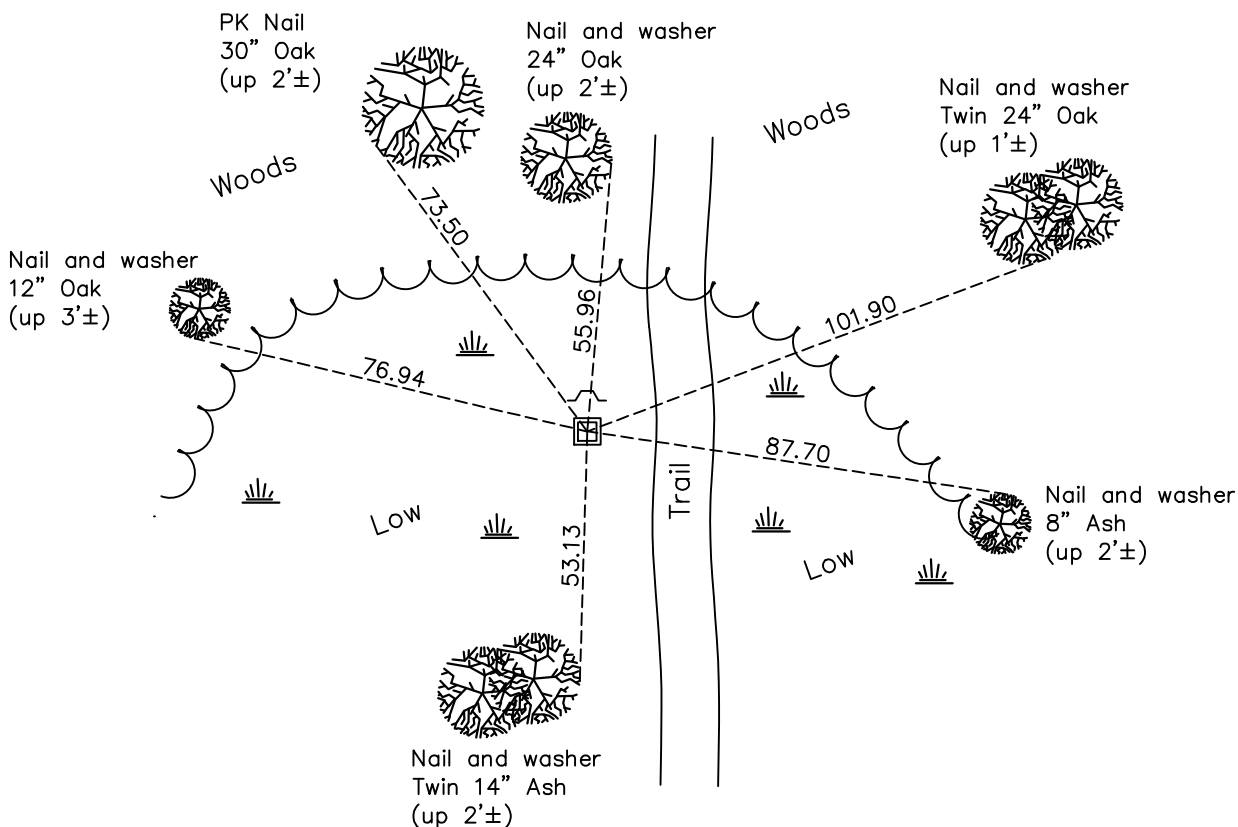

Revision Date
 7/23/2021

N.A.D. 1983 Coordinates
 (1996 Adjustment)

County Project Coordinates	
Northing	<u>174638.4826</u>
Easting	<u>532026.3538</u>
Date	<u>3/04/02</u>

I hereby certify that this United States public land survey monument record is correct and complete to the best of my knowledge and belief.
David Zieglmeier Date 7/21/22
 David Zieglmeier Anoka County Surveyor
 Minnesota License Number 46179

HISTORY OF GOVERNMENT CORNER

Page No. 89

County of Anoka

State of Minnesota

Southeast Corner of Sec. 24 Township 32 Range 23

CORNER HISTORY:

August 1847 - This corner was established by James M. Marsh, Deputy Surveyor. Marsh marked the position by "Set post at corner to sections 19, 24, 25 & 30" with two bearing trees marked as accessories.

May 3, 1965 - Found 4" square concrete monument up 1.3'± in swamp. Updated ties.

January 22, 1974 - Found concrete monument and updated ties.

February 11, 1994 - Found concrete monument up 1'± with top broken. Found sign and post on the north side. Updated ties.

March 4, 2002 - Found concrete monument and updated ties. Established NAD 1983 (1996 adj.) Anoka County project coordinates by static GPS methods.

March 4, 2011 - Found concrete monument up 1'± and leaning south. Updated ties.

2012 - Found concrete monument laying down. Removed concrete monument and set temporary spike using corner ties.

March 1, 2012 - Set 6' long 2" square steel Telspar monument w/punch marked 'County Surveyor' cap. Verified position by static and VRS GPS methods. Updated ties.

March 23, 2017 - Found 2" square steel Telspar monument w/punch marked 'County Surveyor' cap. Verified position by VRS GPS methods. Updated ties.

April 13, 2021 - Found 2" square steel Telspar monument w/punch marked 'County Surveyor' cap. Verified position by VRS GPS methods. Updated ties.