

# CERTIFICATE OF LOCATION OF GOVERNMENT CORNER

County of Anoka

State of Minnesota

## South 1/4 Corner of Sec. 19 Township 32 Range 23

On the 10th day of May, 1960, the described corner was evidenced by a pinched iron pipe

and to perpetuate the location of said corner, at the exact location thereof, a permanent marker was placed consisting of a cast iron monument with a sign and post on the north side

AND on the 14th day of April, 2021, said permanent marker was found down 0.5'± and the ties were updated

Updated reference ties are as shown below.

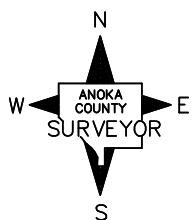
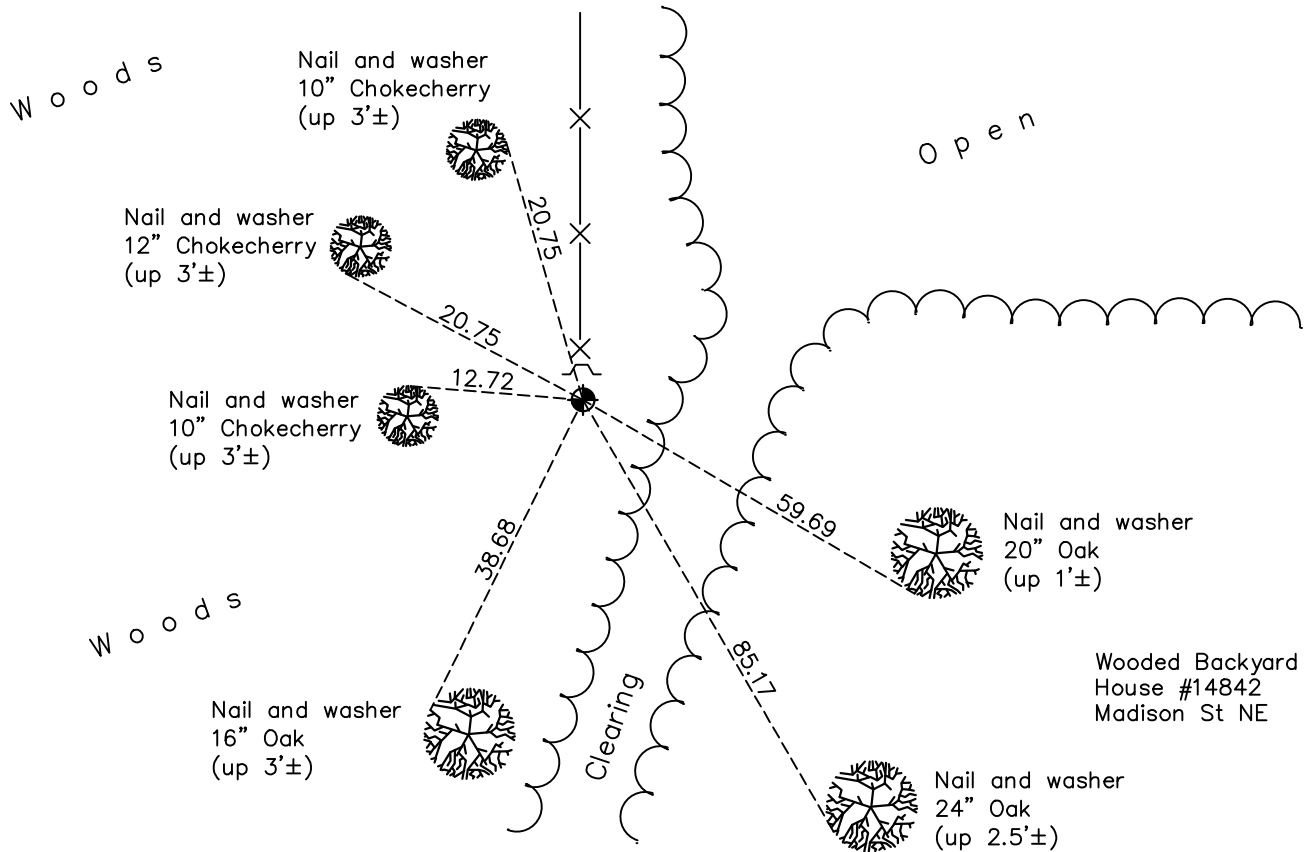

Revision Date

7/26/2021

N.A.D. 1983 Coordinates  
(1996 Adjustment)

County Project Coordinates	
Northing	<u>174830.1501</u>
Easting	<u>502827.0924</u>
Date	<u>12/20/01</u>

I hereby certify that this United States public land survey monument record is correct and complete to the best of my knowledge and belief.

*David Zieglmeier* Date 7/21/22

David Zieglmeier Anoka County Surveyor  
Minnesota License Number 46179

# HISTORY OF GOVERNMENT CORNER

Page No. 100

County of Anoka

State of Minnesota

## South 1/4 Corner of Sec. 19 Township 32 Range 23

### **CORNER HISTORY:**

February 1855 - This corner was established by Hiram Taylor, Deputy Surveyor. Taylor marked the position by "Set quarter section post" with two bearing trees marked as accessories.

May 10, 1960 - Found pinched iron pipe 0.2' east of fence corner. Updated ties.

July 21, 1964 - Found pinched iron pipe and updated ties.

August 8, 1966 - Found pinched iron pipe and updated ties.

June 14, 1971 - Set cast iron monument using corner ties. Updated ties.

June 20, 1975 - Found cast iron monument and updated ties.

June 16, 1978 - Found cast iron monument and updated ties.

July 11, 1984 - Found cast iron monument and updated ties.

July 10, 1987 - Corner had been moved. Relocated cast iron monument to proper location using area resurvey. Set sign and post on north side. Corner is 2'± north of steel fence post. Updated ties.

August 14, 1996 - Found cast iron monument and updated ties.

December 20, 2001 - Found cast iron monument and updated ties. Established NAD 1983 (1996 adj.) Anoka County project coordinates by static GPS methods.

March 15, 2011 - Found cast iron monument down 0.5'± and updated ties.

March 22, 2017 - Found cast iron monument down 0.5'± and updated ties.

April 14, 2021 - Found cast iron monument down 0.5'± and updated ties.