

CERTIFICATE OF LOCATION OF GOVERNMENT CORNER

County of Anoka

State of Minnesota

West 1/4 Corner of Sec. 26 Township 32 Range 23

On the 23rd day of September, 1966, the described corner was evidenced by area resurvey

and to perpetuate the location of said corner, at the exact location thereof, a permanent marker was placed consisting of a cast iron monument

AND on the 6th day of April, 2021, said permanent marker was found flush and updated ties.

Updated reference ties are as shown below.

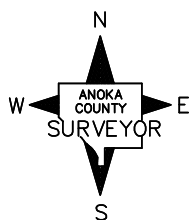
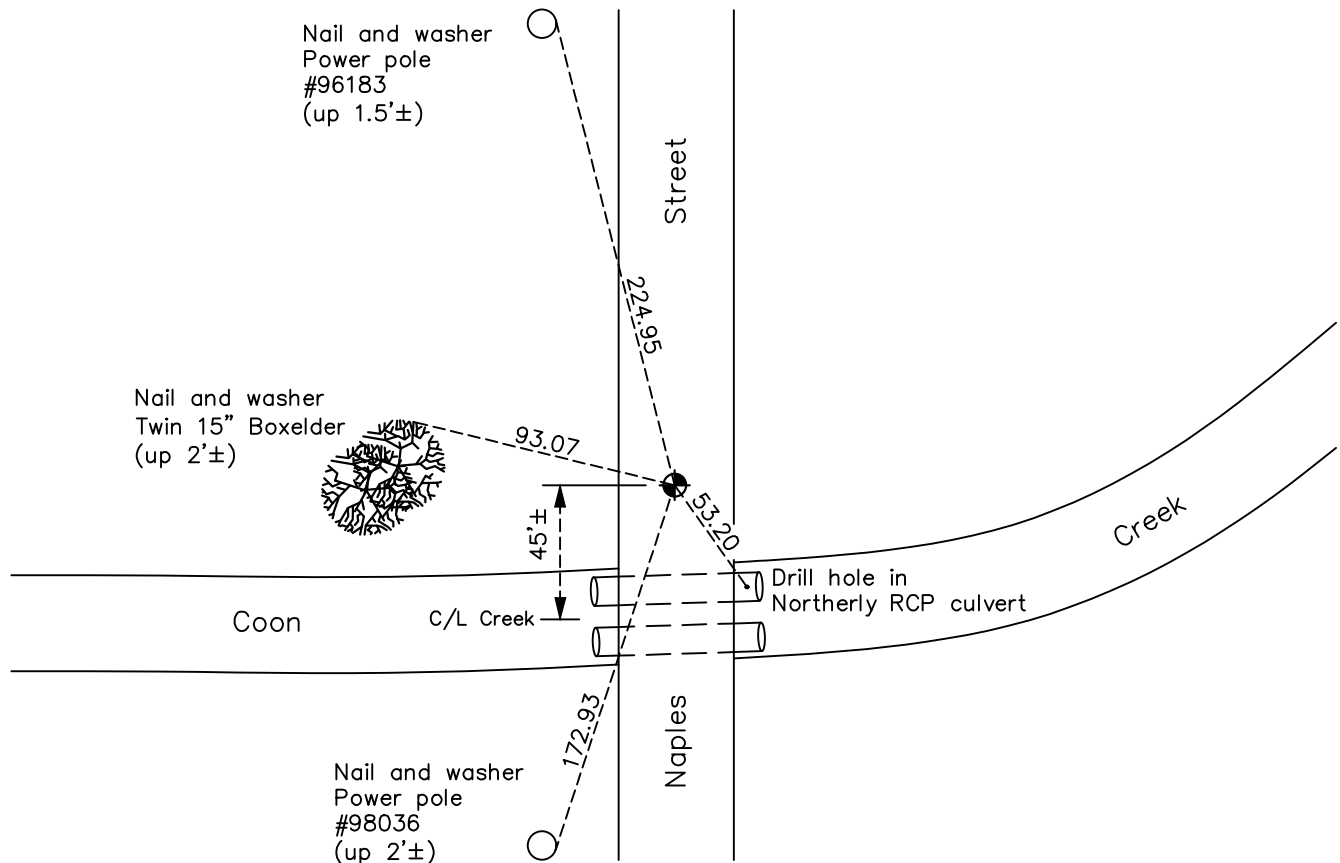

N.A.D. 1983 Coordinates
(1996 Adjustment)

County Project Coordinates	
Northing	<u>172108.6994</u>
Easting	<u>521463.9910</u>
Date	<u>11/30/01</u>

Revision Date
7/26/2021

I hereby certify that this United States public land survey monument record is correct and complete to the best of my knowledge and belief.
David Zieglmeier Date 7/21/22
 David Zieglmeier Anoka County Surveyor
 Minnesota License Number 46179

HISTORY OF GOVERNMENT CORNER

Page No. 105

County of Anoka

State of Minnesota

West 1/4 Corner of Sec. 26 Township 32 Range 23

CORNER HISTORY:

February 1855 - This corner was established by Hiram Taylor, Deputy Surveyor. Taylor marked the position by "Set quarter section post" with two bearing trees marked as accessories.

August 23, 1966 - Set cast iron monument down 0.4'± using area resurvey. Established ties to monument.

May 5, 1971 - Found cast iron monument and updated ties.

June 20, 1975 - Found cast iron monument and updated ties.

May 13, 1976 - Found cast iron monument and updated ties.

June 16, 1978 - Found cast iron monument and updated ties.

July 2, 1984 - Found cast iron monument and updated ties.

January 25, 1991 - Found cast iron monument and updated ties.

December 6, 1991 - Found cast iron monument and updated ties.

June 27, 1996 - Found cast iron monument and set construction ties prior to construction. Removed monument.

August 27, 1996 - Set cast iron monument down 0.5'± after construction. Updated ties.

May 4, 1999 - Found cast iron monument and set construction ties prior to construction. Removed monument. Set cast iron monument after road construction and updated ties.

November 30, 2001 - Established NAD 1983 (1996 adj.) Anoka County project coordinates by static GPS methods.

March 22, 2011 - Found cast iron monument and updated ties.

March 24, 2017 - Found cast iron monument paved over. Dug up road and found monument broken. Checked position by VRS GPS methods and corner ties to center fin.

June 26, 2017 - Removed broken monument and replaced with a cast iron monument flush. Updated ties.

April 6, 2021 - Found cast iron monument and updated ties.