

CERTIFICATE OF LOCATION OF GOVERNMENT CORNER

County of Anoka

State of Minnesota

East 1/4 Corner of Sec. 25 Township 32 Range 23

On the 7th day of February, 2023, the described corner was evidenced by a concrete monument

and to perpetuate the location of said corner, at the exact location thereof, a permanent marker was placed consisting of 8' Telspar with cap and punch mark set up 0.5'±

AND on the 7th day of February, 2023, said permanent marker was replaced found concrete monument up 0.2'± leaning north with a Telspar set up 0.5'± with steel post to West. Updated ties.

Updated reference ties are as shown below.

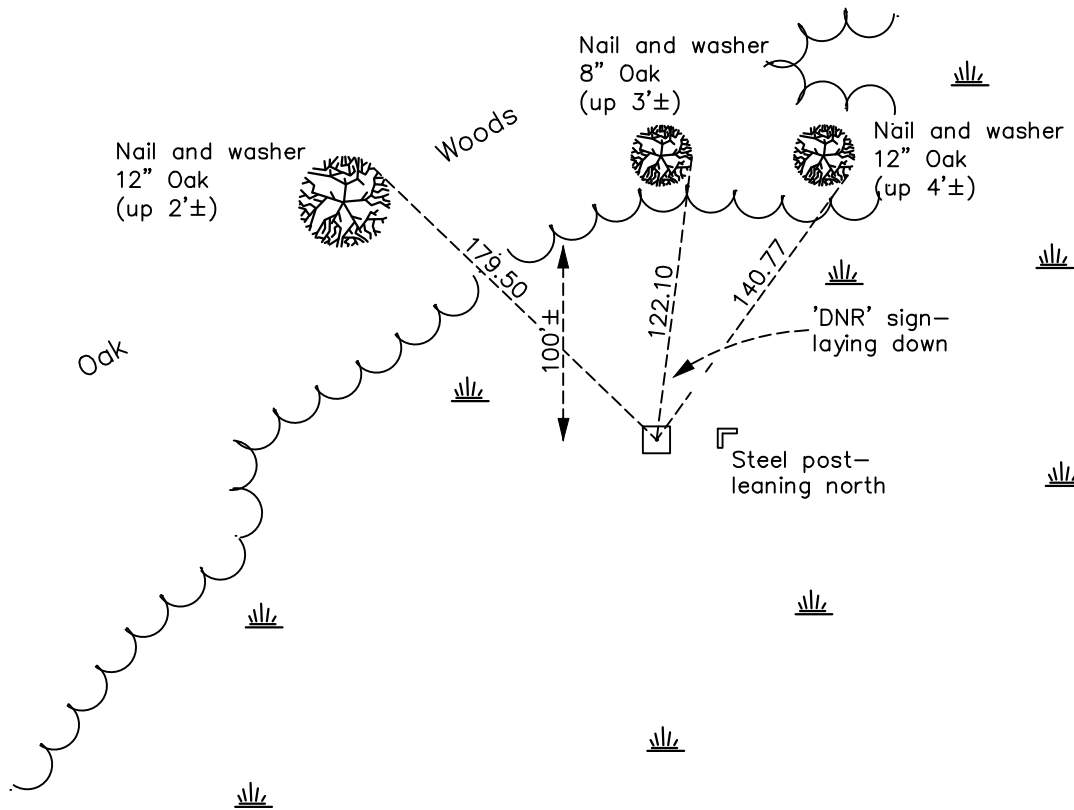

Revision Date
2/08/2023

N.A.D. 1983 Coordinates
 (1996 Adjustment)

County Project Coordinates	
Northing	<u>172023.1936</u>
Easting	<u>532001.5704</u>
Date	<u>3/05/02</u>

I hereby certify that this United States public land survey monument record is correct and complete to the best of my knowledge and belief.

David Zieglsmeier Date 2/28/23

David M. Zieglsmeier, Anoka County Surveyor
 Minnesota License Number 46179

HISTORY OF GOVERNMENT CORNER

County of Anoka

State of Minnesota

East 1/4 Corner of Sec. 25 Township 32 Range 23

CORNER HISTORY:

March 9, 2022 - Found Concrete monument up 0.2'±. Position verified by VRS GPS methods. Updated ties.

February 7, 2023 - Replaced concrete monument found up 0.2'±, leaning north and eroded with a 8' Steel Telspar with cap and punch mark set up 0.5'±. Verified position by County RTK GPS and updated ties after replacement. New Telspar position coordinates verified as accurate.