

CERTIFICATE OF LOCATION OF GOVERNMENT CORNER

County of Anoka

State of Minnesota

North 1/4 Corner of Sec. 36 Township 32 Range 23

On the 18th day of November, 1975, the described corner was evidenced by area resurvey

and to perpetuate the location of said corner, at the exact location thereof, a permanent marker was placed consisting of a cast iron monument with a sign and post on the north side

AND on the 5th day of April, 2021, said permanent marker was found down 0.2'± and the ties were updated

Updated reference ties are as shown below.

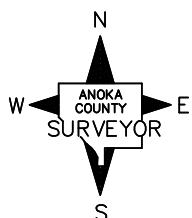
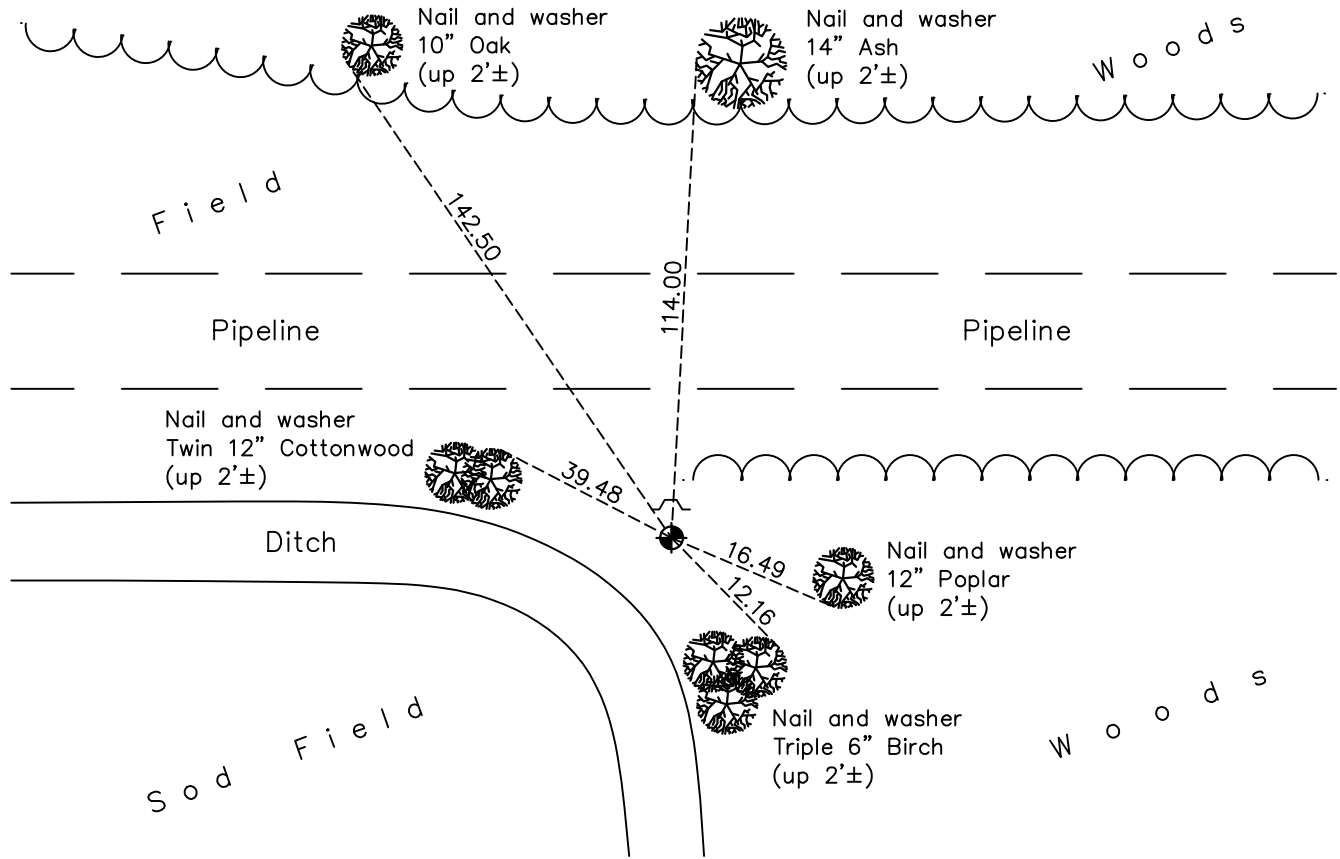

Revision Date
 7/26/2021

N.A.D. 1983 Coordinates
 (1996 Adjustment)

County Project Coordinates	
Northing	169414.1915
Easting	529337.8277
Date	2/14/02

I hereby certify that this United States public land survey monument record is correct and complete to the best of my knowledge and belief.
David Zieglmeier Date 7/21/22
 David Zieglmeier Anoka County Surveyor
 Minnesota License Number 46179

HISTORY OF GOVERNMENT CORNER

Page No. 109

County of Anoka

State of Minnesota

North 1/4 Corner of Sec. 36 Township 32 Range 23

CORNER HISTORY:

February 1855 - This corner was established by Hiram Taylor, Deputy Surveyor. Taylor marked the position by "Set quarter section post" with two bearing trees marked as accessories.

November 18, 1975 - Set cast iron monument using area resurvey. Established ties to monument. Set sign and post on the north side.

June 19, 1978 - Found cast iron monument and updated ties.

January 25, 1991 - Found cast iron monument and updated ties.

February 14, 2002 - Established NAD 1983 (1996 adj.) Anoka County project coordinates by static GPS methods.

April 14, 2011 - Found cast iron monument and updated ties.

March 24, 2017 - Found cast iron monument down 0.2'± and updated ties.

April 5, 2021 - Found cast iron monument down 0.2'± and updated ties.