

CERTIFICATE OF LOCATION OF GOVERNMENT CORNER

County of Anoka

State of Minnesota

North 1/4 Corner of Sec. 34 Township 32 Range 23

On the 7th day of August, 1969, the described corner was evidenced by area resurvey

and to perpetuate the location of said corner, at the exact location thereof, a permanent marker was placed consisting of a cast iron monument with a sign and post on the north side

AND on the 7th day of April, 2021, said permanent marker was found up 0.1'± and the ties were updated

Updated reference ties are as shown below.

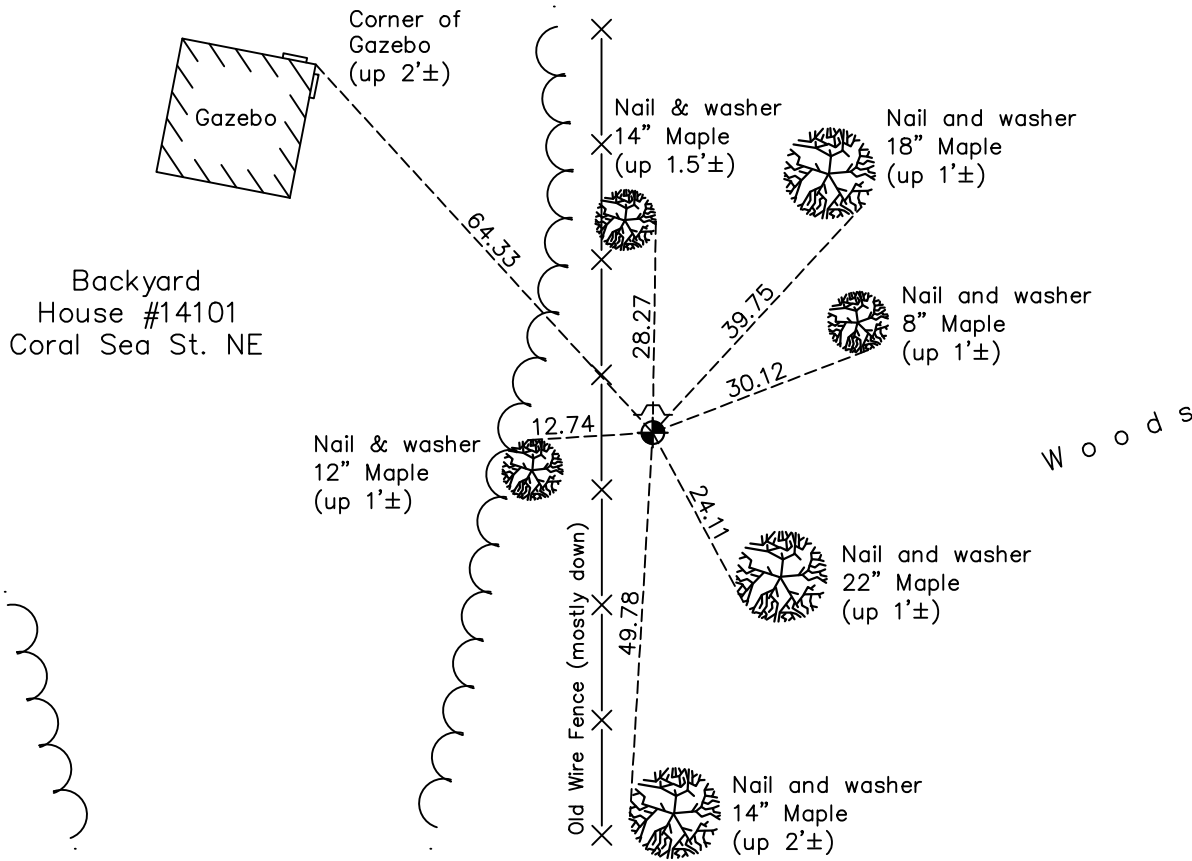

N

 W E
 S

Revision Date
7/26/2021

N.A.D. 1983 Coordinates
(1996 Adjustment)

County Project Coordinates	
Northing	<u>169499.8112</u>
Easting	<u>518830.8341</u>
Date	<u>12/12/01</u>

I hereby certify that this United States public land survey monument record is correct and complete to the best of my knowledge and belief.

David Zieglmeier Date 7/21/22

David Zieglmeier Anoka County Surveyor
 Minnesota License Number 46179

HISTORY OF GOVERNMENT CORNER

Page No. 113

County of Anoka

State of Minnesota

North 1/4 Corner of Sec. 34 Township 32 Range 23

CORNER HISTORY:

February 1855 - This corner was established by Hiram Taylor, Deputy Surveyor. Taylor marked the position by "Set quarter section post" with two bearing trees marked as accessories.

August 7, 1969 - Set cast iron monument up 0.1'± using area resurvey. Established ties to monument.

November 1972 - Found cast iron monument and updated ties. Set sign and post on north side.

June 23, 1975 - Found cast iron monument and updated ties.

June 20, 1978 - Found cast iron monument and updated ties.

July 11, 1984 - Found cast iron monument and updated ties.

November 26, 1991 - Found cast iron monument and updated ties.

December 12, 2001 - Established NAD 1983 (1996 adj.) Anoka County project coordinates by static GPS methods.

April 16, 2013 - Found cast iron monument up 0.1'± and updated ties.

February 7, 2017 - Found cast iron monument up 0.1'± and updated ties.

April 7, 2021 - Found cast iron monument up 0.1'± and updated ties.