

Harry Lake  
~~LIAWOOD~~

Page No. 123

# CERTIFICATE OF LOCATION OF GOVERNMENT CORNER

County of Anoka State of Minnesota

CENTER Corner of Sec. 32 Township 32 Range 23

I hereby certify that on the 17 day of APRIL, 1963, I found the described corner which was evidenced by BOLT IN CENTERLINE HIGHWAY  
#65

and I further certify that to perpetuate the location of said corner, I did, at the exact location thereof, place a permanent marker consisting of SAME  
UNDER BLK.TP.

which reference or witness monuments are located in the manner following:

1-13-2021 JS  
NO BEEP

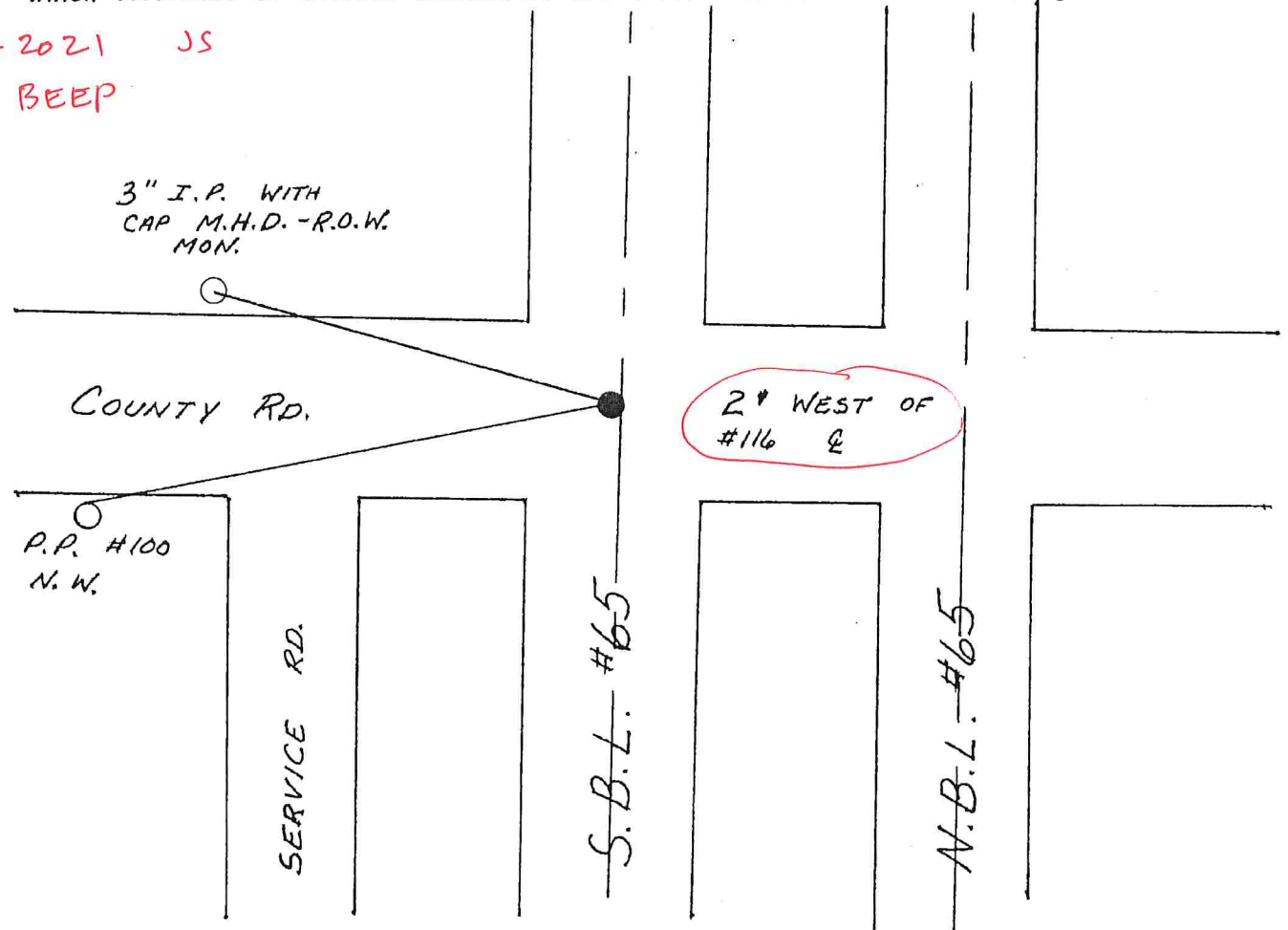

Revised date	Revised date	Revised date
10-24-90		
10-20-91		

